



14 The Close

Wye Ashford, TN25 5BD

Price £395,000

A most pleasantly appointed terraced home in the centre of Wye village, just a few minutes from the convenient local shops, schools and mainline train station.

The property spans just over 1,000sqft and comprises an entrance hall, sitting room, dining room, sun room, kitchen, three bedrooms and bathroom. The rear garden enjoys a secluded feel whilst the property also benefits from warm air heating, double glazing and garage.

NO ONWARD CHAIN.

- SPACIOUS TERRACED HOME
- THREE BEDROOMS
- SITTING & DINING ROOM
- SUN ROOM
- PLEASANTLY ENCLOSED REAR GARDEN
- GARAGE
- WARM AIR HEATING
- PEACEFUL VILLAGE SETTING
- SHORT WALK FROM MAINLINE STATION
- NO ONWARD CHAIN

Viewing

Please contact our Ashford Office on 01233 646411 if you wish to arrange a viewing appointment for this property or require further information.



Floor Plan

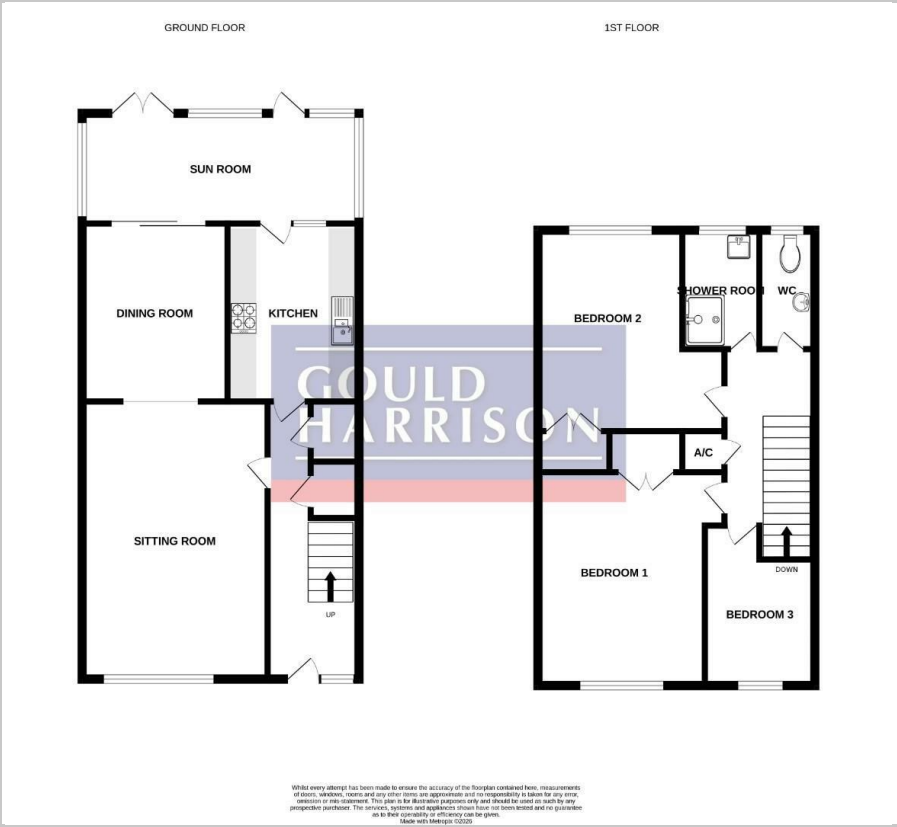

Area Map



Energy Efficiency Graph

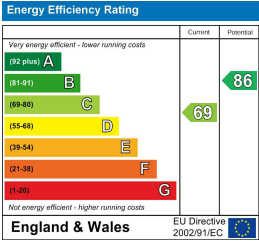

These particulars, whilst believed to be accurate are set out as a general outline only for guidance and do not constitute any part of an offer or contract. Intending purchasers should not rely on them as statements of representation of fact, but must satisfy themselves by inspection or otherwise as to their accuracy. No person in this firms employment has the authority to make or give any representation or warranty in respect of the property.