



Connells
connells.co.uk 01549 500 923
FOR SALE

Connells

Hollingworth Mews
Cannock



Ground Floor

Entrance Hallway

Having a UPVC front entrance door, radiator, ceiling light point, stairs to first floor, door to living room and door to WC

Dining Area

Being an open plan kitchen/diner and having tiled flooring, door to storage cupboard, radiator and double glazed french doors to the rear garden

W.C

Having a double glazed window to the front aspect, vinyl flooring, ceiling light point and sink

Living Room

Having laminate flooring, ceiling light point, double glazed window to the front aspect and door into kitchen

Kitchen

Being a fully fitted kitchen with a range of wall, base and drawer units with laminate worktops across, stainless steel sink with drainer, integrated oven with four ring gas hob above, extractor hood, integral fridge / freezer, space and plumbing for appliances, tiled splashbacks, ceiling light point, tiled flooring, double glazed window to the rear aspect



First Floor

Landing

Bedroom 1

Having carpeted flooring, ceiling light point, double glazed window to the front aspect and door to ensuite

En-Suite

Having a shower cubicle with glass door, double glazed window to the front aspect, ceiling light point, radiator and vinyl flooring

Bedroom 2

Having carpeted flooring, ceiling light point, radiator and double glazed window to the rear aspect

Bedroom 3

Having carpeted flooring, ceiling light point, radiator and double glazed window to the rear aspect

Family Bathroom

Having a WC, hand wash basin, bath, part tiled walls, vinyl flooring and ceiling light point

Outside

Front

Having parking spaces and a garage

Rear

Being an enclosed rear garden with side access







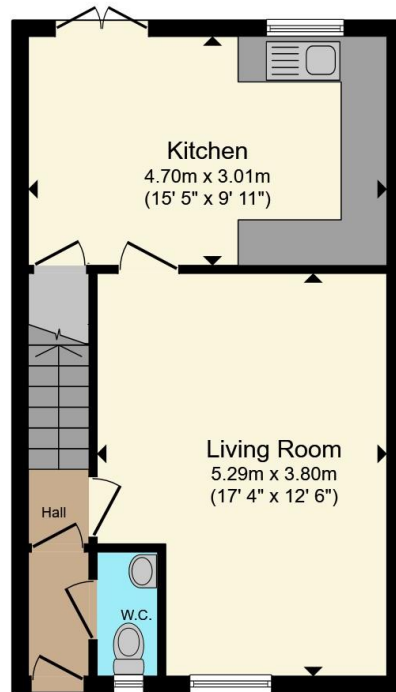

Ground Floor

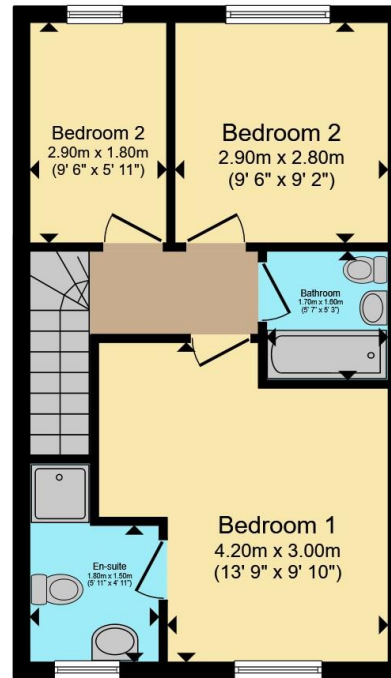

First Floor

Total floor area 79.0 m² (850 sq.ft.) approx

This floor plan is for illustrative purposes only. It is not drawn to scale. Any measurements, floor areas (including any total floor area), openings and orientation are approximate. No details are guaranteed, they cannot be relied upon for any purpose and they do not form part of any agreement. No liability is taken for any error, omission or misstatement. A party must rely upon its own inspection(s). Powered by www.propertybox.io



To view this property please contact Connells on

T 01543 500923
E cannock@connells.co.uk

10-12 Wolverhampton Road
 CANNOCK WS11 1AH

EPC Rating: C Council Tax Band: C

Tenure: Freehold

view this property online connells.co.uk/Property/CNK108818



1. MONEY LAUNDERING REGULATIONS Intending purchasers will be asked to produce identification documentation at a later stage and we would ask for your co-operation in order that there will be no delay in agreeing the sale. 2. These particulars do not constitute part or all of an offer or contract. 3. The measurements indicated are supplied for guidance only and as such must be considered incorrect. Potential buyers are advised to recheck measurements before committing to any expense. 4. We have not tested any apparatus, equipment, fixtures, fittings or services and it is in the buyers interest to check the working condition of any appliances.

Connells Residential is registered in England and Wales under company number 1489613, Registered Office is Cumbria House, 16-20 Hockliffe Street, Leighton Buzzard, Bedfordshire, LU7 1GN. VAT Registration Number is 500 2481 05.

See all our properties at www.connells.co.uk | www.rightmove.co.uk | www.zoopla.co.uk

Property Ref: CNK108818 - 0002