

Thurstan Street, SW6

£695 Per week

A beautifully finished one double bedroom apartment in Chelsea Creek. The property has an open plan kitchen living room which has direct access to the balcony. Parking Separate.

Located in the sought after Chelsea Creek development, the property is close to Chelsea and Imperial Wharf.

Features

- One Double Bedroom
- One Bathroom
- Furnished
- Concierge
- Gym And Swimming Pool
- Private Balcony

Thurstan Street, London, SW6

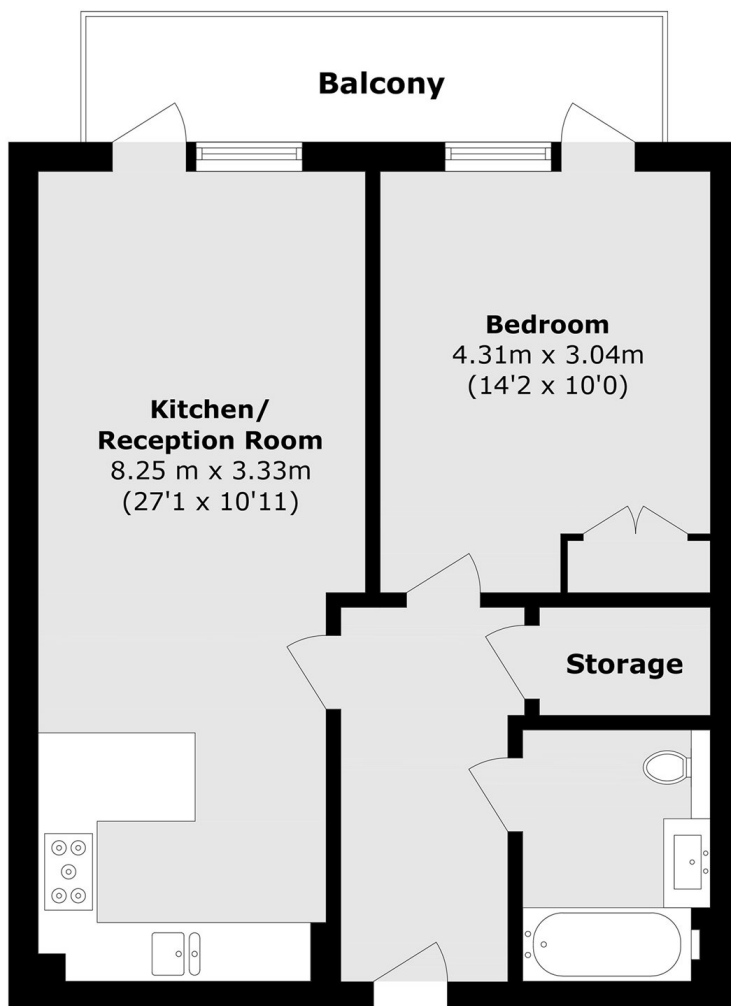

First Floor

Total area (approx.) 56.4 sq. m (607.0 sq. ft)

Balcony area (approx.): 6.4 sq. m (68.8 sq. ft)