



**2 Bed
Apartment
located in**

AiiHOMES.

Modern 2B1B Apartment | Exchange Point | 221555EP



£255,000

Welcome to this exquisite two-bedroom apartment located in the prestigious Exchange Point development, situated in the vibrant heart of Manchester city centre. Spanning an impressive 60 square feet, this modern residence is designed for those who appreciate both style and convenience.

As you enter the apartment, you are greeted by a spacious open-plan living area, enhanced by large windows that flood the space with natural light and offer stunning views of the city skyline from the sixth floor. The contemporary kitchen is fully equipped with a full-sized fridge/freezer and a dishwasher, making it perfect for culinary enthusiasts and entertaining guests alike. Offered fully furnished, this apartment radiates sophistication and comfort.

Residents of Exchange Point enjoy a wealth of amenities, including a state-of-the-art gym, meeting rooms, and communal co-working spaces, all complemented by the dedicated service of a 24-hour concierge. A café is also set to open soon, further enhancing the community feel of this remarkable development.

The location is truly unbeatable, with an array of shops, bars, and restaurants just a stone's throw away. For those who require excellent transport links, Victoria Station is conveniently located within a five-minute walk, providing easy access to the wider city and beyond.

This property is available for rent at £1,225 per calendar month until





Modern 2B1B Apartment | Exchange Point | 221555EP

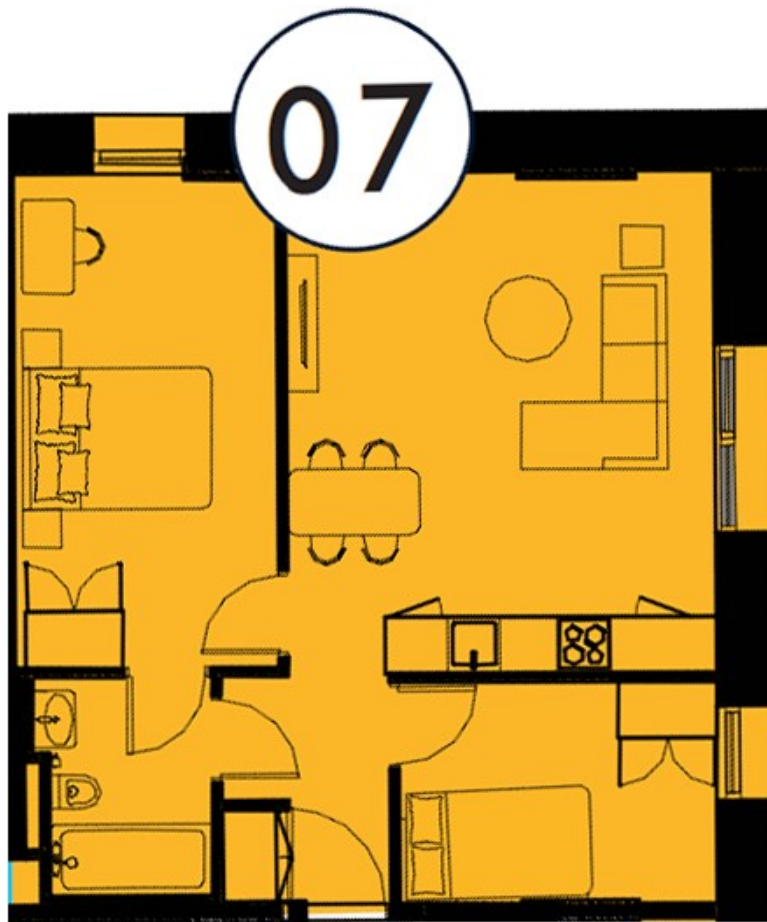

Energy Efficiency Rating		
	Current	Potential
<i>Very energy efficient - lower running costs</i>		
(92 plus) A		
(81-91) B		
(69-80) C		
(55-68) D		
(39-54) E		
(21-38) F		
(1-20) G		
<i>Not energy efficient - higher running costs</i>		
England & Wales	EU Directive 2002/91/EC	

EPC Rating:
Council Tax Band: D

CONTACT

5th floor, Empress Business Center
380 Chester Road
Manchester
M16 9EA

E: info@aihomes.uk

T: 0127 332 8069

AiHOMES.