

for sale

offers in excess of **£350,000**



Prunus Walk Swindon SN1 7ET

If you're looking for a spacious starter home or enough space for a small family then look no further! Offering a generous kitchen / diner for entertaining and a cosy lounge for relaxing, this beautiful home also offers driveway parking.

Viewing is highly recommended to avoid disappointment!



Prunus Walk Swindon SN1 7ET

Ground Floor Accommodation

Entrance Hall

Access to Cloakroom and Lounge through to Rear Lobby

Cloakroom

WC and Wash Hand Basin

Lounge

Large Double Glazed Window to Front, Door Rear Lobby, Under Stairs Cupboard

Rear Lobby

Access to Kitchen / Dining Room, Stairs up to First Floor

Kitchen / Dining Room

Double Glazed Window and French Doors to Rear Garden, Modern Range of Wall and Base Units with Work Surface Over, Inset Stainless Steel Sink with Mixer Taps, Built In Oven with Gas Hob and Extractor Hood Over, Integrated Washing Machine, Dishwasher and Fridge / Freezer.



First Floor Accommodation

Bedroom 1

Double Glazed Window to Front, Radiator, Built in Wardrobe, Door to En-Suite

En-Suite

Three Piece Suite Comprising of WC, Wash Hand Basin and Shower Enclosure, Tiled to Water Sensitive Areas

Bedroom 2

Double Glazed Window to Rear, Radiator

Bedroom 3

Double Glazed Window to Rear, Radiator

Bathroom

Obscure Double Glazed Window to Front, Three Piece Suite Comprising of WC, Wash Hand Basin and Panel Bath with Shower and Screen Over, Heated Towel Rail

External Features

Rear Garden

Enclosed by Fence Panels, Low Maintenance Garden Mostly Laid to Lawn, Side Gate Access

Parking

Driveway Parking for 2 Cars, Directly to the Front of the Property



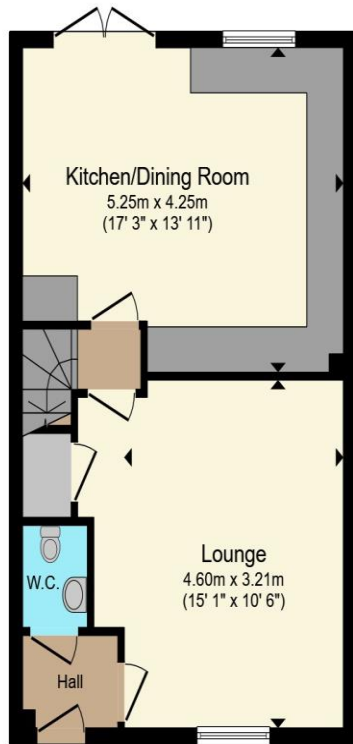

Ground Floor

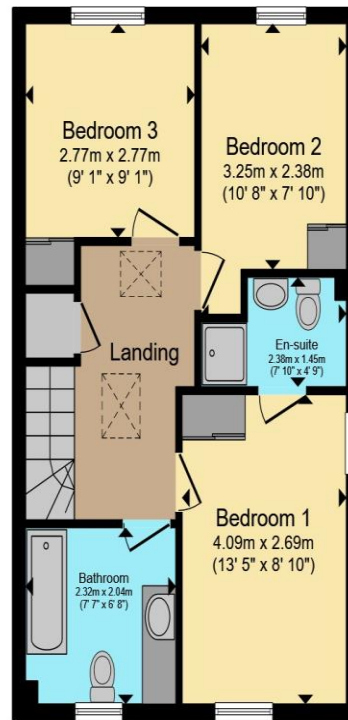

First Floor

Total floor area 94.4 m² (1,016 sq.ft.) approx

This floor plan is for illustrative purposes only. It is not drawn to scale. Any measurements, floor areas (including any total floor area), openings and orientation are approximate. No details are guaranteed, they cannot be relied upon for any purpose and they do not form part of any agreement. No liability is taken for any error, omission or misstatement. A party must rely upon its own inspection(s). Powered by www.propertybox.io



To view this property please contact Connells on

T 01793 461757
E swindonoldtown@connells.co.uk

3-5 Victoria House, Albert St
 SWINDON SN1 3BG

Property Ref: SND103071 - 0011

Tenure:Freehold EPC Rating: B

Council Tax Band: D

view this property online connells.co.uk/Property/SND103071



1. MONEY LAUNDERING REGULATIONS Intending purchasers will be asked to produce identification documentation at a later stage and we would ask for your co-operation in order that there will be no delay in agreeing the sale. 2. These particulars do not constitute part or all of an offer or contract. 3. The measurements indicated are supplied for guidance only and as such must be considered incorrect. Potential buyers are advised to recheck measurements before committing to any expense. 4. We have not tested any apparatus, equipment, fixtures, fittings or services and it is in the buyers interest to check the working condition of any appliances.

Connells Residential is registered in England and Wales under company number 1489613, Registered Office is Cumbria House, 16-20 Hockliffe Street, Leighton Buzzard, Bedfordshire, LU7 1GN. VAT Registration Number is 500 2481 05.

see all our properties at <http://www.connells.co.uk> | www.rightmove.co.uk | www.zoopla.co.uk