



House - Townhouse (EPC Rating: D)

# MICHAELS MEAD, CIRENCESTER, CIRENCESTER, GLOS, GL7 1WE

Auction Guide

# £260,000

CANNON ESTATES  
SALES & LETTINGS



# 2 Bedroom House - Townhouse located in Cirencester

Cannon Estates are pleased to present this two bedroom property situated in a quiet cul de sac with parking and garage in the sought after area of Chesterton. This home comprises of a spacious lounge, kitchen open to dining room which in turn leads out into a pretty, private garden. Upstairs you will find two double bedrooms and family size bathroom. The property comes with the added bonus of a garage, gas central heating and double glazing. E.P.C. Rating D. Available April 2026.

Cannon Estates are pleased to present this two bedroom property situated in a quiet cul de sac with parking and garage in the sought after area of Chesterton. This home comprises of spacious lounge, open plan kitchen/dining room which in turn leads out into a pretty, private garden. Upstairs are two double bedrooms and family size bathroom. The property comes with the added bonus of a garage, gas central heating and double glazing.

This property is situated in Chesterton which is easy commute to Cirencester town centre and all local amenities. This property would be ideal for a family, couple or professional sharers. E.P.C. Rating D

Pattinson Auction are working in Partnership with the marketing agent on this online auction sale and are referred to below as 'The Auctioneer'.

This auction lot is being sold either under conditional (Modern) or unconditional (Traditional) auction terms and overseen by the auctioneer in partnership with the marketing agent. The property is available to be viewed strictly by appointment only via the Marketing Agent or The Auctioneer. Bids can be made via the Marketing Agents or via The Auctioneers website.

Please be aware that any enquiry, bid or viewing of the subject property will require your details being shared between both any marketing agent and The Auctioneer in order that all matters can be dealt with effectively.

The property is being sold via a transparent online auction.

In order to submit a bid upon any property being marketed

by The Auctioneer, all bidders/buyers will be required to adhere to a verification of identity process in accordance with Anti Money Laundering procedures. Bids can be submitted at any time and from anywhere.

Our verification process is in place to ensure that AML procedure are carried out in accordance with the law.

The advertised price is commonly referred to as a 'Starting Bid' or 'Guide Price' and is accompanied by a 'Reserve Price'. The 'Reserve Price' is confidential to the seller and the auctioneer and will typically be within a range above or below 10% of the 'Guide Price' / 'Starting Bid'.

These prices are subject to change.



CIRENCESTER LETTINGS | 6 THE WOOL MARKET, CIRENCESTER, GLOUCESTERSHIRE, GL7 2PR



GROUND FLOOR PLAN  
SCALE 1:50

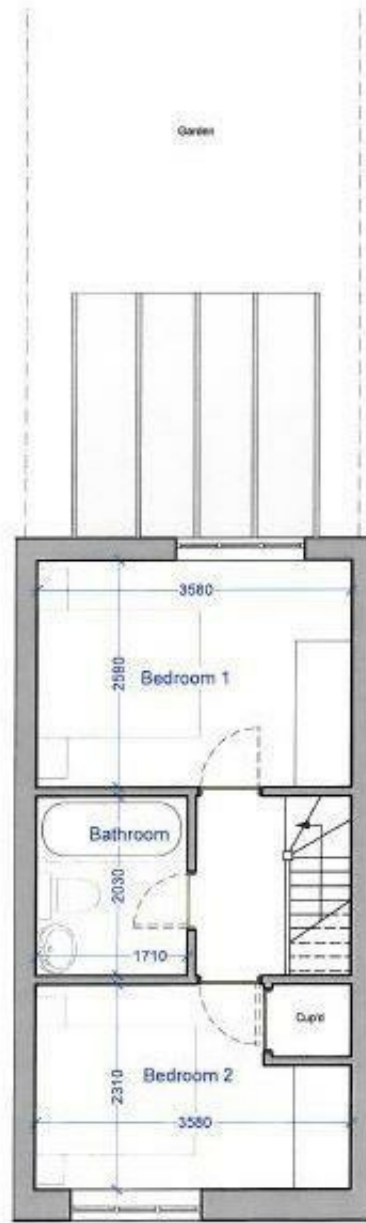

FIRST FLOOR PLAN  
SCALE 1:50

Council Tax Band

**C**

Energy Performance Graph

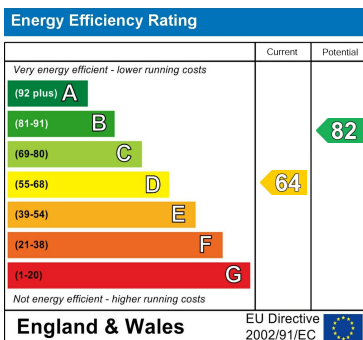

Call us on

**01285 706900**

[info@cannon-estates.co.uk](mailto:info@cannon-estates.co.uk)

<https://www.cannon-estates.co.uk/>

Agents Note: Whilst every care has been taken to prepare these particulars, they are for guidance purposes only. All measurements are approximate and are for general guidance purposes only and whilst every care has been taken to ensure their accuracy, they should not be relied upon and potential buyers are advised to recheck the measurements.

**CANNON ESTATES**  
SALES & LETTINGS