



27 Belton Lane, Grantham
Grantham

£300,000

DavidGrace





27 Belton Lane

Grantham, Grantham

Beautifully presented 3-bed semi-detached home in central location with spacious living, conservatory, large garden to river, outbuilding, garage, and driveway for two cars.

Council Tax band: C

Tenure: Freehold

EPC Energy Efficiency Rating: D

EPC Environmental Impact Rating: E

- Three Bedroom Semi-Detached Home on Belton Lane
- Spacious Lounge with Bay Window
- Cosy Snug with Feature Wood Burner
- Stylish Kitchen/Diner and Versatile Conservatory Overlooking Garden
- Two Double Bedrooms and One Good Single
- Separate Utility Space Within Large Garage
- Large Garden Backing Onto the River
- Substantial Outbuilding Ideal for Home Office/Gym
- Driveway Parking and Garage For at Least 2 Cars
- EPC - tbc



Entrance Hall

Lounge

14' 1" x 11' 10" (4.30m x 3.60m)

Snug

12' 2" x 11' 10" (3.70m x 3.60m)

Kitchen

Conservatory

Landing

Bedroom 1

12' 10" x 11' 10" (3.90m x 3.60m)

Bedroom 2

12' 2" x 11' 10" (3.70m x 3.60m)

Bedroom 3

8' 2" x 6' 11" (2.50m x 2.10m)

Bathroom

Garage

17' 5" x 8' 10" (5.30m x 2.70m)

Utility Room

Study/Games Room





GARDEN

GARAGE

DRIVEWAY







DavidGrace

A NEWTON FAMILY ESTATE AGENCY

Belton Lane, Grantham

House: 1074sq ft/ 99.45m²

Garage: 211.21sq ft/ 19.55m²

Study/Games Room: 276.9sq ft/ 25.6m²

Total Area: 1556.46sq ft/ 144.6m²

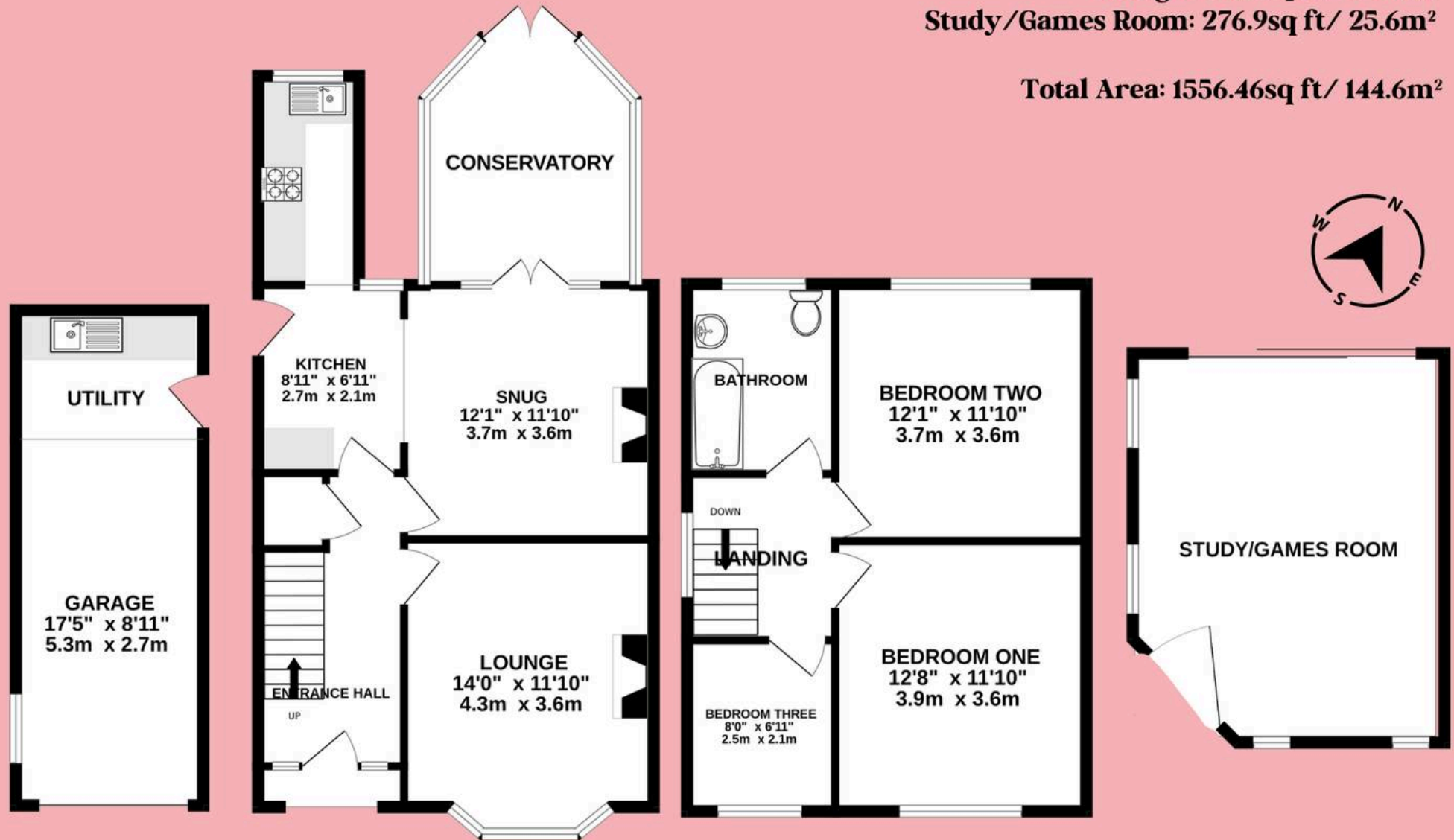



David Grace Estate Agents

71 High Street, Grantham - NG31 6NR

01476 833833 • sell@davidgrace.co.uk • www.davidgrace.co.uk

DavidGrace