



4 The Willows Maurys Lane

West Wellow, Romsey, SO51 6DA

£2,875 Per month



Signature Properties are delighted to offer this stunning four-bedroom detached home, located on the secluded Maurys Lane in the rural village of West Wellow, close to the New Forest and with easy access to the M27.

Finished to a high specification throughout, the property comprises a modern kitchen/diner with integrated appliances and bi-folding doors opening onto the enclosed rear garden. The ground floor also benefits from a spacious lounge, two additional reception rooms, utility room, and downstairs W.C. Upstairs offers four double bedrooms, including a master bedroom with shower en-suite, and a family bathroom with separate shower cubicle.

Additional features include underfloor heating, double glazing, a garage, and driveway parking for up to three vehicles. Situated within an exclusive development of just five homes.

Floor plan measurements may not be accurate. Viewings are highly recommended.



Area Map



Floor Plans

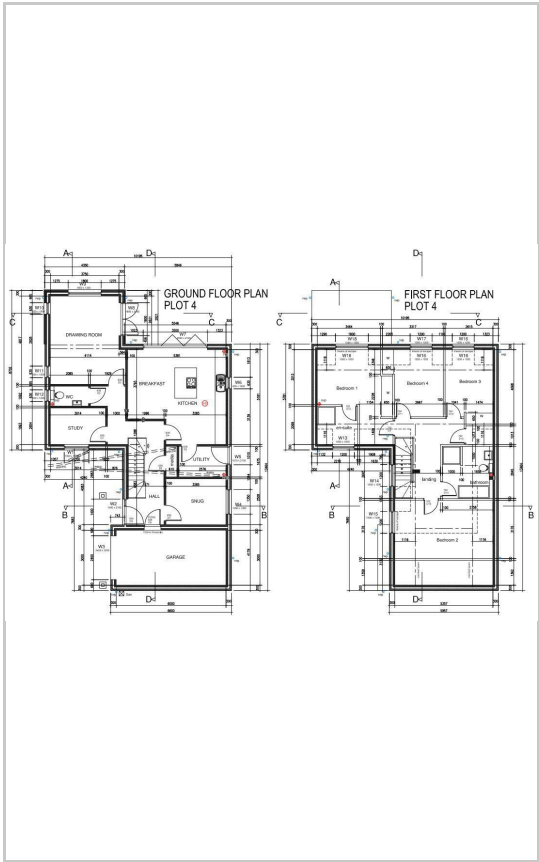

Energy Efficiency Graph

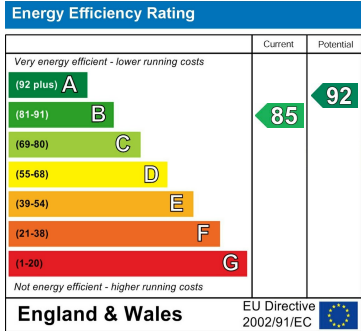

These particulars, whilst believed to be accurate are set out as a general outline only for guidance and do not constitute any part of an offer or contract. Intending purchasers should not rely on them as statements of representation of fact, but must satisfy themselves by inspection or otherwise as to their accuracy. No person in this firms employment has the authority to make or give any representation or warranty in respect of the property.