



Centric Close

London, NW1

£3,683.33 per month
(£850.00 per week)

A beautifully presented two-bedroom, two-bathroom apartment situated on the top floor of an impressive modern development, ideally located moments from Primrose Hill and Camden Town.

CHESTERTONS



Centric Close

London, NW1

- * Top floor two-bedroom, two-bathroom apartment
- * Finished to an exceptional specification throughout
- * Principal bedroom with en-suite plus Jack and Jill bathroom
- * Air conditioning, excellent storage and double-height windows
- * Landscaped communal roof terrace with panoramic London views
- * Moments from Primrose Hill, Regent's Park and Camden Town



A beautifully presented two-bedroom, two-bathroom apartment situated on the top floor of an impressive modern development, ideally located moments from Primrose Hill and Camden Town.

Finished to an exceptional specification throughout, the property offers a spacious entrance leading to two generous double bedrooms, including a principal bedroom with en-suite bathroom and a second bedroom served by a stylish Jack and Jill bathroom. The bright open-plan kitchen and reception room features sleek integrated appliances and ample space for dining and entertaining, while striking double-height windows flood the apartment with natural light. Further benefits include air conditioning, excellent

Minimum Term: 6 months
Deposit Required: £4,250.00
Local Authority: Camden
Council Tax Band: F
EPC Rating: B
Furnished, Part Furnished

Score	Energy rating	Current	Potential
92+	A		
81-91	B	87 B	87 B
69-80	C		
55-68	D		
39-54	E		
21-38	F		
1-20	G		

Chestertons Property Services

The Lantern
 75 Hampstead Road
 London
 NW1 2PL
 valuations@chestertons.co.uk
 020 3040 8440
 chestertons.co.uk

Additional tenant charges apply (fees apply to non-AST tenancies only)
 Tenancy Agreement Fee: £300
 References per Tenant/Guarantor: £60
 Inventory check (approx. £100 – £250 inc. VAT)
[chestertons.co.uk/property-to-rent/applicable-fees](https://www.chestertons.co.uk/property-to-rent/applicable-fees)

APPROXIMATE FLOOR AREA = 899 SQ FT / 83.5 SQ M
INCLUDING LIMITED USE AREA (10 SQ FT / 0.9 SQ M)

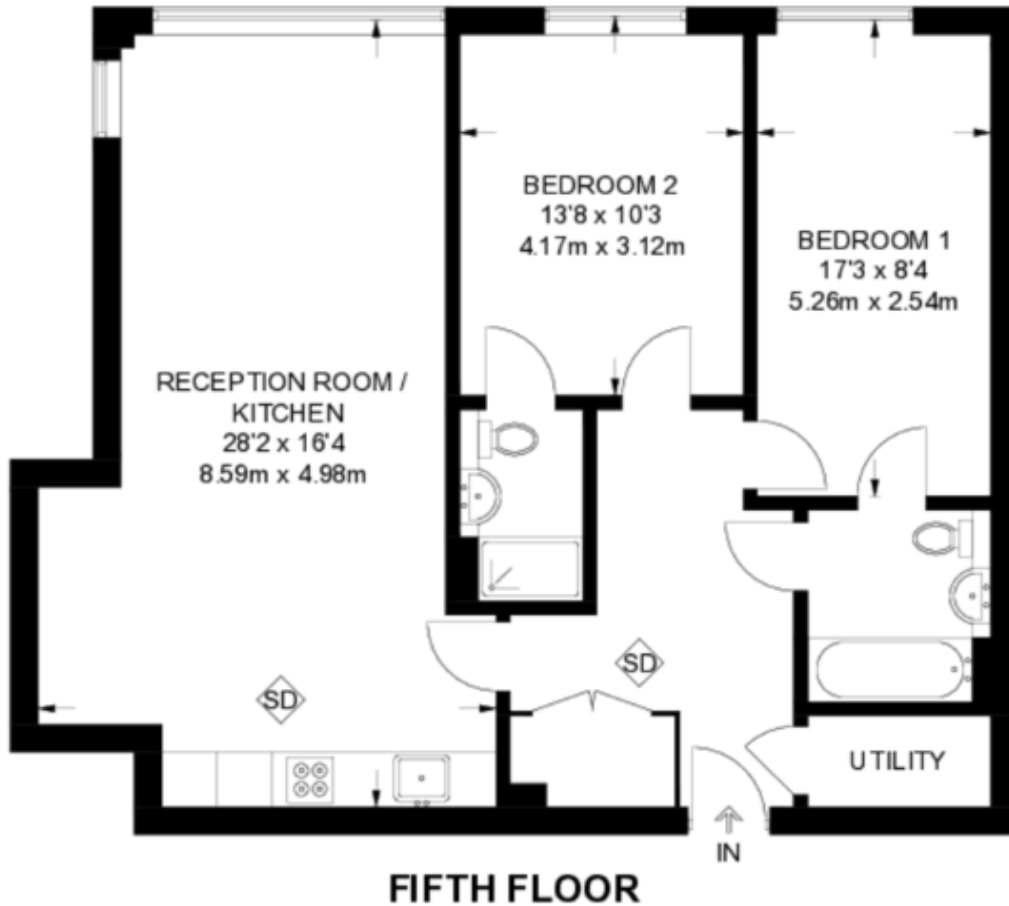

Chesterton UK Services Limited trading as Chestertons for themselves and for the vendor of this property whose agents they are, give notice that (i) these particulars do not constitute any part of an offer or contract, (ii) all statements contained within these particulars are made without responsibility on the part of Chestertons or the vendor, (iii) whilst made in good faith, none of the statements contained within these particulars are to be relied upon as a statement or representation of fact, (iv) any intending purchasers must satisfy themselves by inspection or otherwise as to the correctness of each of the statements contained within these particulars, (v) the vendor does not make or give either Chestertons or any person in their employment any authority to make or give representation or warranty whatsoever in relation to this property. Wide angle lenses may be used. ©Copyright Chestertons | Chesterton Global Ltd | Registered Office 5th Floor, The Lantern, 75 Hampstead Road, London, NW1 2PL Registered Company Number 05334580.



This paper is
100% recyclable