



Park Avenue,
Whitchurch, Cardiff,
CF14 7AL



PCM
£1,400 PCM

3 Bedrooms
Bungalow - Semi Detached

An extended three bedroom semi detached dorma style bungalow occupying a corner position on this quiet cul-de-sac just over the road from Coryton train station. Upgraded to reflect modern kitchen, carpets and decoration, accommodation includes open plan kitchen living area and en-suite shower room to dorma bedroom. Large driveway forecourt to front offering off road parking. Low maintenance south facing rear garden. Within 1km of Whitchurch village and M4 at J32. Unfurnished with appliances. Gas central heating. Council Tax band E. EPC rating E. Available May 2026 for minimum twelve month term.

Features

- Extended Semi Detached Dorma Bungalow
- Three Bedrooms inc En Suite Shower Room to First Floor
- Newly Decorated Throughout
- South Facing Rear Garden
- Large Driveway - Off Road Parking
- Unfurnished with Kitchen Appliances/Gas Central Heating
- Council Tax Band E/EPC Rating E
- Train Station within 200m/Within 1km of Whitchurch Village and M4
- Available May 2026/Minimum Twelve Month Term



Information

- Tenure:
- Council Tax Band: E
- Floor Area: 971.00 sq ft
- Current EPC Rating: D
- Potential EPC Rating: C



3 BEDROOMS



2 BATHROOMS



1 RECEPTION ROOMS



ENERGY RATING: D

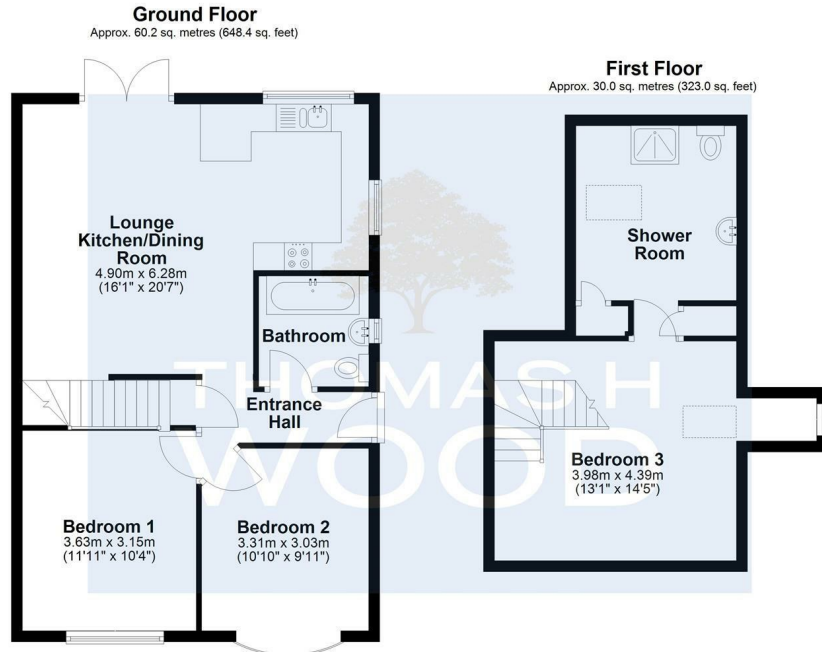

Total area: approx. 90.2 sq. metres (971.3 sq. feet)



Agents Note: Whilst every care has been taken to prepare these sales particulars, they are for guidance purposes only. All measurements are approximate and for general guidance purposes only and whilst every care has been taken to ensure their accuracy, they should not be relied upon and potential buyers are advised to recheck the measurements

Energy Efficiency Rating		Current	Potential
Vary energy efficient - lower running costs			
(92 plus)	A		
(81-91)	B		
(69-80)	C		
(55-68)	D	64	73
(39-54)	E		
(21-38)	F		
(1-20)	G		
Not energy efficient - higher running costs			
England & Wales		EU Directive 2002/91/EC	

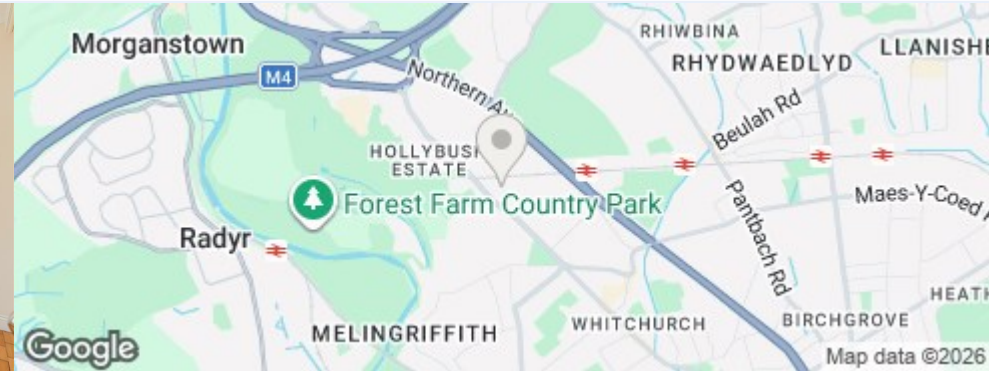

CONTACT

sales@thomashwood.com
02920 626 252
thomashwood.com

WHITCHURCH BRANCH

14 Park Road,
Whitchurch
CF14 7BQ

RADYR BRANCH

5 Station Road,
Radyr, Cardiff
CF15 8AA