



Price
£375,000

**Share of
Freehold**

2x  1x  1x 

**Shelton Villas, Burgess
Road, Sutton, Surrey,
SM1**

OVER 60?

Secure this property
for up to **59% less!**

cubitt & west
Helping you move forwards



Main features

- Beautifully presented maisonette
- Period property with high ceilings and character features
- Direct access to private rear garden
- Walking distance to station
- Good choice of both Primary and Secondary Schools nearby

Accommodation

GROUND FLOOR

Entrance Hall

Lounge: 16'7 x 11'1 (5.06m x 3.38m)

Kitchen: 11'8 x 11'4 (3.56m x 3.46m)

Bedroom 1: 13'0 x 12'8 (3.97m x 3.86m)

Bedroom 2: 11'8 x 9'5 (3.56m x 2.87m)

Bathroom: 8'2 x 5'6 (2.49m x 1.68m)

OUTSIDE

Rear Garden

Ground Floor
Approx. 61.6 sq. metres (662.6 sq. feet)

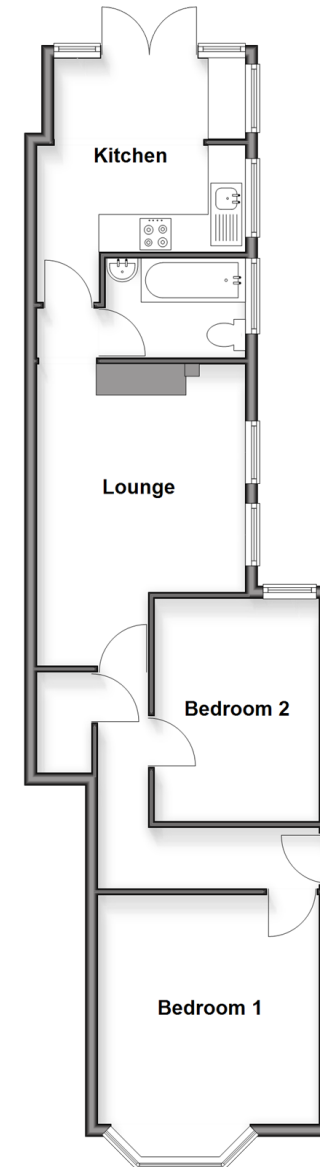

Call Sutton - 020 8661 0330 ■ cubittandwest.co.uk

- Legal advice should be taken to verify fixtures/fittings, planning, alterations and/or lease details
- Appliances & services are untested, dimensions are approximate and floor plans are not to scale
- Through a Homewise Home For Life Plan people aged 60+ can secure this property for up to 59% less, by purchasing a Lifetime Lease.



22018172/20250704/CR/JB