



## Shad Thames, SE1

£2,650 Per week

An incredible one double bedroom apartment overlooking the river in the heart of Shad Thames. Ideal for a tenant looking for a central location with easy access to the Financial City, Canary Wharf and the West End.

Anchor Brewhouse overlooks Tower Bridge and is one of the most sought after residential developments in SE1. There is easy access to both Tower Hill and London Bridge Stations.

### Features

- One Double Bedroom
- Wood Flooring
- Stunning Views
- Concierge
- Third Floor
- Unfurnished

Shad Thames,  
London, SE1

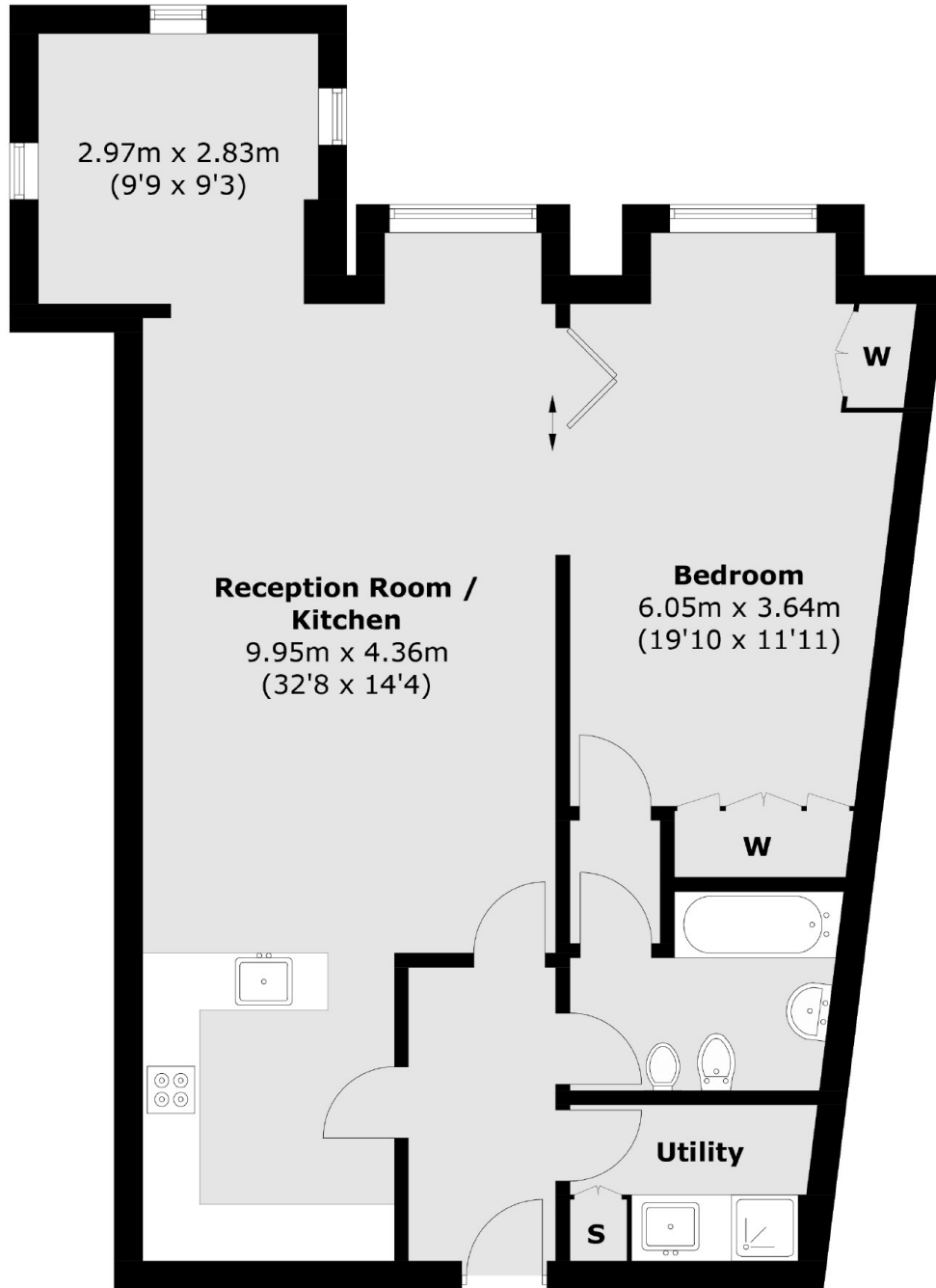

**Third Floor**

Total area (approx.): 87.3 sq. m (939.6 sq. ft)