



King Edward VII Apartments, Kings Drive, Midhurst, West Sussex

Guide Price £450,000

2 2

A beautifully spacious 1,035 sq ft 2 bedroom, 2 bathroom apartment set within the prestigious Grade II Listed King Edward VII Estate in the South Downs National Park. This stunning second-floor home offers lift access, a sleek quartz kitchen with Siemens appliances, engineered wood flooring and luxurious bathrooms including a travertine en-suite with twin basins. Striking leadlight mullion windows flood the apartment with natural light and enjoy gorgeous views towards the woodland and Kings Green. Two generous double bedrooms, excellent storage and 2 allocated spaces in the secure underground car park. Residents benefit from beautiful Gertrude Jekyll gardens, woodland walks, FTTP broadband and two elegant communal lounges. Just 13 mins from Haslemere station with direct trains to London. A rare blend of period charm, contemporary finish and EPC B efficiency. Perfectly positioned just moments from Midhurst and only an hour from London.

Quote AM0249 07506 730460

- Superb 'B' Rating EPC Energy Efficiency
- No forward chain & move in ready
- Residents heated indoor pool, steam room & gym
- Secure Allocated Underground Carpark for 2 Vehicles
- Edwardian Features
- Pretty Woodland Views

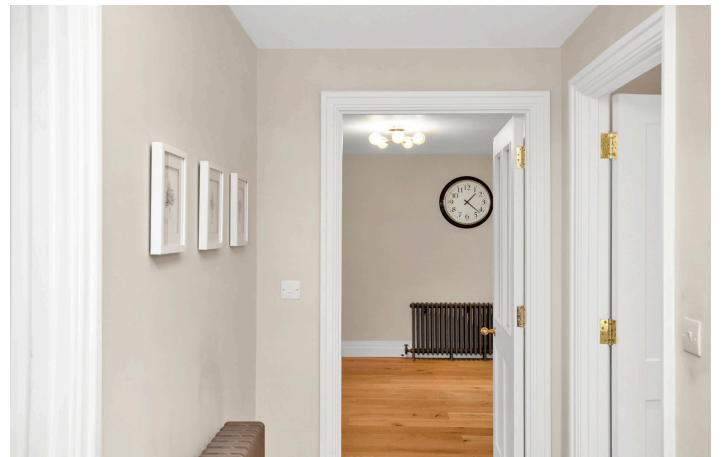

Floor Area: 1072 sq. ft.

Tenure: Leasehold

Service Charge: £5866 per annum

Ground Rent: £250 per annum

Score	Energy rating	Current	Potential
92+	A		
81-91	B	81 B	84 B
69-80	C		
55-68	D		
39-54	E		
21-38	F		
1-20	G		

The graph shows this property's current and potential energy rating.

Properties get a rating from A (best) to G (worst) and a score. The better the rating and score, the lower your energy bills are likely to be.

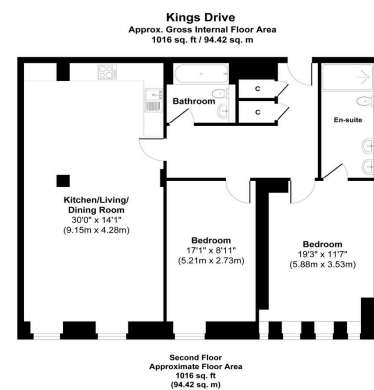

Whilst every attempt has been made to ensure the accuracy of the floor plan shown, all measurements, positioning, fixtures, fittings and any other data shown are an approximate interpretation for illustrative purposes only, and are not to scale. No responsibility is taken for any errors, omission, mis-statement or use of data shown. Produced by Home Focus Studio Ltd.