



CHATSWORTH ROAD, NW2

£320,000

This superb, one-bedroom apartment is situated on the first floor of a gated, purpose built development comprising a spacious open plan kitchen/living room, double bedroom, three-piece bathroom and ample

One Bedroom
First Floor Apartment
Purpose Built Development

Residents Parking
Great Transport Links
Popular Location

STEP INSIDE CHATSWORTH ROAD

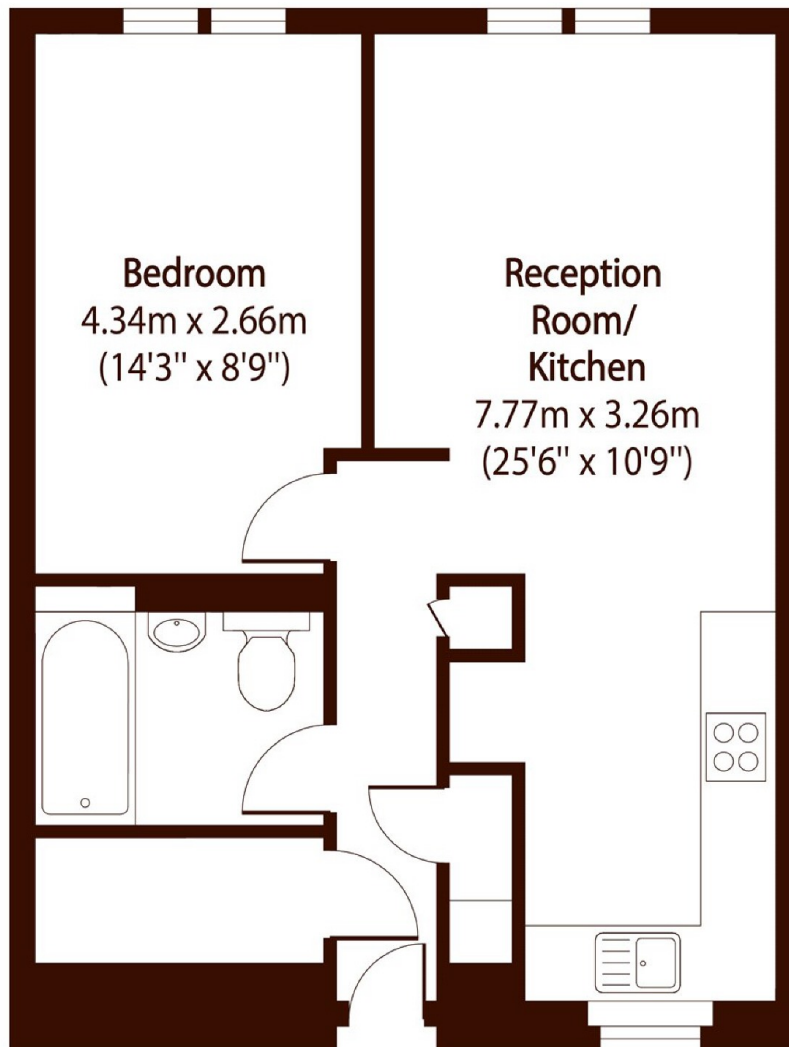

Total area (approx): 44.71 sq m (481 sq. ft)

Willesden Green
020 8451 0420

Energy Rating: B We aim to make our particulars both accurate and reliable. However, they are not guaranteed; nor do they form part of an offer or contract. If you require clarification on any points then please contact us, especially if you're traveling some distance to view. Please note that appliances and heating systems have not been tested and therefore no warranties can be given as to their good working order

MARSH &
PARSONS