



 paulwallace

The Canadas, Turnford, EN10 6DP |
£210,000 | Leasehold

The Canadas, Turnford, EN10 6DP

****CHAIN-FREE**** This well-presented, ONE BEDROOM GROUND-FLOOR maisonette is situated a short drive from both CHESHUNT STATION and BROOKFIELD SHOPPING CENTRE. Benefitting from a KITCHEN, SPACIOUS LOUNGE, SHOWER ROOM, OWN GARDEN with storage cupboard, allocated parking space and with a LONG LEASE. Gas central heating and double-glazed windows throughout.

Key features

- Chain-Free
- Ground-Floor
- Shower Room
- Allocated Parking
- One Bedroom
- Well Presented
- Own Garden
- Close to Local Amenities

Property Information

Tenure

Leasehold

Council Tax

C

EPC Rating

C

Local Authority

Broxbourne Borough Council

Lease Length

144 Years

Annual Service Charge & Ground Rent

SC – £103.47

GR - NIL



 paulwallace



 paulwallace



Paul Wallace Estate Agents
Brookfield Centre
Cheshunt
Hertfordshire
EN8 0NN



01992 781100



cheshunt@paulwallace.co.uk



www.paulwallace.co.uk



Opening Times

Mon - Fri	9 am to 6:30 pm
Sat	9 am to 5:30 pm
Sun	Closed
Bank Hols	Closed

 paulwallace
estate agents

Cheshunts leading estate agent.
Please get in touch for your free
property valuation.







Registered Address: Unit 3 The Brookfield Centre, Cheshunt, Herts, EN8 0NN Company Registration Number: OC414280 | VAT Number: 276958046 © 2022 Paul Wallace Group LLP trading as Paul Wallace Estate Agents



Paul Wallace Estate Agents
Brookfield Centre
Cheshunt
Hertfordshire
EN8 0NN



01992 781100



cheshunt@paulwallace.co.uk



www.paulwallace.co.uk



Opening Times

Mon - Fri	9 am to 6:30 pm
Sat	9 am to 5:30 pm
Sun	Closed
Bank Hols	Closed



Agents note: Whilst every care has been taken to prepare these sales particulars, they are for guidance purposes only. All measurements are approximate and are for general guidance purposes only and whilst every care has been taken to ensure their accuracy, they should not be relied upon. Potential buyers are advised to recheck measurements.

GROUND FLOOR
452 sq.ft. (42.0 sq.m.) approx.

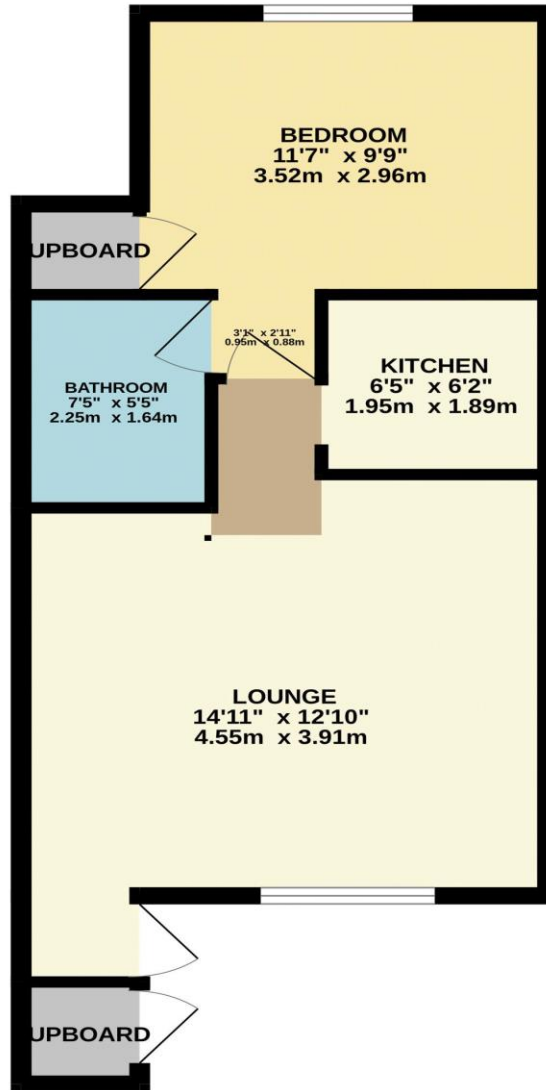

TOTAL FLOOR AREA : 452 sq.ft. (42.0 sq.m.) approx.

Whilst every attempt has been made to ensure the accuracy of the floorplan contained here, measurements of doors, windows, rooms and any other items are approximate and no responsibility is taken for any error, omission or mis-statement. This plan is for illustrative purposes only and should be used as such by any prospective purchaser. The services, systems and appliances shown have not been tested and no guarantee as to their operability or efficiency can be given.
Made with Metropix ©2026