



SANDYCOMBE ROAD, TW9

£365,000

A spacious one bedroom flat in this Victorian conversion on the first floor close to Kew Gardens. The flat is approx 625sq/ft making it a larger one bedroom flat with lots of living space and storage.

One bedroom
First floor flat
Central village location

Well presented
Great transport links
Energy rating: c

STEP INSIDE SANDYCOMBE ROAD

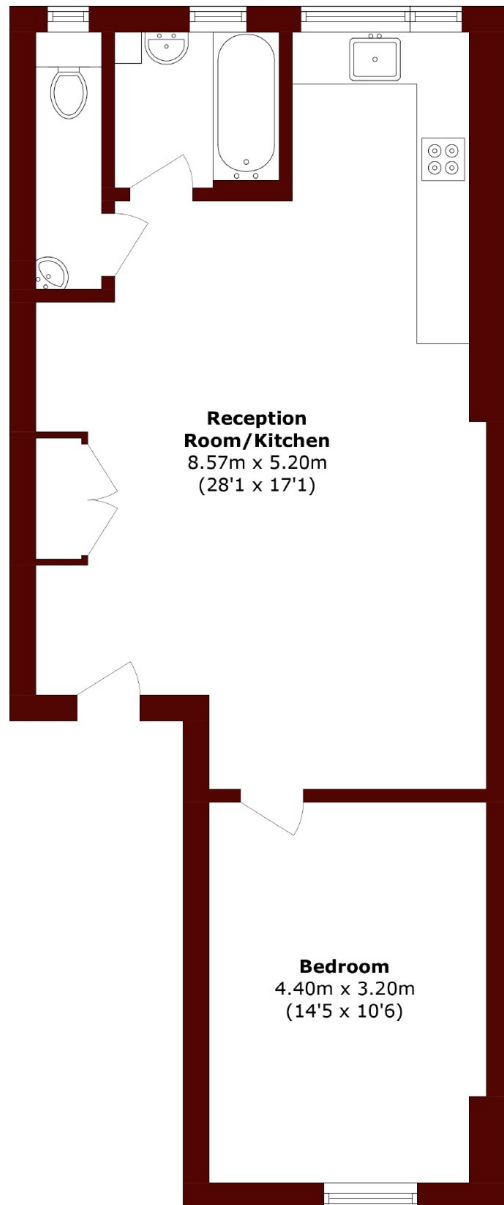

Total area (approx.): 57.8 sq. m (622.1 sq. ft)

Chiswick
020 8994 2556

Energy Rating: C We aim to make our particulars both accurate and reliable. However, they are not guaranteed; nor do they form part of an offer or contract. If you require clarification on any points then please contact us, especially if you're traveling some distance to view. Please note that appliances and heating systems have not been tested and therefore no warranties can be given as to their good working order

MARSH &
PARSONS