



John Ruskin Street, SE5

£499,950

A two bedroom ground floor character home benefiting from a private rear garden. Offering fantastic potential, the property provides an excellent opportunity for the next owner to modernise and create a home tailored to their own taste and style. The property benefits from a share of the freehold, a spacious reception room and a separate kitchen to the rear, which opens directly onto the private garden.

John Ruskin Street is a great location. A tree lined road with excellent access to Elephant & Castle, the green spaces of Burgess park and Camberwell. There are plenty of local shops and bus routes near by and it just a short walk to Kennington tube station (Northern Line).

Features

- Share of Freehold
- Private Garden
- Two Bedrooms
- Excellent Potential
- Separate Kitchen
- No Onward Chain

John Ruskin Street, London, SE5

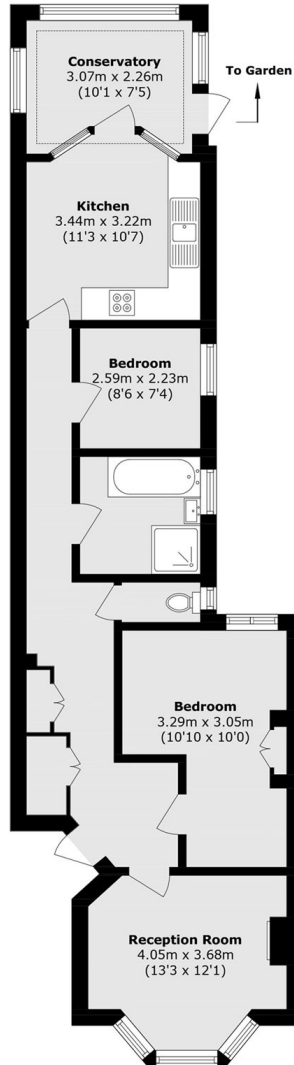

Total area (approx.): 66.7 sq. m (717.9 sq. ft)