



The Gardeners Lodge, Entrance of Chadderton Cemetery, Middleton Road, Oldham, OL9 0JZ

£499,950



ALL. TOGETHER. BETTER.

www.kirkham-property.co.uk

The Gardeners Lodge, Entrance of Chadderton Cemetery, Middleton Road, Oldham, OL9 0JZ

Set within the peaceful and historic grounds of Chadderton Cemetery, Gardeners Lodge offers a unique opportunity to acquire a distinctive one off and rarely available character property. Maintaining the character and charm expected of a traditional lodge seamlessly mixed with modern living, making it ideal for buyers seeking something out of the ordinary. Offered for sale with NO CHAIN therefore VACANT POSSESSION on completion the property would be ideally suited to the young and growing family looking for peaceful living, yet within walking distance of local amenities and transport links. Rich in character throughout the property seamlessly blends traditional and modern.

Step inside this substantial home and you will find, to the ground floor, lounge/dining room, modern kitchen, further separate lounge, downstairs bedroom and family bathroom. Off the first floor landing there are a further five bedrooms and another bathroom. Outside there is a gated driveway providing ample off road parking, plus further residents parking at the front of the property. To the rear is an enclosed lawned garden with mature trees and bushes.

Viewing is highly recommended to appreciate this one of a kind property.





Lounge Diner - 3.68m x 9.22m (12'1" x 30'3")

Kitchen - 3.48m x 4.42m (11'5" x 14'6")

Lounge - 4.29m x 5.72m (14'1" x 18'9")

Bedroom - 2.62m x 3.45m (8'7" x 11'4")

Bathroom - 3.66m x 3.07m (12'0" x 10'1")

Landing - 3.66m x 1.8m (12'0" x 5'11")

Bedroom - 3.89m x 4.01m (12'9" x 13'2")

Bedroom - 3.48m x 5.74m (11'5" x 18'10")

Bedroom - 3.48m x 4.65m (11'5" x 15'3")

Bedroom - 3.66m x 3.45m (12'0" x 11'4")

Bedroom - 3.66m x 3.07m (12'0" x 10'1")

Bathroom - 3.48m x 2.24m (11'5" x 7'4")

Additional Information

TENURE: Freehold - Solicitor to confirm details.

COUNCIL BAND: B - (£1,907.87) Please note these are subject to change occasionally, so we advise you make your own checks with the local council prior to completion.

VIEWING ARRANGEMENTS: Strictly by appointment with the agents.





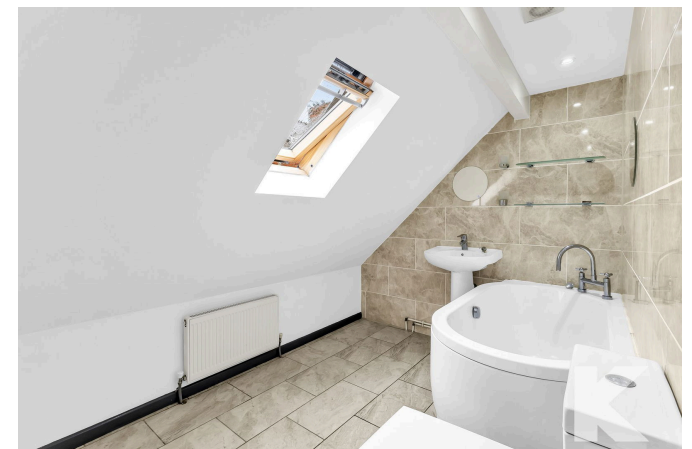

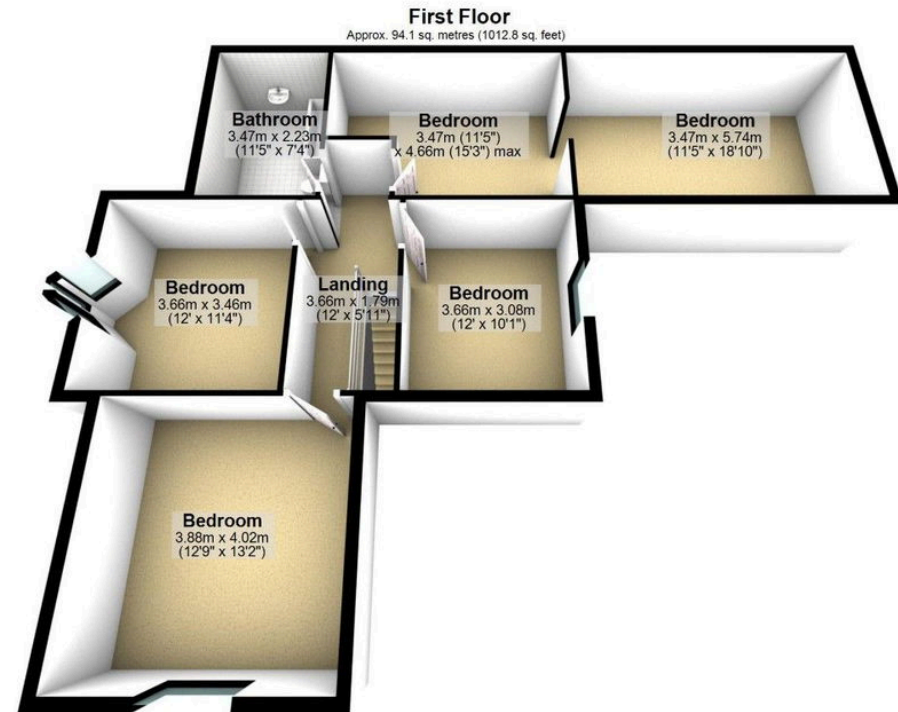
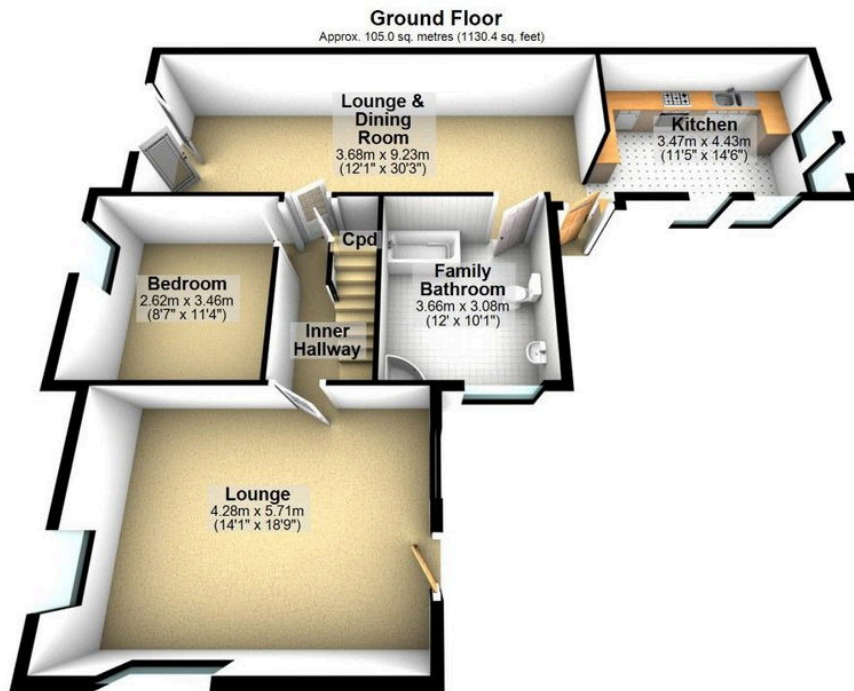

Total area: approx. 199.1 sq. metres (2143.1 sq. feet)

Disclaimer - Whilst every attempt has been made to ensure the accuracy of the floor plan contained here, this plan is for illustrative purposes only and should only be used as such by any prospective purchaser.
Plan produced using PlanUp.

Chadderton Office
509 Middleton Road,
Chadderton, Oldham,
OL9 9SH

chadderton@kirkham-property.co.uk
t: 0161 626 5688

www.kirkham-property.co.uk