

## Samuel Gray Gardens, KT2

£750,000

A spacious three bedroom, top floor apartment set within a sought after riverside gated development. Offered for sale with two allocated parking spaces, beautifully renovated and finished to an exceptional standard throughout, this is a standout home that should not be missed.

Mersey Court is located in Samuel Gray Gardens, a gated, riverside development just a few yards from the hustle and bustle of Kingston town and riverside, while scenic walks and parks along the river are close by.

### Features

- Three Bedrooms
- High Specification
- Top Floor
- Two Parking Spaces
- Gated Development
- No Onward Chain

# Samuel Gray Gardens, Kingston Upon Thames, KT2

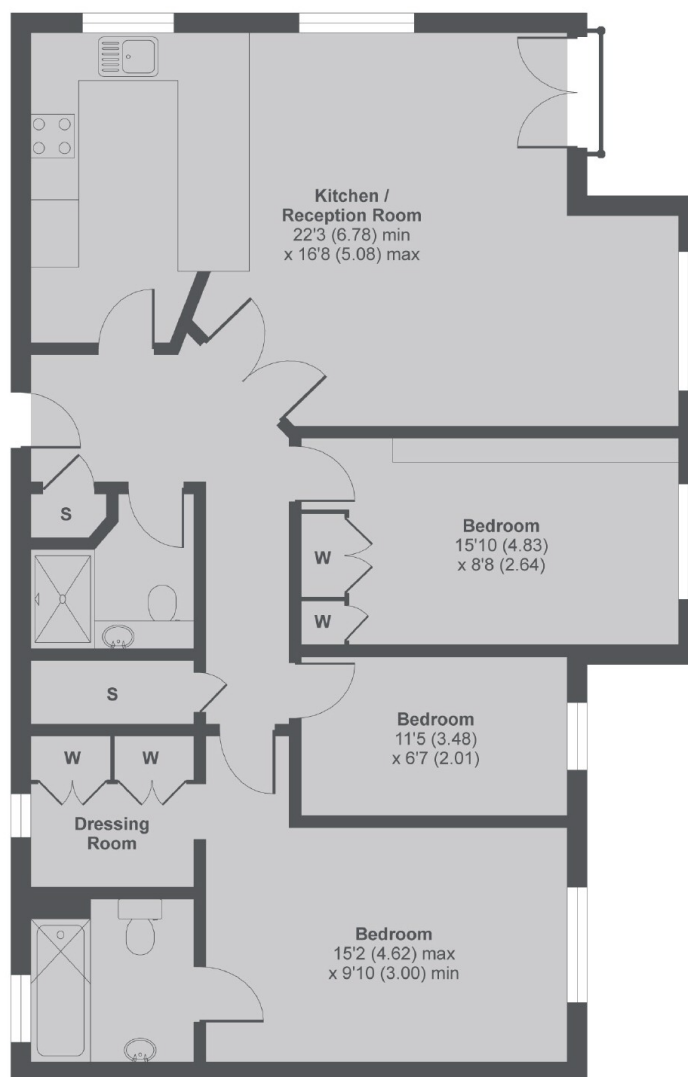

2nd Floor

## Samuel Gray Gardens, KT2

MAIN HOUSE APPROX FLOOR AREA 1055 SQ.FT 98 SQ.M

Copyright nichecom.co.uk 2017 Produced for Dexters REF : 171017