



## GEORGE HOUSE, NW6

£550,000

Two bedrooms  
Balcony  
High specification  
Engineered Oak flooring



# ABOUT THE PROPERTY

Situated on the sixth floor of a smart modern building, this large two-bedroom apartment is presented with incredibly stylish interiors and benefits from generous proportions and an abundance of natural light. The interior décor has been designed to a high specification to create a wonderful home whilst large floor to ceiling windows promote light. Engineered Oak flooring also extends throughout the property, as does underfloor heating.

The desirable apartment comprises a large open plan reception room with stylish fitted kitchen and ample space for dining, leading onto a large South facing balcony with far reaching views. Two generously



# STEP INSIDE GEORGE HOUSE

## George House, Albert Road, NW6

APPROX. GROSS INTERNAL FLOOR AREA 846 SQFT / 78.59 SQM

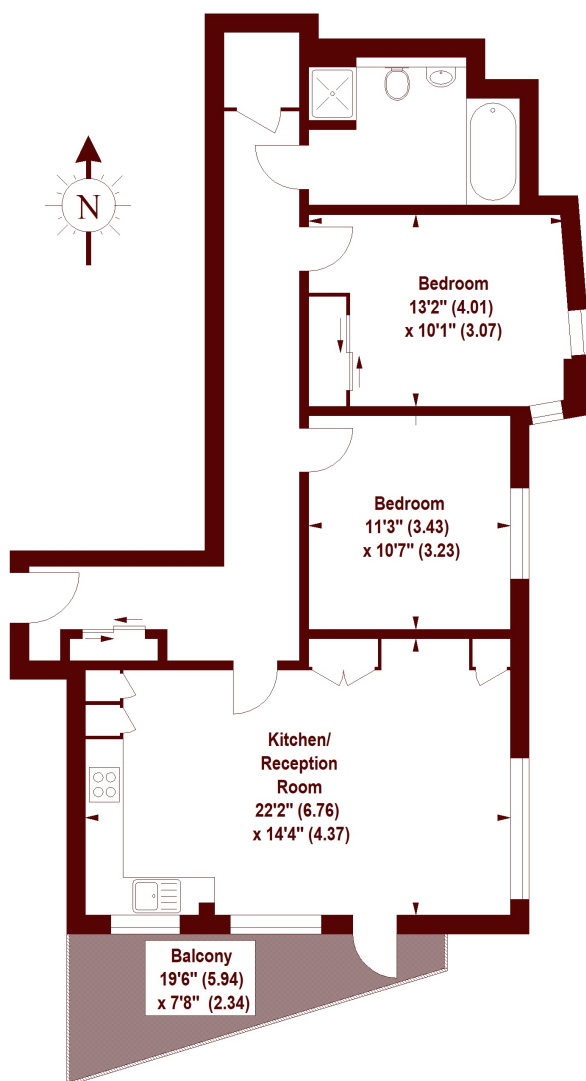

### SIXTH FLOOR

The floor plan is not to scale and measurements and areas shown are approximate and therefore should be used for illustrative purposes only. The plan has been prepared in accordance with the RICS code of Measuring Practice and whilst we have confidence in the information produced, it must not be relied on.

If there is any aspect of particular importance, you should carry out or commission your own inspection of the property.

Copyright of FeaturePRO.

Little Venice  
020 7993 3050

Energy Rating: We aim to make our particulars both accurate and reliable. However, they are not guaranteed; nor do they form part of an offer or contract. If you require clarification on any points then please contact us, especially if you're traveling some distance to view. Please note that appliances and heating systems have not been tested and therefore no warranties can be given as to their good working order

MARSH &  
PARSONS