



**POOLE
TOWNSEND**

Windermere Avenue, Barrow-in-Furness, LA14 4LN

£265,000

3 1 1



- 3 bed Detached Bungalow
- Bright Welcoming Lounge
- 3 Double Bedrooms
- Ample Parking
- Within Quiet Cul-De-Sac
- Fitted Kitchen
- Manageable Garden
- NO ONWARD CHAIN!



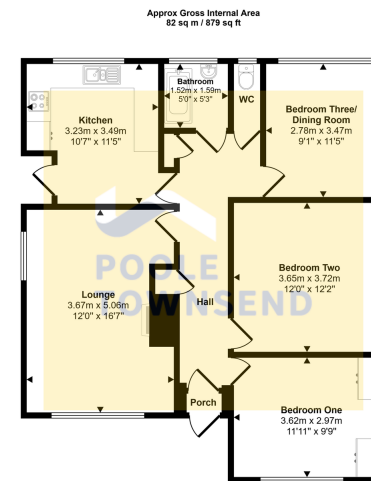

Floorplan

This floorplan is only for illustrative purposes and is not to scale. Measurements of rooms, doors, windows, and any items are approximate and no responsibility is taken for any error, omission or mis-statement. Icons of items such as bathroom suites are representations only and may not look like the real items. Made with Made Snappy 360.

NEW! Occupying a pleasant position within a quiet cul-de-sac, this detached true bungalow offers generously proportioned accommodation, manageable gardens, ample parking, and the opportunity to update and personalise to your own tastes and requirements. Offered with no onward chain, the property comprises a bright and welcoming lounge, a fitted kitchen, three double bedrooms, and a bathroom with a separate WC.

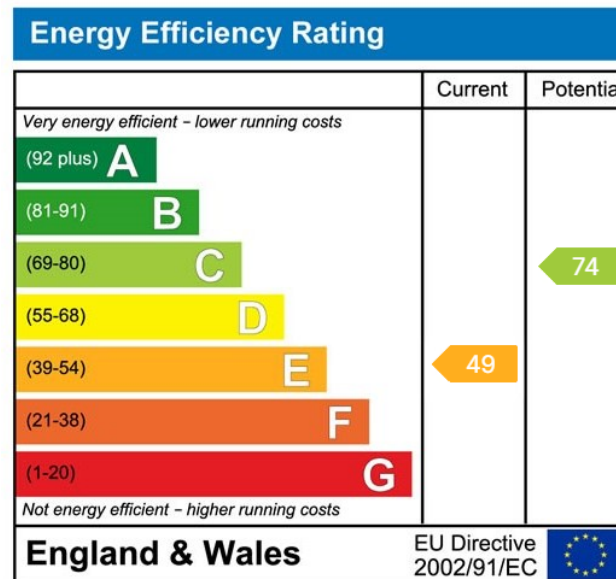

Visit us at
www.pooletownsend.co.uk
enquiries@pooletownsend.co.uk

We are open
 Monday – Friday 9.00 – 5.00
 Saturday 9.00 – 1.00

Barrow 01229 811811
 Ulverston 01229 588111
 Grange 015395 33316
 Kendal 01539 734455
 Milnthorpe 015395 62044