



**HUNTERS®**  
HERE TO GET *you* THERE

Cauldham Close, Capel-le-ferne | Asking Price £290,000  
Call us today on 01303 210335





### Thinking of Selling?

If you are thinking of selling your home or just curious to discover the value of your property, Hunters would be pleased to provide free, no obligation sales and marketing advice. Even if your home is outside the area covered by our local offices we can arrange a Market Appraisal through our national network of Hunters estate agents.

**Welcome to this mid-terrace house located on Cauldham Close in the picturesque village of Capel-le-Ferne. This property offers a perfect blend of comfort and convenience, making it an ideal home for families or those seeking a peaceful retreat.**

**As you enter, you are greeted by a spacious reception room that provides a warm and inviting atmosphere, perfect for relaxing or entertaining guests. The room is filled with natural light, creating a bright and airy feel throughout the space.**

**The house boasts three well-proportioned bedrooms, each offering a comfortable sanctuary for rest and relaxation. These rooms are versatile and can easily accommodate various furniture arrangements, making them suitable for both adults and children alike.**

**The property features a well-appointed bathroom, designed for both functionality and comfort. It provides all the essential amenities needed for daily routines.**

**Outside, the property benefits from a modest garden area, ideal for enjoying the fresh air or hosting summer barbecues. The location in Capel-le-Ferne is particularly appealing, as it offers a tranquil village atmosphere while still being within easy reach of local amenities and transport links.**

**This mid-terrace house on Cauldham Close presents an excellent opportunity for those looking to settle in a friendly community. With its practical layout and inviting spaces, it is sure to make a wonderful home for its next owners. Do not miss the chance to view this lovely property.**

GROUND FLOOR

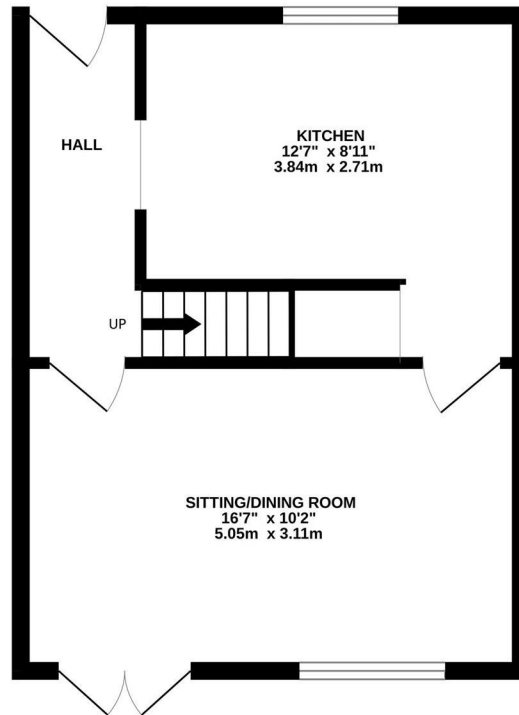

1ST FLOOR

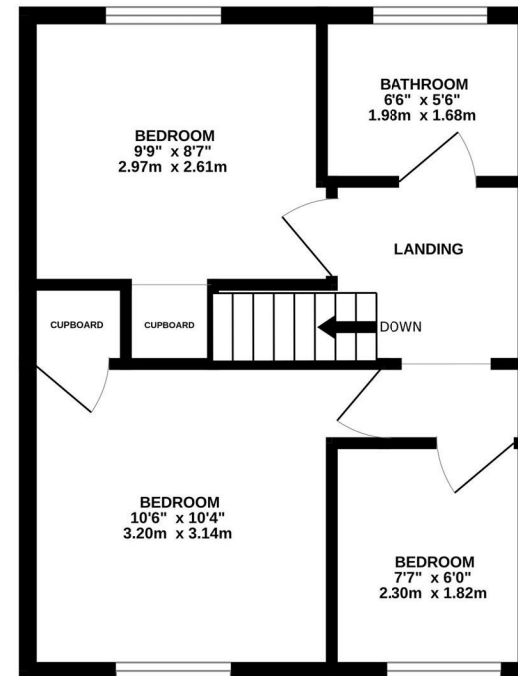

NOT TO SCALE - FOR LAYOUT PURPOSES ONLY

Whilst every attempt has been made to ensure the accuracy of the floorplan contained here, measurements of doors, windows, rooms and any other items are approximate and no responsibility is taken for any error, omission or mis-statement. This plan is for illustrative purposes only and should be used as such by any prospective purchaser. The services, systems and appliances shown have not been tested and no guarantee as to their operability or efficiency can be given.  
Made with Metropix ©2025

These particulars are intended to give a fair and reliable description of the property but no responsibility for any inaccuracy or error can be accepted and do not constitute an offer or contract. We have not tested any services or appliances (including central heating if fitted) referred to in these particulars and the purchasers are advised to satisfy themselves as to the working order and condition. If a property is unoccupied at any time there may be reconnection charges for any switched off/disconnected or drained services or appliances - All measurements are approximate.

93-95 Sandgate Road, Folkestone, CT20 2BQ | 01303 210335  
| folkestone@hunters.com

**HUNTERS**<sup>®</sup>  
HERE TO GET *you* THERE