



Bradshawgate, Bolton

OIRO £17,000



Key Features

- Student accomodation
- 3rd floor studio
- Access to facilities
- Town centre
- Close to transport links
- Ideal investment opportunity
- EPC rating C | Leasehold





Located in The Cube, a popular rental spot in Bolton town centre, is this modern studio offered for sale. This studio is located on Bradshawgate in the town Centre. Close to all the amenities including shops, restaurants and bars. It also offers great access to transport links by the bus and train all in walking distance.



Access to the property is via a secure communal door which leads to a reception area, staircase and lift. There is also the added benefit of use of the gym, communal lounge and laundry room. The studio itself is made up of an open lounge, kitchen and bedroom and a three piece shower room with wc and basin.



Tenure & Council Tax Band

We are advised that the property is PLEASE CONFIRM LEASEHOLD, YEARS REMAINING AND COST PER YEAR and within Bolton Council Tax Band A.

Bedroom, Lounge & Kitchen

Carpet flooring, electric heating, study area, fitted kitchen with wall and base units and vinyl flooring.

Shower room

Walk in shower cubicle, WC and hand wash basin.





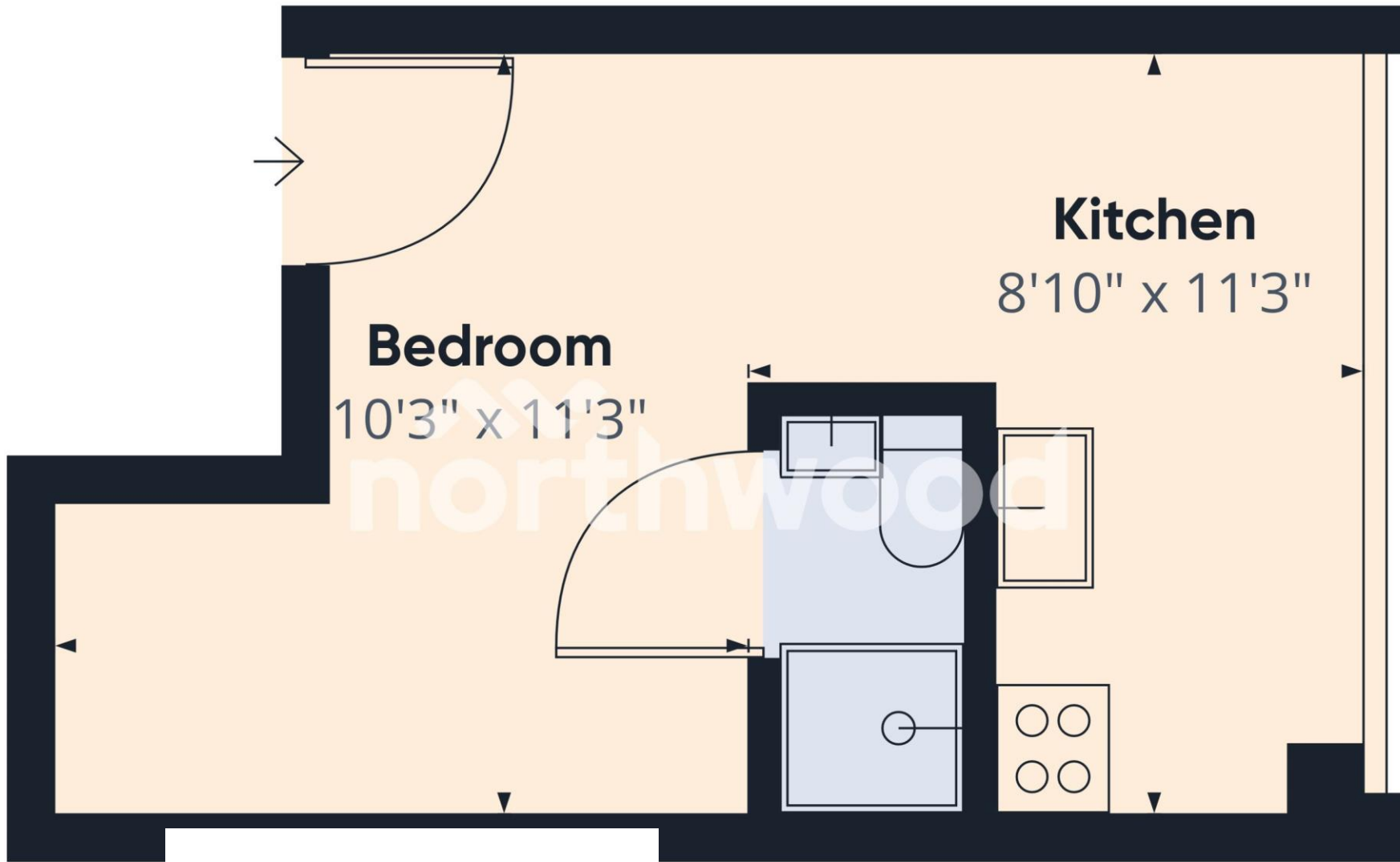

Approximate total area⁽¹⁾
193.31 ft²

(1) Excluding balconies and terraces

While every attempt has been made to ensure accuracy, all measurements are approximate, not to scale. This floor plan is for illustrative purposes only.

GIRAFFE360