



**POOLE  
TOWNSEND**

# 4 Hampsfield House, Windermere Road, Grange over Sands

£350,000

🛏️ 2 🚿 2 🚗 1



- Prestigious first-floor apartment
- Stunning elevated views towards Morecambe Bay
- Elegant Victorian character features
- Spacious and light-filled living room
- Stylish breakfast kitchen
- Two generous double bedrooms
- Contemporary en-suite
- Beautifully maintained communal gardens
- Allocated parking space
- Leasehold



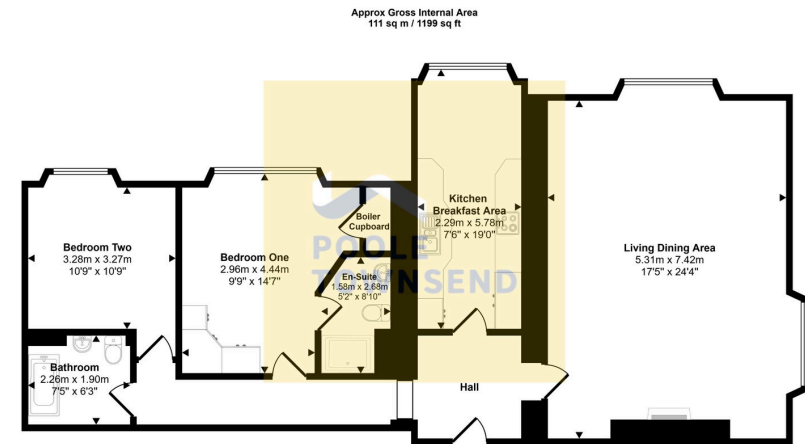

Floorplan

This floorplan is only for illustrative purposes and is not to scale. Measurements of rooms, doors, windows, and any items are approximate and no responsibility is taken for any error, omission or mis-statement. Icons of items such as bathroom suites are representations only and may not look like the real items. Made with Made Snappy 360.

Set within the prestigious Hampsfield House estate, this beautifully presented first-floor apartment combines elegant country house living with modern comfort. Occupying a prime position within the Victorian mansion, the property enjoys stunning views towards Morecambe Bay and the landscaped communal grounds. Rich in character, the accommodation features high ceilings, decorative cornicing, original panelling and a striking feature fireplace. The impressive living room is bright and welcoming, while the well-equipped breakfast kitchen offers integrated appliances and garden views. There are two double bedrooms, including a principal bedroom with fitted wardrobes and en-suite shower room, together with a contemporary bathroom. Residents benefit from allocated parking, cellar storage and beautifully maintained communal gardens. Conveniently located on the edge of Grange-over-Sands, with easy access to Windermere, and the M6, this is an

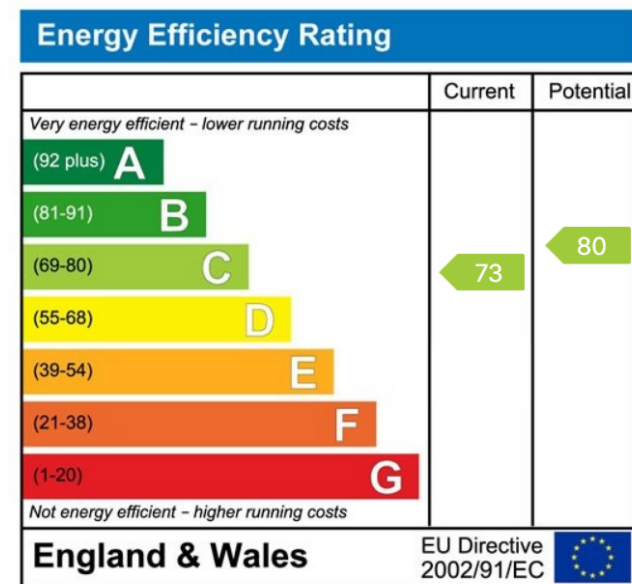

Visit us at  
[www.pooletownsend.co.uk](http://www.pooletownsend.co.uk)  
[enquiries@pooletownsend.co.uk](mailto:enquiries@pooletownsend.co.uk)

We are open  
 Monday – Friday 9.00 – 5.00  
 Saturday 9.00 – 1.00

Barrow 01229 811811  
 Ulverston 01229 588111  
 Grange 015395 33316  
 Kendal 01539 734455  
 Milnthorpe 015395 62044