

Mondial Way, Harlington, Hayes, UB3 5AR

Offers In Region Of £215,000

 1  1  1



IDEAL LOCATION | CHAIN FREE | IMMACULATE CONDITION

Shaws of London is delighted to present this immaculately presented one-bedroom second-floor apartment, ideally located on Bath Road, just moments from Heathrow Airport – making it an excellent choice for airport professionals, first-time buyers, or investors.

Leasehold Details: 117 years remaining

Service charge - £2488.92PA

Ground rent - £350PA

Council tax band: B

Property Overview:

Finished to a high standard with laminate flooring throughout, this stylish apartment offers a sleek, modern feel. The property comprises:

A fully fitted kitchen with integrated dishwasher, fridge freezer, dining table, sofa, and coffee table – ideal for entertaining

A contemporary bathroom suite complete with shower cubicle, toilet, sink, and mirrored wall

910 Uxbridge Road, Hayes
Middlesex UB4 0RW

info@shawsoflondon.co.uk
www.shawsoflondon.co.uk

020 8561 6888

 @shawsoflondon



cabinet

A bright and spacious living area offering comfortable modern living.

910 Uxbridge Road, Hayes
Middlesex UB4 0RW

info@shawsoflondon.co.uk
www.shawsoflondon.co.uk

020 8561 6888

 @shawsoflondon

- BUILT IN 2017
- CHAIN FREE
- IMMAULCATE CONDITION
- CROSSRAIL/M4/M25 TRANSPORT LINKS
- ONLY ELECTRIC HEATING
- IDEAL FOR 1ST TIME BUYER & INVESTORS
- UNDERGROUND ALLOCATED PARKING BAY
- VERY CLOSE TO HEATHROW AIRPORT
- AIR BNB OPPORTUNITY
- SPACIOUS 1 BED FLAT LOCATED ON THE 2ND FLOOR

Mondial Way, Harlington UB3 5AR

Approximate Gross Internal Area
581 sq ft - 53 sq m

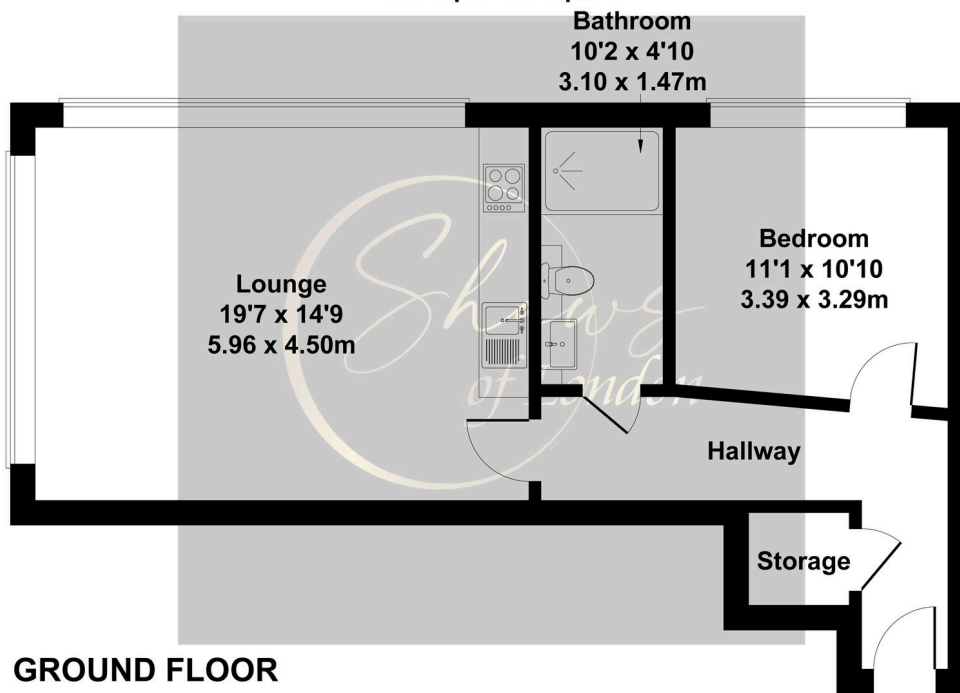

Not to Scale. Produced by The Plan Portal 2025
For Illustrative Purposes Only.