

Russell Road, CR4

£450,000

A ground floor, two double bedroom maisonette with a private garden and allocated parking space. There is a high emphasis on energy efficiency throughout including underfloor heating, new gas boilers & Aluminium double glazed windows. There is also a share of the freehold, long lease and no chain!

Century House is a small boutique development of just nine apartments, all with a share of the freehold. Tucked away on Russell Road, with Wimbledon & Tooting nearby by car. The wide green open spaces of Mitcham Common is also just a short walk away with its open grassy space, wooded areas & ponds, plus various trails for walking & running.

Features

- Two Double Bedrooms
- Ground Floor Apartment
- Private & Communal Gardens
- Allocated Parking Space
- Underfloor Heating
- Share Of The Freehold
- Quartz Worktops
- Modern Kitchens
- Bosch Oven & Hob
- Gas Boiler

Russell Road, Mitcham, CR4

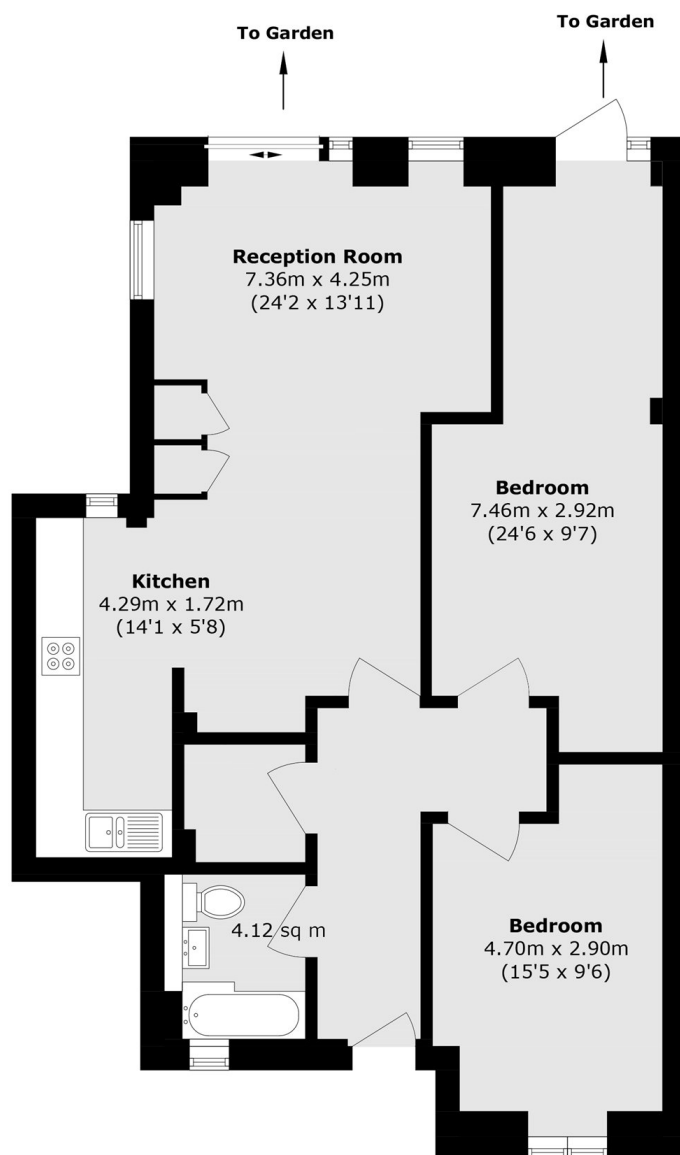

Total area (approx.): 80.6 sq. m (867.5 sq. ft)