

7 Denmark Street, Lancaster, LA1 5LY



£145,000



Head Office: 83 Bowerham Road Lancaster LA1 4AQ
T 01524 548888 E enquiries@mightyhouse.co.uk W www.mightyhouse.co.uk



Mighty House is a trading name of P&PC Surveyors Limited. Registered Office: 70 Daisy Hill, Dewsbury, WF13 1LS. Company no: 06498054

A beautifully presented two-bedroom mid-terraced home offering deceptively spacious, stylish accommodation throughout. Having been tastefully renovated to a high standard, this wonderful home is ready to move straight into, making it an excellent opportunity for first-time buyers, young professionals, or anyone seeking a low-maintenance property in a highly convenient location.

Ideally situated close to local schools, Lancaster train station, the city centre, and a wide range of everyday amenities, the property enjoys an excellent position for commuters and those wanting everything within easy reach.

Step inside to a bright and welcoming lounge that leads through to a stylish modern kitchen, creating a practical and inviting living space. Beyond the kitchen is a useful utility room and a contemporary ground floor bathroom. Upstairs, the property offers two generous double bedrooms, each providing comfortable and well-proportioned accommodation. Outside, there is a charming enclosed rear yard, perfect for enjoying a morning coffee or creating a low-maintenance outdoor retreat.

Combining quality, character, and a highly convenient location, this is a fantastic opportunity for first-time buyers or anyone looking to secure a beautifully presented home that is ready to move straight into.

Entrance Vestibule

Door to lounge.

Lounge



Double glazed window to the front, wall mounted electric fire, cupboard housing gas and electric meters, carpeted flooring, radiator.

Kitchen/Diner



Double glazed window to the rear, range of matching cabinets with complimentary work surfaces, four plate electric hob and extractor hood, electric oven, stainless steel sink, combi boiler, understairs storage cupboard, radiator, laminate flooring, stairs to the first floor landing.

Utility Room



Double glazed door to the yard and double glazed window to the side, plumbing for washing machine, space for fridge/freezer, radiator, laminate flooring.

Bathroom



Double glazed frosted window to the side, bath with Triton electric shower, wash hand basin, heated towel rail, tiled floor, W.C.

First Floor Landing

Bedroom One



Double glazed window to the front, built in wardrobes, access to the loft, carpeted flooring, radiator.

Bedroom Two



Double glazed window to the rear,

built in storage cupboard, carpeted flooring, radiator.

Outside



Pretty rear yard with gate to access road and patio area.

Useful Information

No Onward Chain
Tenure Freehold
Council Tx Ban (A) £1,669

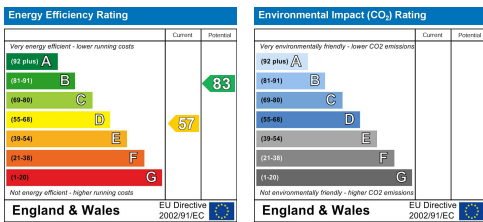

Head Office: 83 Bowerham Road Lancaster LA1 4AQ
T 01524 548888 E enquiries@mightyhouse.co.uk W www.mightyhouse.co.uk



Mighty House is a trading name of P&PC Surveyors Limited. Registered Office: 70 Daisy Hill, Dewsbury, WF13 1LS. Company no: 06498054

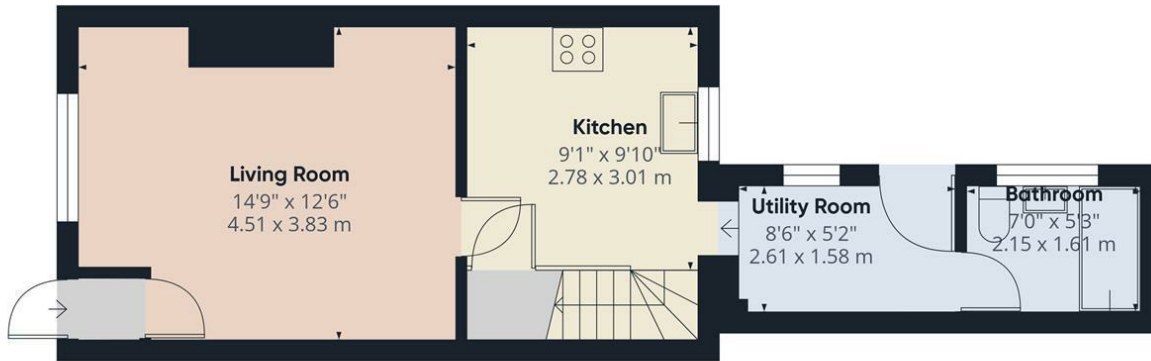

Ground Floor

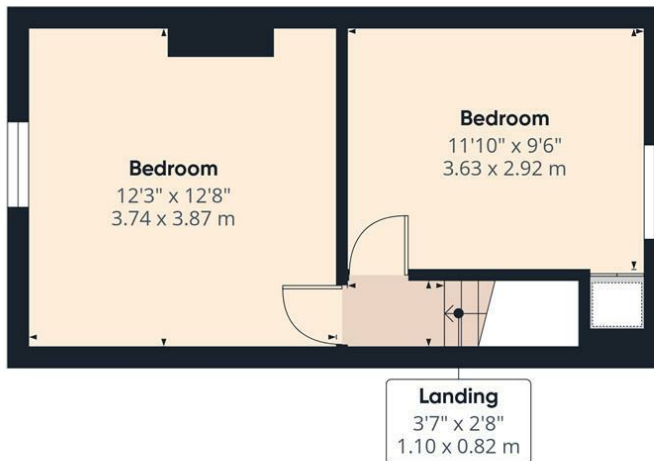

Floor 1



Approximate total area⁽¹⁾
655 ft²
60.8 m²

(1) Excluding balconies and terraces

Calculations reference the RICS IPMS 3C standard. Measurements are approximate and not to scale. This floor plan is intended for illustration only.

GIRAFFE360



Head Office: 83 Bowerham Road Lancaster LA1 4AQ
T 01524 548888 E enquiries@mightyhouse.co.uk W www.mightyhouse.co.uk



Mighty House is a trading name of P&PC Surveyors Limited. Registered Office: 70 Daisy Hill, Dewsbury, WF13 1LS. Company no: 06498054