



## 23 WHADDON CLOSE

NORTHAMPTON, NN4 9XS

**£385,000**  
**FREEHOLD**

Stonhills are pleased to offer this well-presented three-bedroom bungalow located in the popular area of Whaddon Close. The property benefits from a spacious lounge, kitchen/dining room, three bedrooms, family bathroom, good-sized rear garden, garage and off-road parking. The area offers a good range of local shops, schools and services, together with excellent road links to the A45, A43 and M1 and convenient access to Northampton town centre.



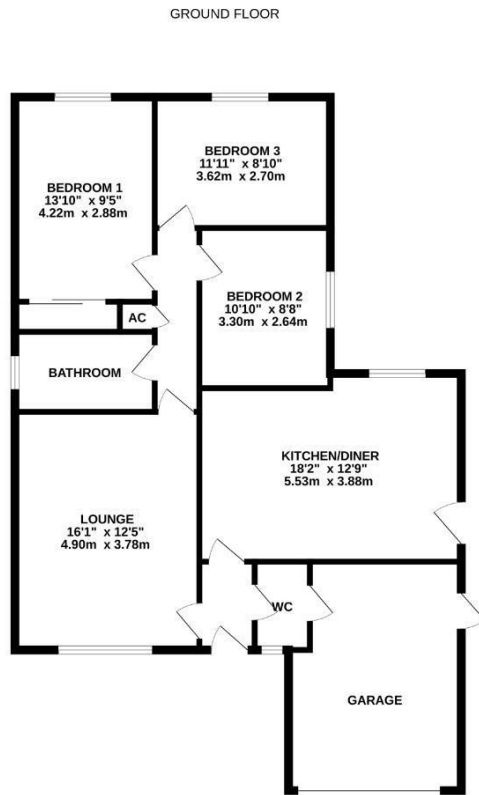

Whilst every attempt has been made to ensure the accuracy of the floorplan contained here, measurements of doors, windows, rooms and any other items are approximate and no responsibility is taken for any error, omission or mis-statement. This plan is for illustrative purposes only and should be used as such by any prospective purchaser. The services, systems and appliances shown have not been tested and no guarantee as to their operability or efficiency can be given. Must visit Message C025



Energy Efficiency Rating		
	Current	Potential
Very energy efficient - lower running costs		
(92 plus) <b>A</b>		
(81-91) <b>B</b>		
(69-80) <b>C</b>		
(55-68) <b>D</b>	<b>68</b>	
(39-54) <b>E</b>		
(21-38) <b>F</b>		
(1-20) <b>G</b>		
Not energy efficient - higher running costs		
<b>England &amp; Wales</b>	EU Directive	
	2002/91/EC	

Agents Note: Whilst every care has been taken to prepare these particulars, they are for guidance purposes only. All measurements are approximate and are for general guidance purposes only and whilst every care has been taken to ensure their accuracy, they should not be relied upon and potential buyers/tenants are advised to recheck the measurements

Northampton Office Sales  
 39 St Giles Street  
 Northampton  
 Northamptonshire  
 NN1 1JF

01604 624424  
 lewis@stonhills.co.uk  
<https://www.stonhills.co.uk/>

