



Augill Castle Leacett Lane | Brough | Kirkby Stephen | CA17 4DE

Guide Price £2,000,000



david britton
ESTATES



Key Features

- Grade II Listed Victorian Castle (c.1841)
- Circa 10 acres of private grounds & paddocks
- Award-winning business with 27-year trading history
- 10 boutique guest bedrooms
- Three estate cottages with turrets and battlements
- Incredible features including wooden panelling and gothic windows
- Generous gravel parking (30+ vehicles)
- On the edge of Yorkshire Dales and Lake District National Park
- 5 bedroom owners' cottage available by separate negotiation

Summary

Augill Castle is one of the most distinctive and versatile properties to come to market! It is an extraordinary opportunity with circa 10 acres of private grounds and a number of cottages, ideal for income or multi-generational families.





Floor plans

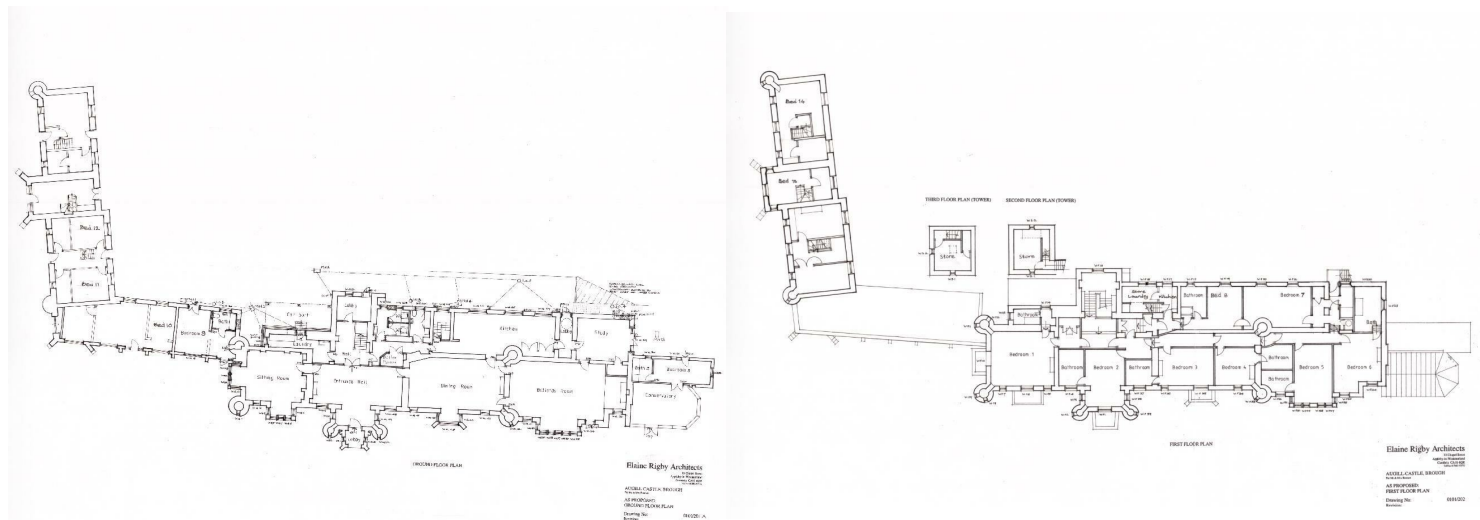

COUNCIL TAX BAND - Westmorland & Furness Exempt

DISCLAIMER

These particulars, whilst believed to be accurate are set out as a general guideline and do not constitute any part of an offer or contract. Intending Purchasers should not rely on them as statements of representation of fact but must satisfy themselves by inspection or otherwise as to their accuracy. The services, systems, and appliances shown may not have been tested and has no guarantee as to their operability or efficiency can be given. All floor plans are created as a guide to the lay out of the property and should not be considered as a true depiction of any property and constitutes no part of a legal contract.



Unit 3 Mason Court Gillan Way, Penrith 40 Business Park

Penrith

Cumbria

CA11 9GR

01768881111

Sales@brittonestates.co.uk

www.brittonestates.co.uk