



*jordan* fishwick

Flat 4 159 Withington Road, M16 8RP  
Guide Price £1,050 Per Calendar Month





**159 Withington Road  
Manchester M16 8RP**  
**£1,050 Per Calendar Month**



### The Property

**\*\*\* AVAILABLE NOW \*\*\*** A first floor, two bedroom apartment located within this highly desirable purpose built complex. Close by to Whalley Range and Chorltons amenities. The property is suited to a single occupant, couple and families. The accommodation comprises of living room, fully fitted kitchen, one generous double bedroom, with a second double room. The shower room is fitted with a walk in shower cubicle. Available furnished. Unallocated gated on-site parking to the rear, subject to availability. Additional on street parking available close by without the need for a permit from the council, at the time of writing. Contact our Didsbury office to arrange a viewing.

View our Virtual Tour Here - <https://www.youtube.com/shorts/6KvfUma6TT0>

EPC Rating C // Council Tax Band A



- Available Now
- Two Double Bedrooms
- First Floor Apartment
- Furnished
- Ideal for Individuals, Couples & Families
- Great Location of Whalley Range
- Close to all Local Amenities
- Gated On Site Parking
- Council Tax Band A
- EPC Rating C

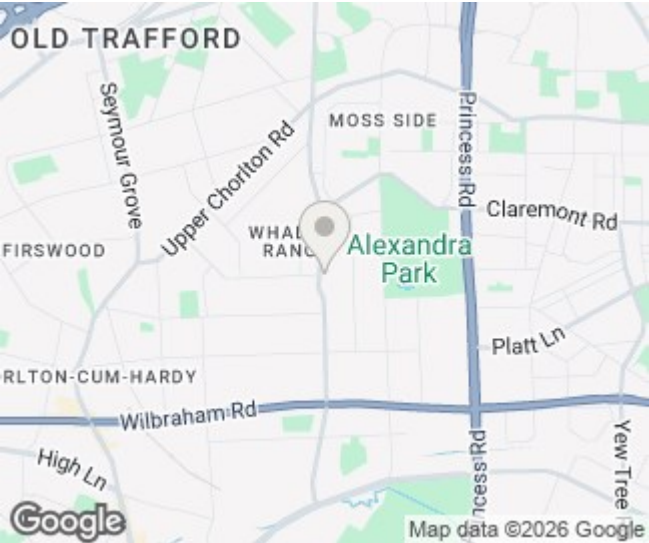

Energy Efficiency Rating		
	Current	Potential
Very energy efficient - lower running costs		
(92 plus) <b>A</b>		
(81-91) <b>B</b>		
(69-80) <b>C</b>	78	80
(55-68) <b>D</b>		
(39-54) <b>E</b>		
(21-38) <b>F</b>		
(1-20) <b>G</b>		
Not energy efficient - higher running costs		
<b>England &amp; Wales</b>	EU Directive 2002/91/EC 	



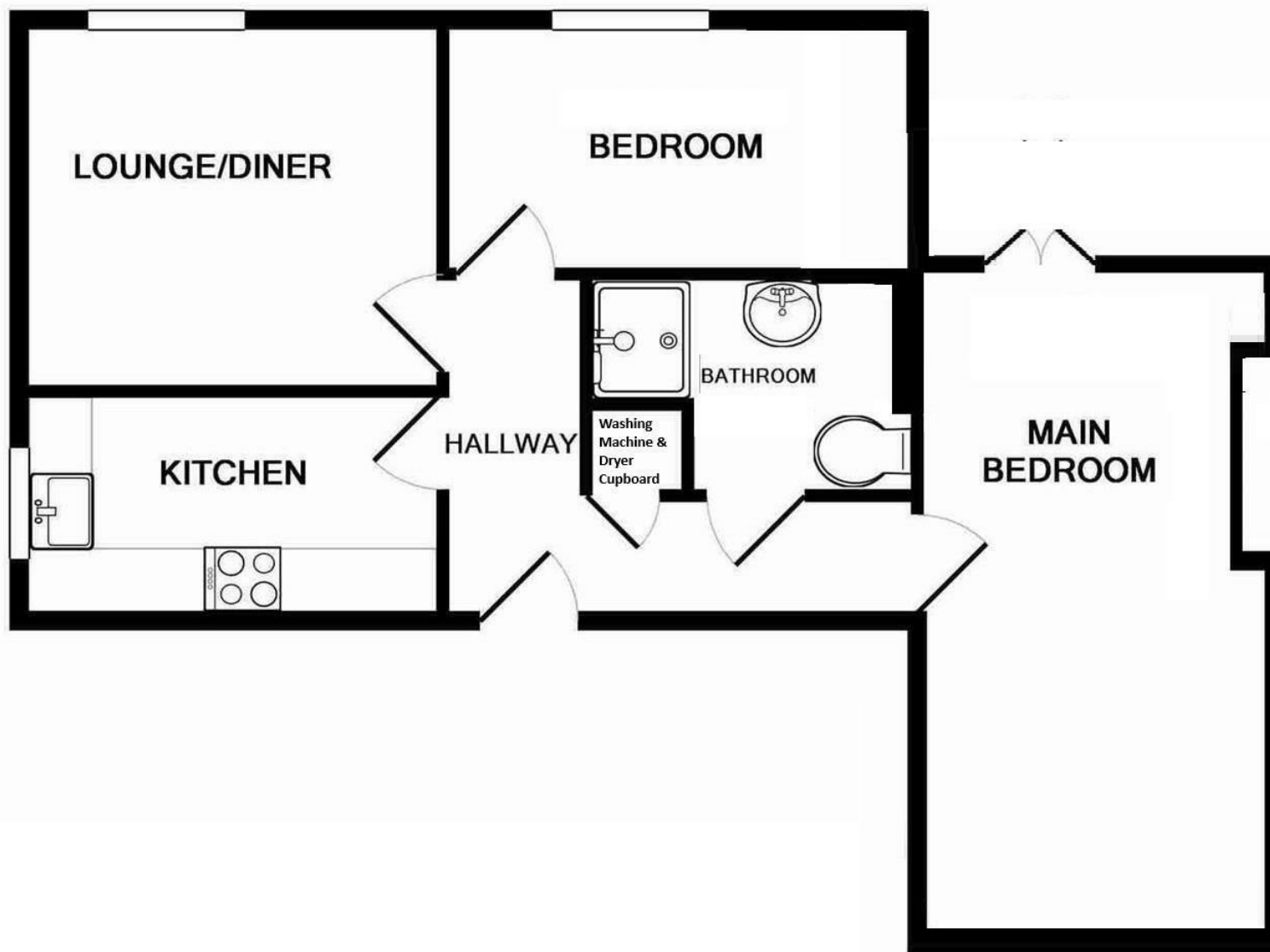

These particulars are believed to be accurate but they are not guaranteed and do not form a contract. Neither Jordan Fishwick nor the vendor or lessor accept any responsibility in respect of these particulars, which are not intended to be statements or representations of fact and any intending purchaser or lessee must satisfy himself by inspection or otherwise as to the correctness of each of the statements contained in these particulars. Any floorplans on this brochure are for illustrative purposes only and are not necessarily to scale.

Offices at: Chorlton, Didsbury, Disley, Hale, Glossop, Macclesfield, Manchester Deansgate, Manchester Whitworth Street, New Mills, Sale, Wilmslow and Withington