



White Lodge Close, TW7

£1,425 Per calendar month

This bright and inviting one bedroom apartment is located on the first floor of a well-regarded Isleworth development and offers a smart, easy-to-live-in layout. The open-plan kitchen and living area feels spacious and light, enhanced by a Juliet balcony, a generously sized double bedroom and the property also benefits from plenty of built-in storage and an allocated parking space,

White Lodge Close is a quiet residential development just moments from the shops, cafés and pubs of Old Isleworth, and within easy reach of the amenities found in Isleworth, Brentford and Richmond town centres, as well as the open green spaces of Syon Park.

Features

First Floor
One Bedroom

Popular Development

White Lodge Close, Isleworth, TW7

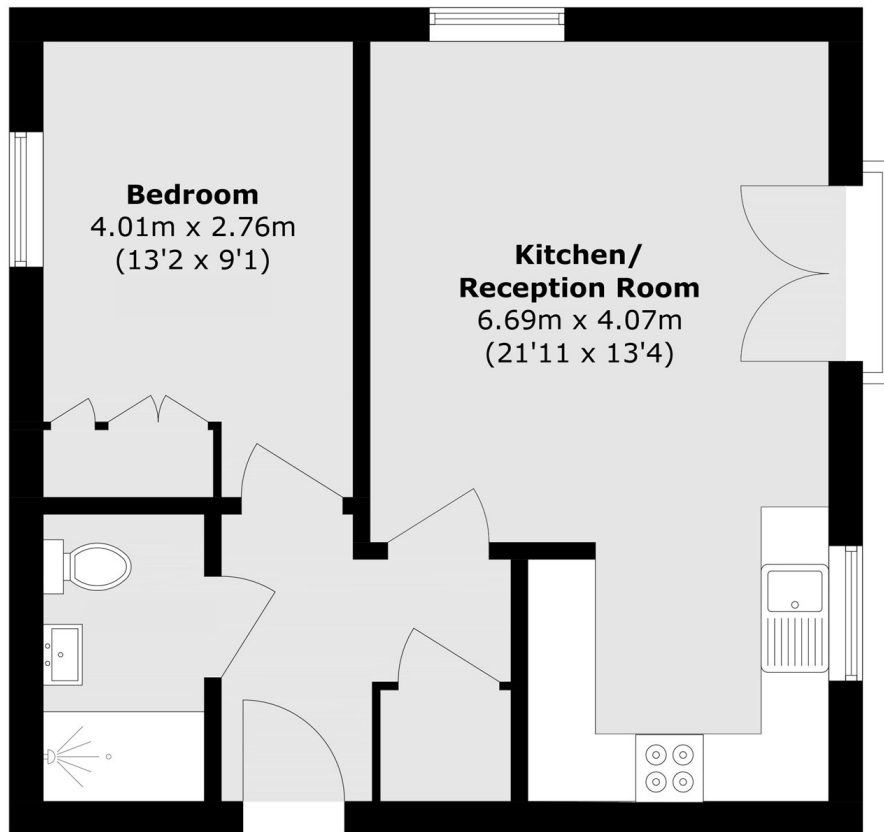

Total area (approx.): 47.0 sq. m (505.9 sq. ft)