

14 Bridge Street, Thetford, Norfolk, IP24 3AA
Tel: 01842 754161
thetford@chilternsestateagents.co.uk
www.shiresresidential.com

chilterns

Estate & Letting Agents



Avenue Gardens, Norfolk, IP24 1FB

Rent - £750 PCM Deposit - £865

A fabulous first floor one bedroom apartment situated ideally for town centre and railway station access, with secure gated parking.

- FIRST FLOOR APARTMENT
- ONE BEDROOM
- PERFECT STARTER HOME
- NO PETS / COUNCIL TAX BAND - A
- ALLOCATED PARKING
- CLOSE TO TOWN
- GAS HEATING & ENERGY RATING - C
- APPROXIMATE SIZE - 441 SQFT
- FAMILY BATHROOM
- AVAILABLE NOW



Council Tax Band: A - EPC Rating: C 80

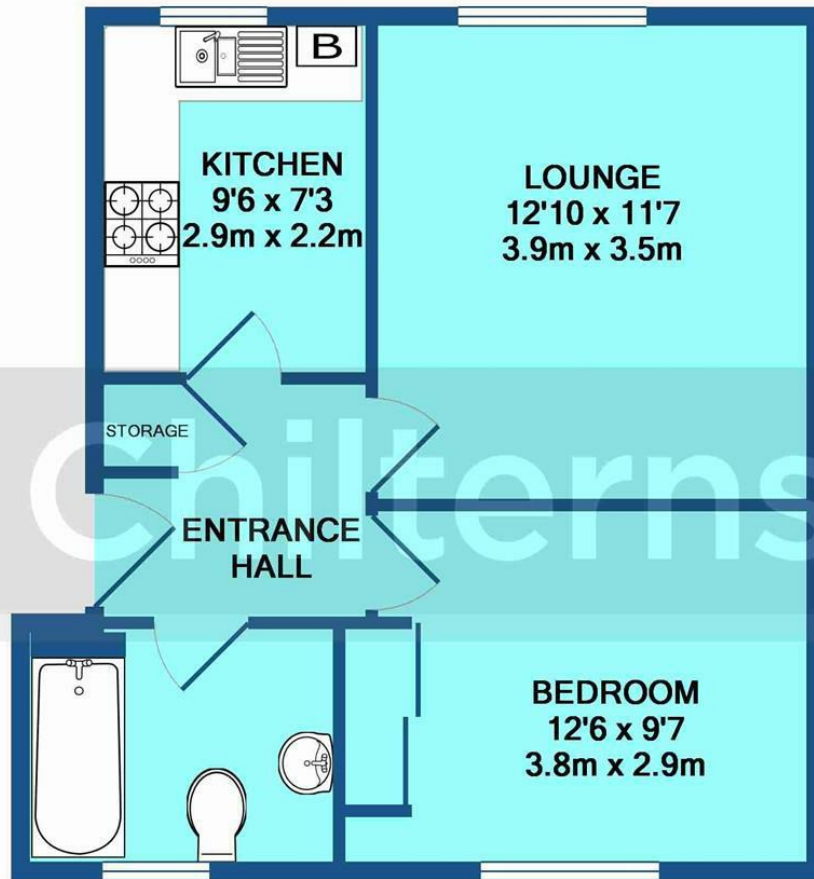

TOTAL APPROX. FLOOR AREA 432 SQ.FT. (40.2 SQ.M.)
Measurements are approximate. Not to scale. Illustrative purposes only
Made with Metropix ©2016

