

# 14 Malts Lane - £1,215 PCM

Hockwold Thetford IP26 4LA

shires

Estate & Letting Agents



*"Consistently providing outstanding service to our clients"*

# £1,215 PCM

## The Property

SHIRES is delighted to present this delightful detached bungalow on Malts Lane which offers a perfect blend of comfort and convenience. This property boasts three well-proportioned bedrooms, making it an ideal home for families or those seeking extra space.

The bungalow features two reception rooms, allowing for versatile use of space, whether it be for a formal dining area or a cosy study.

One of the standout features of this property is the lovely garden room, which invites natural light and offers a serene view of the surrounding garden.

The bungalow is complemented by a well-appointed bathroom and lots parking for up to four vehicles, ensuring convenience for both residents and visitors. The village location adds to the appeal, providing a peaceful setting while still being within easy reach of local amenities.

Please fill out the online enquiry on Rightmove and we will be in touch to book in a viewing.

## Features

- SPACIOUS 3 BED BUNGALOW
- GARDEN ROOM/CONSERVATORY/LIV ROOM
- HALL/KITCHEN/DINING ROOM
- 2 SINGLE BEDROOMS WITH LARGE MAIN BEDROOM
- BEAUTIFULLY PRESENTED GARDEN
- SINGLE GARAGE WITH LOTS PARKING
- VILLAGE LOCATION
- AVAILABLE LATE JAN/EARLY
- NEWLY REFURBISHED
- PERFECT FOR USAF MEMBERS



These sales particulars have been produced as a general guide only and we would draw to your attention that we have not carried out a detailed Survey of the property nor have we tested services, appliances or specific fittings. Whilst measurements and statements given within the details are provided in good faith, their accuracy should not be relied upon. If there are any points about which you may be uncertain or would like further clarification, we would suggest that you telephone this office and speak to our staff who will endeavour to assist you.

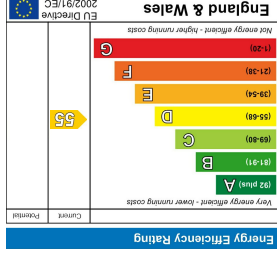

What every attempt has been made to ensure the accuracy of the floorplan contained here, measurements of rooms, windows, doors and fixtures are to be regarded as approximate and should be used as such by any prospective purchaser. The services, systems and appliances shown have not been tested and no guarantee is given as to their quality or efficacy can be given. Made with Mapbox ©2023

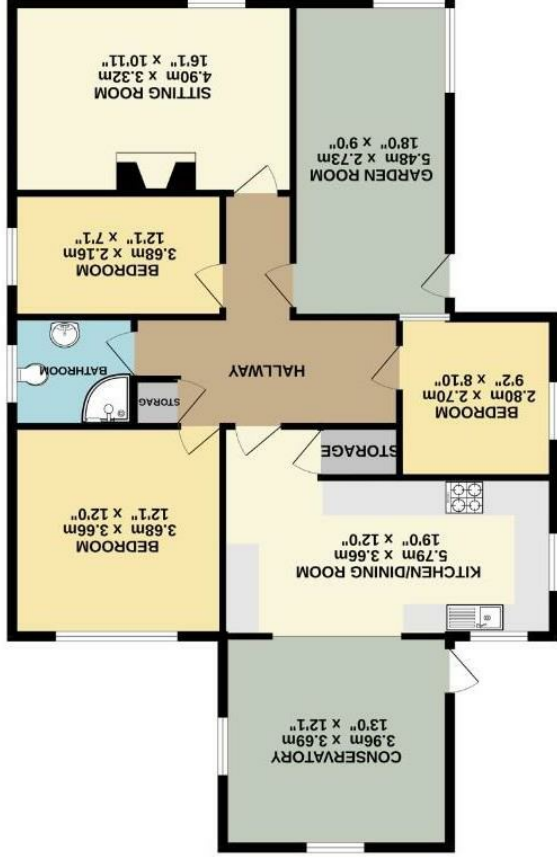

GROUND FLOOR



4 New Street, Mildenhall, Suffolk, IP28 7EN  
 T: 01638 712132  
 E: mildenhall@shiresestateagents.co.uk