



BRONDESBURY PARK, NW6

£425,000

Two Double Bedrooms
Separate Kitchen
Good Condition Throughout
Communal Garden & Parking
Chain-Free
Close To Transport Links

@marshandparsons
marshandparsons.co.uk

MARSH &
PARSONS



ABOUT THE PROPERTY

Set within a secure block is this two double bedroom lateral flat on the third floor located opposite Brondesbury Park Overground station, with a communal garden to the rear and access to parking. The property has a separate kitchen, built-in storage, is presented throughout in good condition, and is available chain-free.

Waverley Court is located in the sought-after area of Brondesbury Park, and is in close proximity to the shops, cafes, bars and restaurants on Salusbury Road. Transport links include Brondesbury Park (Overground), Kilburn (Jubilee), and Queen's Park (Bakerloo & Overground).



STEP INSIDE BRONDESBURY PARK

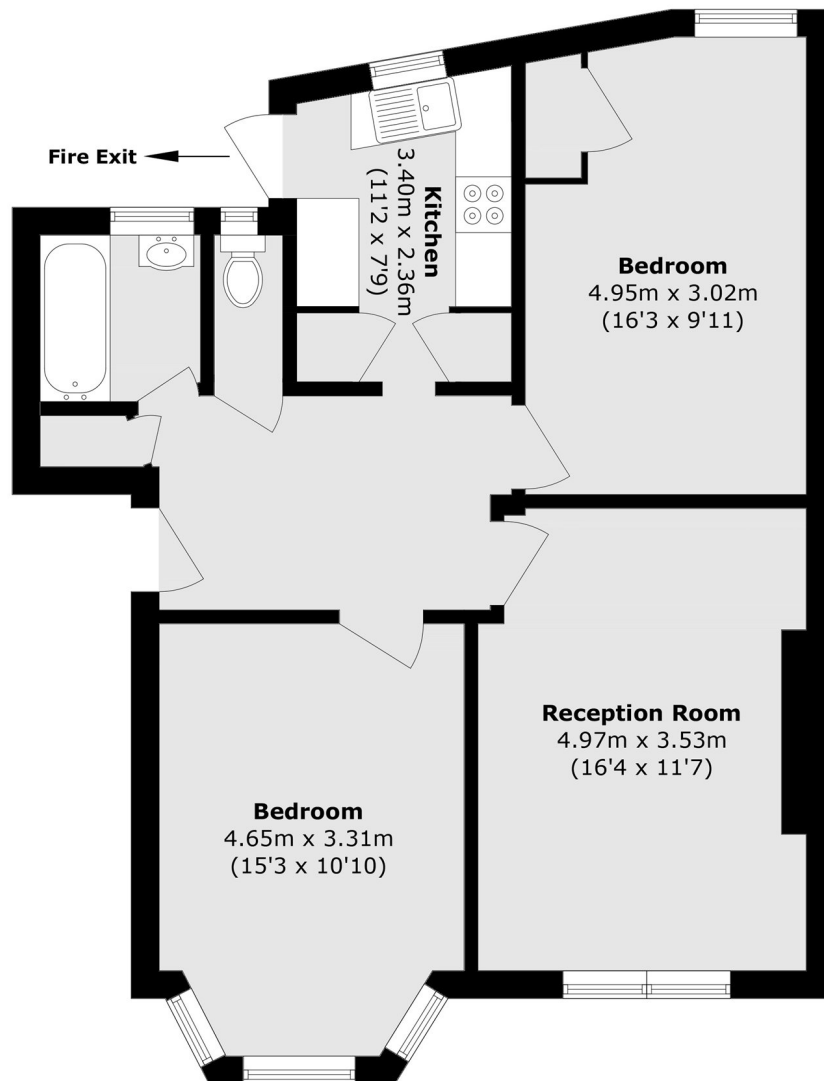

Total area (approx.): 70.4 sq. m (757.7 sq. ft)

Queen's Park
020 7624 4513

Energy Rating: D We aim to make our particulars both accurate and reliable. However, they are not guaranteed; nor do they form part of an offer or contract. If you require clarification on any points then please contact us, especially if you're traveling some distance to view. Please note that appliances and heating systems have not been tested and therefore no warranties can be given as to their good working order

MARSH &
PARSONS