



Peckham Grove, SE15

£375,000

A beautifully appointed two bedroom, two bathroom apartment set within a modern development in the heart of Peckham. Located on the third floor and extending to just over seven hundred square feet, this well presented home offers generous proportions, excellent natural light and a calm outlook over the internal courtyard. The apartment opens into a wide entrance hall with a useful storage cupboard for coats and everyday essentials. The principal bedroom is a comfortable double with fitted storage and a contemporary en suite shower room. The second bedroom is also a good double and is currently arranged as a home office. A smart family bathroom sits off the hallway and is finished in a clean and neutral style. The main living space is arranged in an open plan format with distinct areas for cooking, dining and relaxing. The kitchen is set to the rear with modern cabinetry, integrated appliances and ample preparation space. The reception area opens onto a private balcony with far reaching views towards the London skyline, providing an ideal spot for morning coffee or an evening drink. Residents have access to secure bicycle storage and a private underground parking space. The building is well maintained and enjoys a strong sense of community.

Grove Court enjoys a convenient position close to the independent restaurants, cafes and boutiques of Peckham, with further amenities available in Camberwell and along the Old Kent Road. Burgess Park is a short walk away and offers wide open green space, lakeside paths and sporting facilities.

Features

- Two Double Bedrooms
- Two Bathrooms
- Balcony With City Views
- Underground Car Park
- Secure Bike Storage
- Close To Burgess Park

Peckham Grove, London, SE15

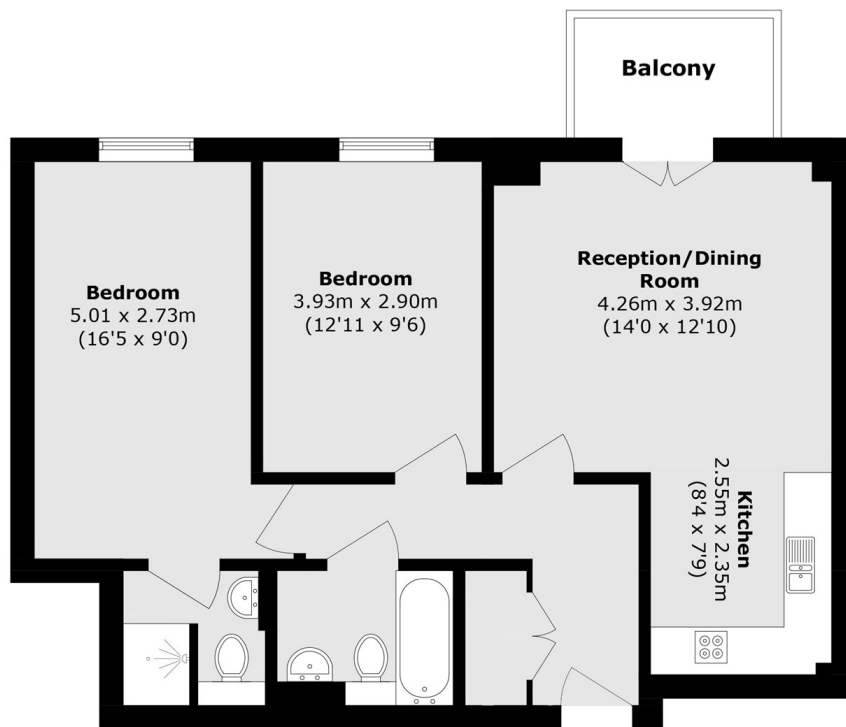

Total area (approx.): 66.9 sq. m (720.1 sq. ft)

Balcony area (approx.): 3.7 sq. m (39.8 sq. ft)