



Property Features

- Detached House
- Four Bedrooms
- Modern Bathroom
- Council Tax Band E / EPC D
- Two Reception Rooms
- Garage
- Driveway Parking
- Rear Garden
- Unfurnished
- Available late March

Full Description

A detached house is situated in a peaceful and desirable area of Hazlemere. This beautiful property boasts two impressive reception rooms, both of which provide ample space for comfortable and stylish living. The reception rooms are well-proportioned, making it the perfect place to entertain guests or relax with the family. In addition, this property boasts a downstairs WC and excellently sized rear garden with a patio, perfect for enjoying the sun throughout the day or hosting an al fresco dinner party. The garden is well-maintained and features tasteful landscaping, making it perfect for the keen gardener or those looking for a peaceful outdoor retreat. The property also has a garage offering secure parking for one vehicle, in addition to ample off-road parking. The property features four bright and spacious bedrooms with ample natural light. Furthermore, there is one modern bathroom accompanying the four bedrooms, complete with a bath and a shower.

Hazlemere is a fantastic place for families to live as it is home to many excellent schools for all ages, local parks, shops, cafes, and pubs. High Wycombe is also home to several bustling cultural attractions such as the Wycombe Arts Centre and the High Wycombe Swan Theatre. There is an abundance of parks and green spaces, including the popular Hughenden Park, perfect for picnics and exploring with children.

Overall, this property in Hazlemere offers an excellent combination of high-quality living, great comfort, and convenience, making it the perfect place for a family to call home.





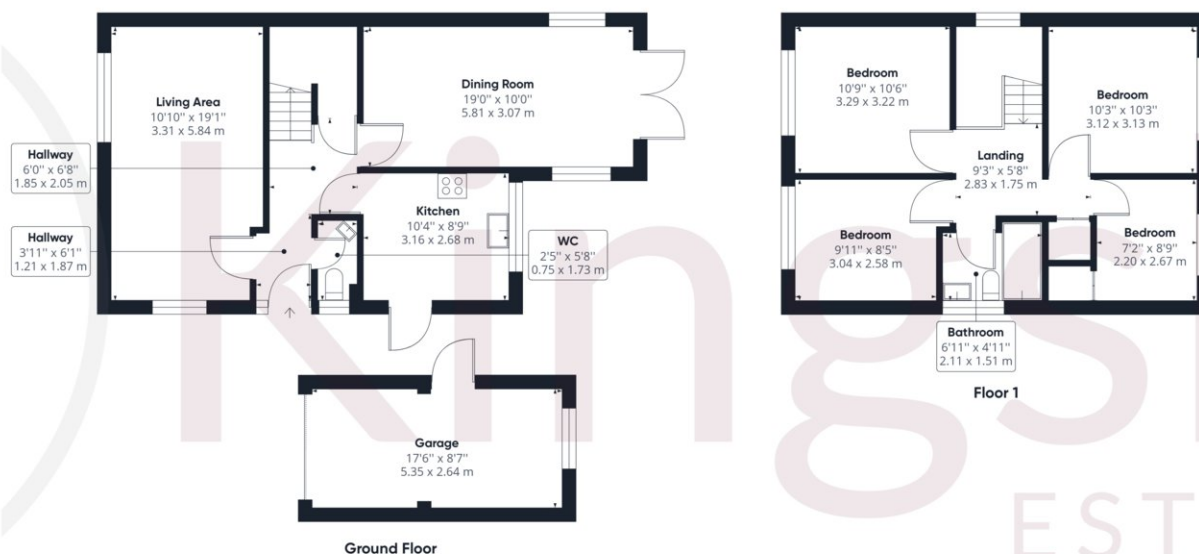

Approximate total area⁽¹⁾
1253.80 ft²
116.48 m²

⁽¹⁾ Excluding balconies and terraces

While every attempt has been made to ensure accuracy, all measurements are approximate, not to scale. This floor plan is for illustrative purposes only.

GIRAFFE360