



Palladian Gardens, W4

£461 Per week

A luxurious apartment within a gated development. An open-plan kitchen/reception leads out to a good sized South facing balcony. The property has access to fabulous communal gardens, there is an on site concierge and underground parking space.

Only a short walk away from the River Thames and Chiswick House and Grounds. Chiswick High Road is nearby with a fantastic selection of amenities as well as Turnham Green Terrace Station.

Features

One Bedroom

Gated Development
Secure Underground Parking
Concierge
Communal Gardens

Palladian Gardens, London, W4

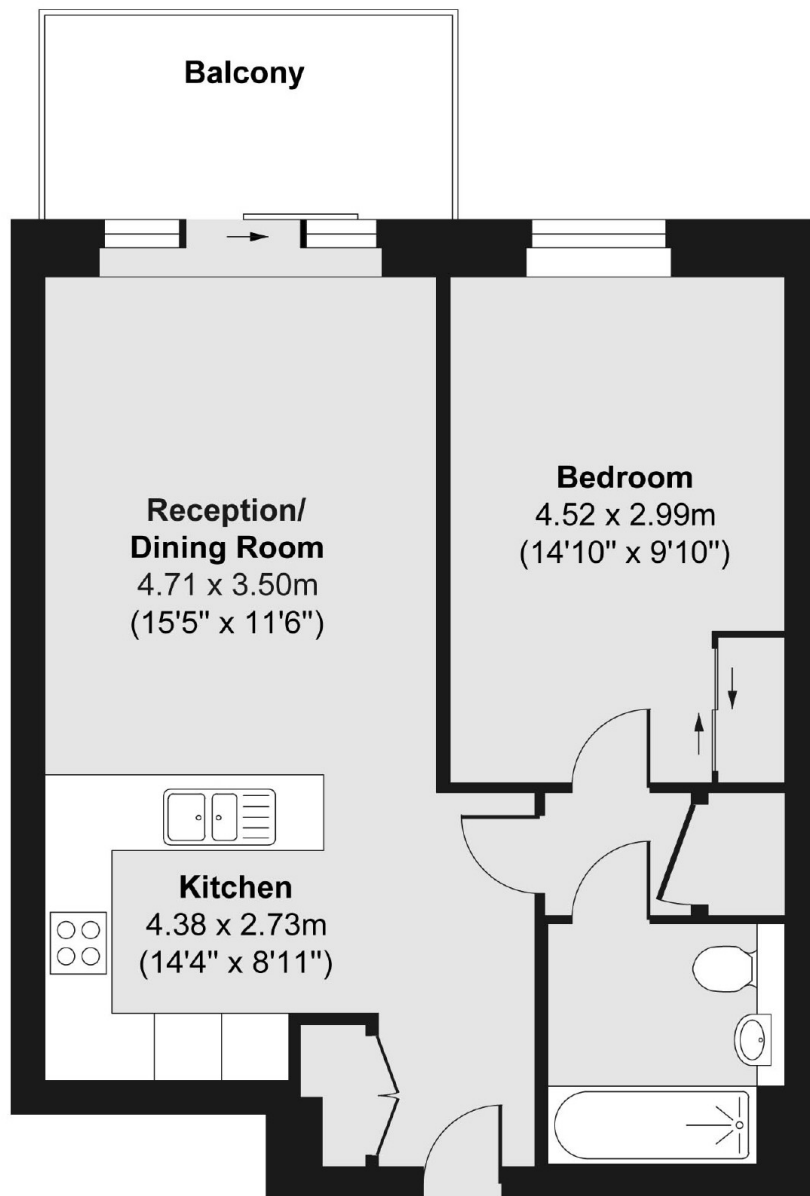

Total area (approx.) 51.41 sq. m (553 sq. ft)
Balcony area (approx.) 6.66 sq. m (72 sq. ft)