



## Milles Square, SW9

£475,000

 2  2  1  B

- Two bedrooms
- Two bathrooms

- Modern kitchen
- Private balcony

- Private gated development
- Energy rating: B





## ABOUT THE PROPERTY

A impressive two bedroom apartment set within a popular development that benefits from secure entry, lift access, concierge and secure bike storage. Situated on the third floor, the apartment boasts a spacious and modern kitchen with integrated appliances and a lovely open plan reception room with wooden floors, leading out to a sunny west facing private balcony. This property also boasts a large master bedroom, with an en suite and a further second double bedroom and modern family bathroom with shower over bath. Offered to the market chain free.



Located in the heart of Brixton and close to the vast array of independent shops, cafes, restaurants and bars including the popular Brixton Village with easy access to Central London via Brixton Underground (Victoria Line) and Brixton Overground Station.



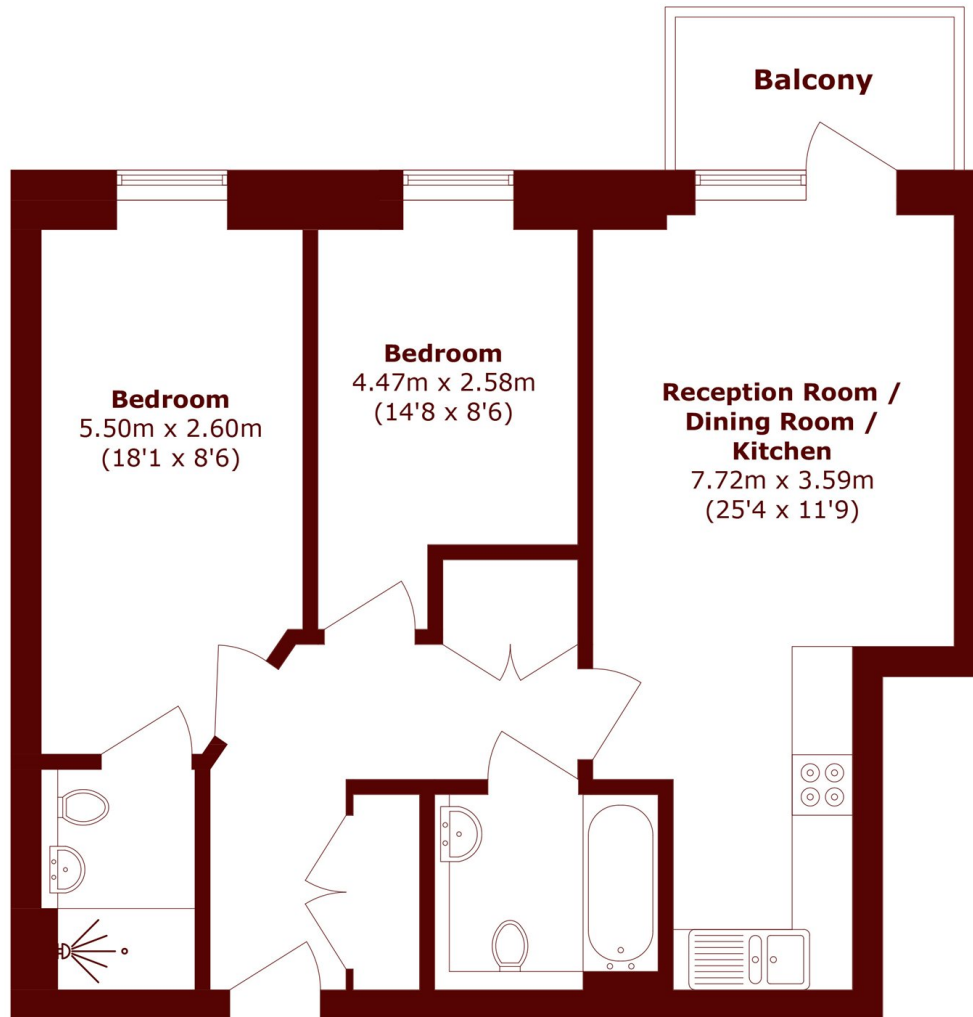

Total area (approx.): 67.6 sq. m (727.6 sq. ft)

Balcony area (approx.): 4.2 sq. m (45.2 sq. ft)

## Marsh & Parsons Brixton

400-402 Coldharbour Lane,  
London, SW9 8LF  
020 7733 4595