



Salisbury Road, Peterborough
Offers in Excess of £210,000 Freehold

**Sharman
Quinney**

Key Features



- No Upward Chain
- Two Bedrooms
- Off Road Parking
- Garage
- Rear Garden

GROUND FLOOR

ENTRANCE HALL: UPVC Double glazed entrance door. Radiator. Loft access.

KITCHEN: 3.04m x 2.47m (10' x 8'11") UPVC Double glazed window to rear and door to side. Fitted with a range of base and wall units. Stainless steel sink and drainer with mixer tap. Built in cupboard housing wall mounted boiler.

LOUNGE: 3.98m x 3.35m (13'07" plus recess x 11'02" max) UPVC Double glazed window and door to rear. Radiator.

BEDROOM: 3.35m x 3.68m (11' x 12'10") UPVC Double glazed window to front. Radiator.



BEDROOM: 3.05m x 2.77m (10'01" x 9'10")
UPVC Double glazed window to side. Radiator.
Built in cupboard.

BATHROOM: Two UPVC frosted double glazed windows. Wash hand basin. Bath with wall mounted electric shower. Radiator.

OUTSIDE

FRONT: Driveway providing off road parking.

GARAGE: Up and over door. Personal door and window to side.

REAR GARDEN: Enclosed by fencing and hedging. Lawn area.



GROUND FLOOR

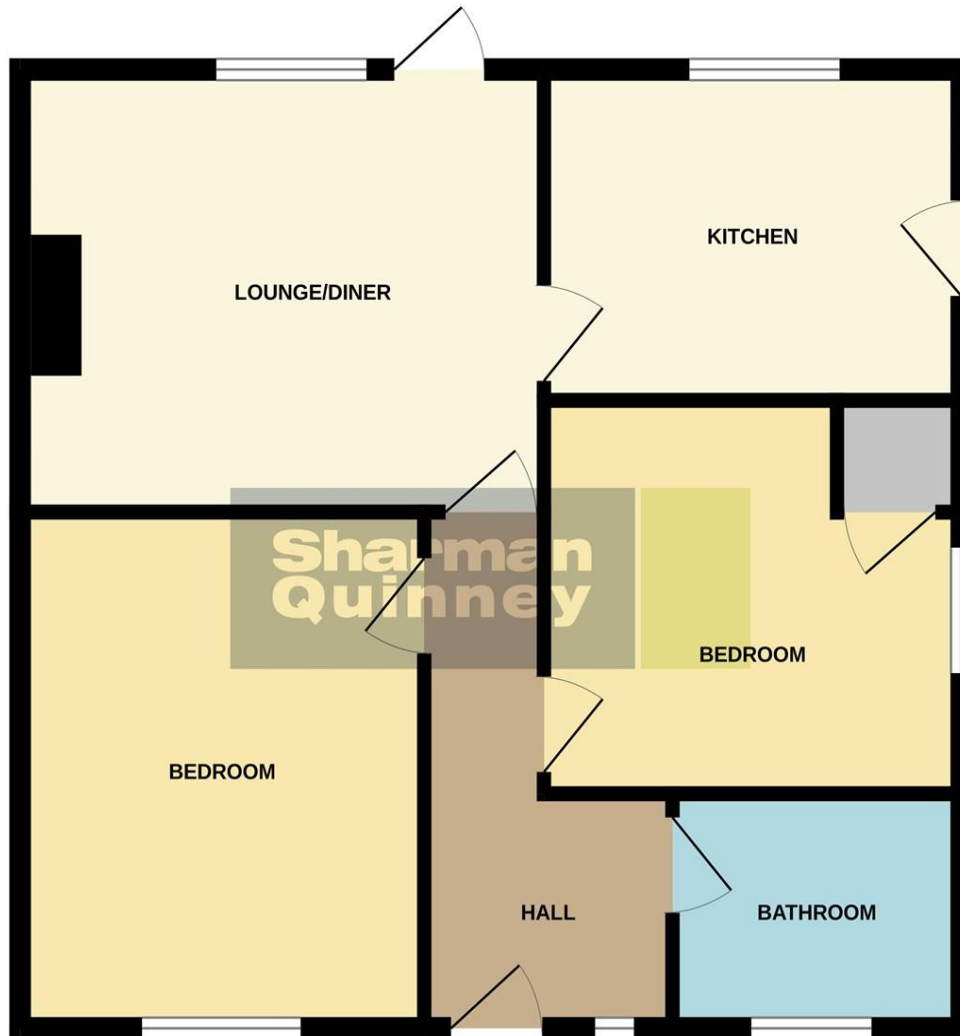

Whilst every attempt has been made to ensure the accuracy of the floorplan contained here, measurements of doors, windows, rooms and any other items are approximate and no responsibility is taken for any error, omission or mis-statement. This plan is for illustrative purposes only and should be used as such by any prospective purchaser. The services, systems and appliances shown have not been tested and no guarantee as to their operability or efficiency can be given.
Made with Metropix ©2026

To view this property call Sharman Quinney on:
01733 575757

Selling your property?

Contact us to arrange a **FREE** home valuation.

 01733 575757

 Loxley Centre, Werrington, Peterborough, Cambridgeshire, PE4 5BW

 werrington@sharmanquinney.co.uk

 www.sharmanquinney.co.uk



 SCAN ME



Sharman Quinney Holdings Limited is registered in England and Wales under company number 4174227, Registered Office is Cumbria House, 16-20 Hockliffe Street, Leighton Buzzard, Bedfordshire, LU7 1GN. VAT Registration Number is 500 2481 05.

1: These particulars do not constitute part or all of an offer or contract. 2: The measurements indicated are supplied for guidance only and as such must be considered incorrect. 3: Potential buyers are advised to recheck the measurements before committing to any expense. 4: Sharman Quinney has not tested any apparatus, equipment, fixtures, fittings or services and it is the buyers interests to check the working condition of any appliances. 5: Sharman Quinney has not sought to verify the legal title of the property and buyers must obtain verification from their legal representative. 6: Intending purchasers will be asked to produce identification documentation at a later stage and we would ask your co-operation in order that there will be no delay in agreeing the sale. Ref: WER205671 - 0004

