



Linacre Road, NW2

£490,000

This two bedroom, ground floor apartment is located within a desirable period building on a favourable residential road. The flat benefits from a separate kitchen, living area with direct access to a private garden, and comes with a long lease.

Linacre Road is a quiet one-way street close to Willesden Green and its great variety of cafés, shops and restaurants as well as transport links including Jubilee line stations and numerous bus routes.

Features

- Period Conversion
- Ground Floor
- Two Bedrooms
- Private Garden
- Long Lease
- Potential To Extend

Linacre Road, London, NW2

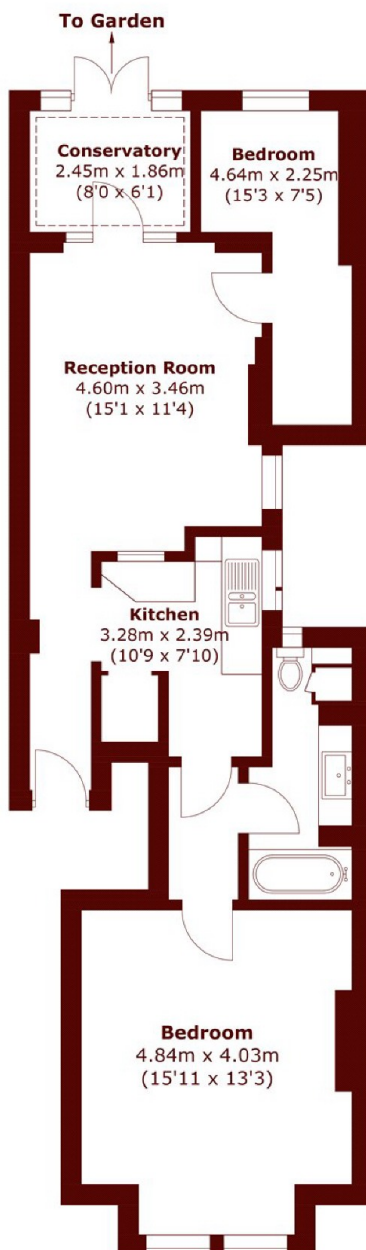

Total area (approx.): 66.7 sq. m (717.9 sq. ft)