

23 Albert Embankment London

£1,550 Per Week

A substantial, three bedroom, three bathroom apartment finished to an extremely high standard, ranging from fully integrated Miele appliances, feature lighting and luxurious bespoke design.

Residents further benefit from a 24 hour concierge service, spa, gym and indoor infinity pool as well as a Skyline Club on the 19th floor boasting impressive views of the London Skyline.

Change of contract fee: £50 including VAT

Council tax band: H - Lambeth Council

Lift Access

Holding Deposit - £1,550 (1 weeks rent, subject to agreed offer)

Electricity supply – Mains | Cold Water supply – Mains | Sewerage – Mains | Hot water, heating & comfort cooling – District communal | Internet: Fttp

23 Albert Embankment London



- 1,429 sq ft approx
- Three double bedrooms
- Three bathrooms (two en suite)
- 24 Hour concierge
- Zone 1 transport links
- Residents gym & swimming pool

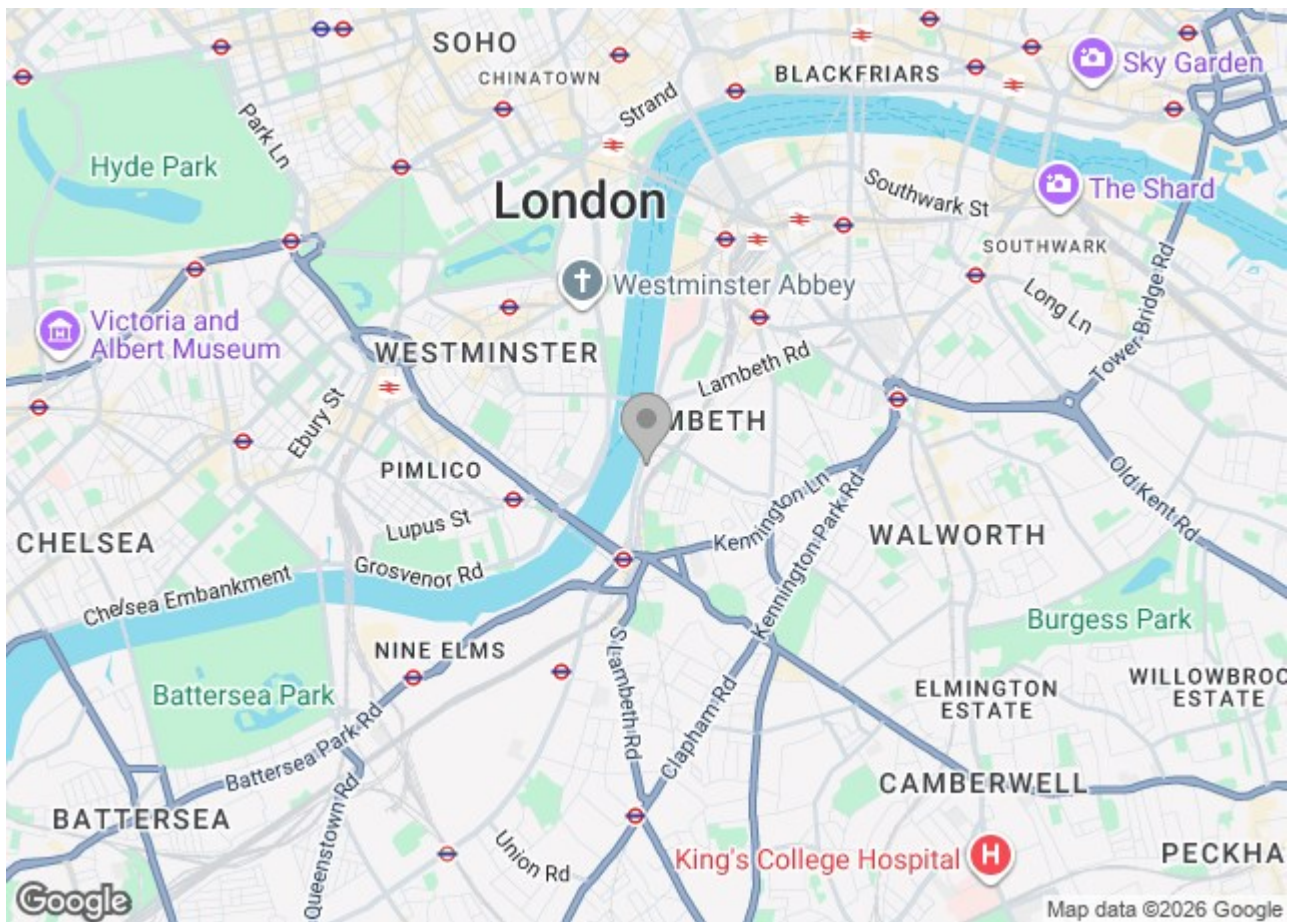





The Corniche,
 Albert Embankment,
 Lambeth, SE1
 Approximate Gross Internal Area
 132.73 sq m / 1,429 sq ft

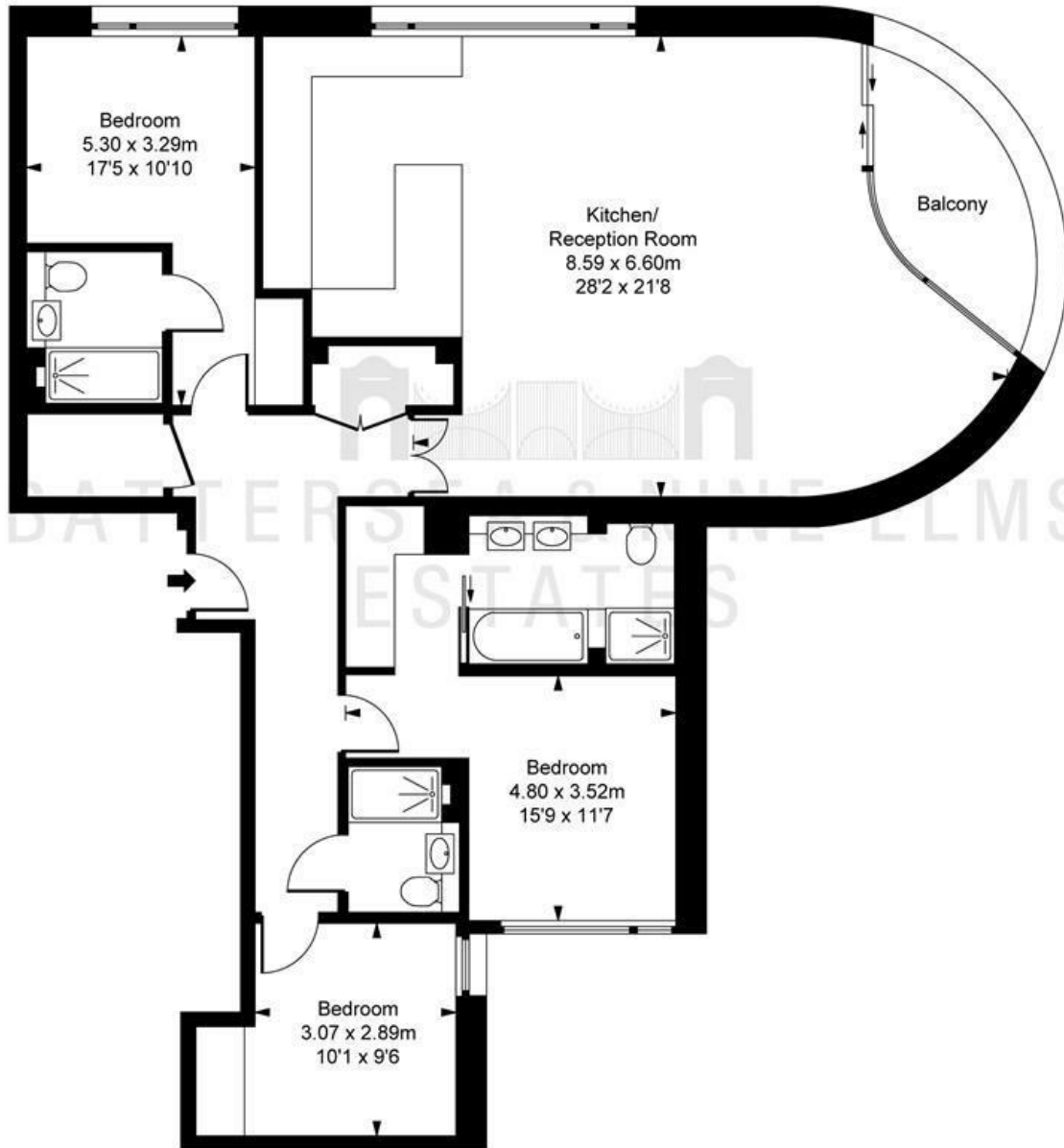

ILLUSTRATION FOR IDENTIFICATION PURPOSES ONLY
 ALL MEASUREMENTS AND AREA FIGURES SUPPLIED BY OTHERS, ACCURACY IS NOT GUARANTEED.
 THIS PLAN MUST NOT BE REPRODUCED BY ANY OTHER PERSON WITHOUT PERMISSION

These particulars, whilst believed to be accurate are set out as a general outline only for guidance and do not constitute any part of an offer or contract. Intending purchasers should not rely on them as statements of representation of fact, but must satisfy themselves by inspection or otherwise as to their accuracy. No person in this firm's employment has the authority to make or give any representation or warranty in respect of the property.

Energy Efficiency Rating		Current	Potential	Environmental Impact (CO ₂) Rating		Current	Potential
Very energy efficient - lower running costs (92 plus) A (81-91) B (69-80) C (55-68) D (39-54) E (21-38) F (1-20) G Not energy efficient - higher running costs		87	87	Very environmentally friendly - lower CO ₂ emissions (92 plus) A (81-91) B (69-80) C (55-68) D (39-54) E (21-38) F (1-20) G Not environmentally friendly - higher CO ₂ emissions		92	92
England & Wales		EU Directive 2002/91/EC		England & Wales		EU Directive 2002/91/EC	