



Kingsway, Leicester LE3 2PL

welcome to

Kingsway, Leicester

A spacious and modernised five-bedroom semi-detached home on Kingsway in Braunstone Town. The ground floor features an open-plan living room, dining room, and kitchen, plus a utility room, bathroom, and bedroom. Upstairs offers four bedrooms and two bathrooms. Ideal home for large families.

Entrance Porch

Provides access to main body of house

Entrance Hall

Provides access to Bedroom, Stairway and Living room

Living Room

Hardwood flooring, Media wall, Front bay window, Dimmer spotlights, open plan with dining area

Dining Room

Open plan with living room & kitchen, Dimmer spotlights, Hardwood flooring, Sliding door into rear garden

Kitchen

Privately fitted, Integrated appliances, Spotlights, Rear box window, Breakfast Bar, Fitted worktops and storage cupboards

Bedroom Five

Carpet flooring, Front window

Utility Room

Fitted worktop, Access to rear garden & bathroom

Downstairs Bathroom

Hardwood flooring, Walk-in shower, Toilet, Sink

Bedroom One

Carpet flooring, Rear window

Bedroom Two

Carpet flooring, Front bay window

Bedroom Three

Carpet flooring, Front window

Bedroom Four

Carpet flooring, Front window

Bathroom One

Tiled floors, Toilet, Sink, Bath

Bathroom Two

Tiling throughout, Walk-in shower, Sink, Toilet, Boiler cupboard

Garage

The garage is at the rear of the property and measures 11'05" x 8'08"





view this property online williamhbrown.co.uk/Property/LHS120662



welcome to Kingsway, Leicester

- Five Bedroom Semi Detached
- Extended property
- Spacious layout
- Great location
- Large garden

Tenure: Freehold EPC Rating: D
Council Tax Band: C

offers over
£360,000

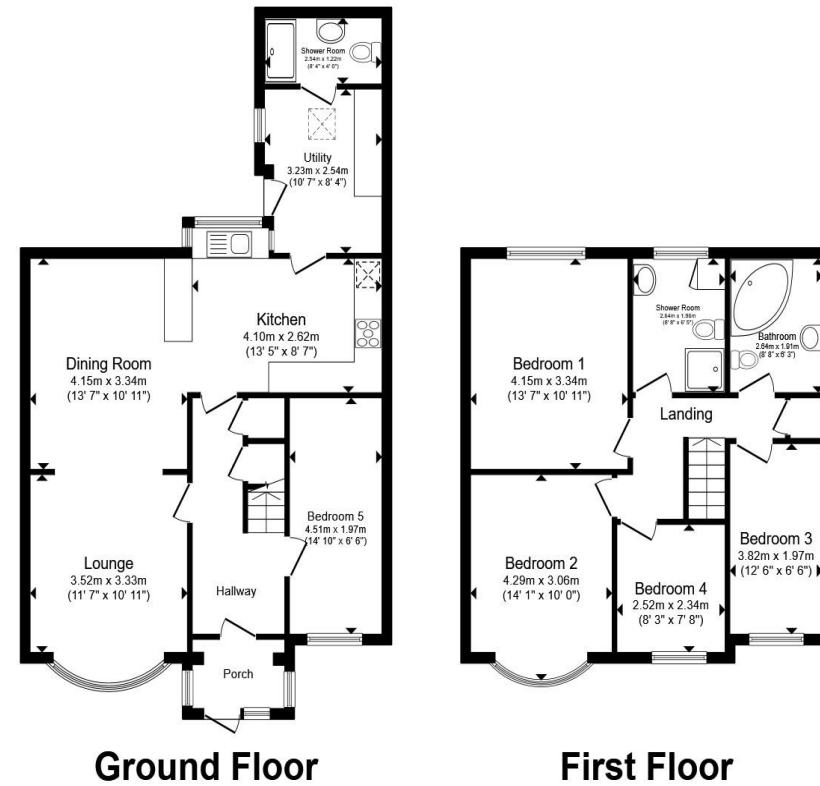

Total floor area 133.1 m² (1,433 sq.ft.) approx

This floor plan is for illustrative purposes only. It is not drawn to scale. Any measurements, floor areas (including any total floor area), openings and orientation are approximate. No details are guaranteed, they cannot be relied upon for any purpose and they do not form part of any agreement. No liability is taken for any error, omission or misstatement. A party must rely upon its own inspection(s). Powered by www.propertybox.io



view this property online williamhbrown.co.uk/Property/LHS120662



Property Ref:
LHS120662 - 0003

1. MONEY LAUNDERING REGULATIONS Intending purchasers will be asked to produce identification documentation at a later stage and we would ask for your co-operation in order that there is no delay in agreeing the sale. 2. These particulars do not constitute part or all of an offer or contract. 3. The measurements indicated are supplied for guidance only and as such must be considered incorrect. Potential buyers are advised to recheck measurements before committing to any expense. 4. We have not tested any apparatus, equipment, fixtures or services and it is in the buyers interest to check the working condition of any appliances. 5. Where an EPC, or a Home Report (Scotland only) is held for this property, it is available for inspection at the branch by appointment. If you require a printed version of a Home Report, you will need to pay a reasonable production charge reflecting printing and other costs. 6. We are not able to offer an opinion either written or verbal on the content of these reports and this must be obtained from your legal representative. 7. Whilst we take care in preparing these reports, a buyer should ensure that his/her legal representative confirms as soon as possible all matters relating to title including the extent and boundaries of the property and other important matters before exchange of contracts.

William H Brown is a trading name of Sequence (UK) Limited which is registered in England and Wales under company number 4268443, Registered Office is Cumbria House, 16-20 Hockliffe Street, Leighton Buzzard, Bedfordshire, LU7 1GN. VAT Registration Number is 500 2481 05.

william h brown



0116 251 4131



Leicester@williamhbrown.co.uk



16-18 Halford Street, LEICESTER, Leicestershire,
LE1 1JB



williamhbrown.co.uk