



Coopers Close
London, E1 4BB

£375,000

elms
ESTATES

Guide Price £375,000 - £400,000 Elms Estates are delighted to bring to the Market For Sale this Conveniently Located One Bedroom Apartment.

Coopers Close is Excellently Located with Multiple Transport Links within easy access, you have Whitechapel (District, Hammersmith & City and Elizabeth Line) Station, Bethnal Green (Central Line) Station and Bethnal Green Overground Station all within a short walk. In addition to these there are Multiple Bus Routes in to the City, West End and beyond. However if you are needing to get in to the City, then why not take a stroll through the vibrant East End, taking in Whitechapel's famous Street Market.

In addition to the convenient Transport Links Coopers Close affords, you have the plenty of supermarkets and local shops close by. Being situated within the Heart of the East End there is easy access to all of the Restaurants, Bars, Shops, Gyms, Parks, Galleries and Museums this Exciting Area has to offer.

Internally the property is bright a spacious throughout with a large reception room benefitting from a bay window, Separate kitchen, Double bedroom, ample storage and loft space. The property also boasts its own private parking space.

For more information or to arrange a viewing please do not hesitate to call in and speak with one of our Property Consultants.



Reception

14'1" x 11'9" (4.30 x 3.60)



Kitchen

8'10" x 7'2" (2.70 x 2.20)



Bedroom

12'4" x 8'8" (3.77 x 2.65)



Bathroom



Loft

Material Information

Tenure: Share of Freehold

Length Of Lease: Approx 959 Years remaining

Annual Ground Rent: £N/a

Annual Service Charge: £1,000 Per Year

Council Tax Band: B





Coopers Close, E1

Approx. Gross Internal Area 502 Sq Ft - 46.64 Sq M (Excluding Attic)
Approx. Gross Internal Area 922 Sq Ft - 85.66 Sq M (Including Attic)

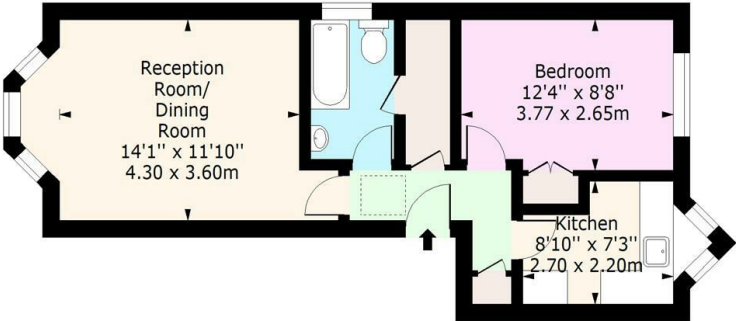

Second Floor
Floor Area 502 Sq Ft - 46.64 Sq M

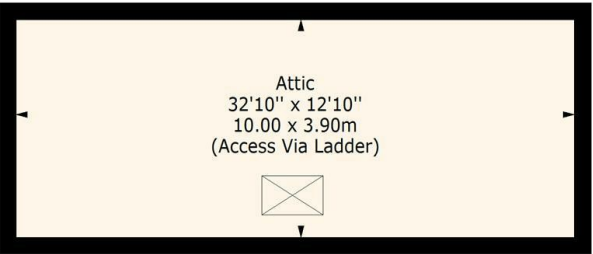

Attic
Floor Area 420 Sq Ft - 39.02 Sq M

For Illustration Purposes Only - Not To Scale
www.lpaplus.com

