



Ark Royal Close, Hartlepool, TS25 1DH

welcome to

Ark Royal Close, Hartlepool

This beautifully presented three-bedroom detached home offers spacious and versatile living in a highly desirable residential location.

Entrance Hall

Door to front, staircase to first floor.

Lounge

11' 8" x 14' 4" (max) (3.56m x 4.37m (max))

Fireplace, window to front, radiator, coved cornicing.

Kitchen/Diner

15' 1" (max) x 9' 10" (max) (4.60m (max) x 3.00m (max))

Two windows to rear, wall and base units with contrasting working surfaces and composite splashback tiling, inset sink and drainer unit with mixer tap, recess for cooker, recess and plumbing for washing machine, coved cornicing, radiator.

Landing

Bedroom 1

15' 1" (max) x 8' 6" (4.60m (max) x 2.59m)

Two windows to front, storage cupboard.

Bedroom 2

9' 6" x 6' 11" (max) (2.90m x 2.11m (max))

Window to rear, radiator.

Bedroom 3

7' 10" x 6' 7" (2.39m x 2.01m)

Window to rear, radiator.

Shower Room

Window to side, low level low flush WC, wall mounted wash hand basin with mixer tap, storage cupboard, chrome heated towel rail.





Externally

Front Garden

Lawn.

Rear Garden

Predominantly laid to lawn, patio area.

Driveway & Garage



view this property online mannersandharrison.co.uk/Property/HAR120265



welcome to

Ark Royal Close, Hartlepool

- IDEAL FOR A RANGE OF BUYERS
- KITCHEN/DINER
- THREE BEDROOMS
- FRONT&REAR GARDENS
- DRIVEWAY&GARAGE

Tenure: Freehold EPC Rating: D
Council Tax Band: C

£200,000

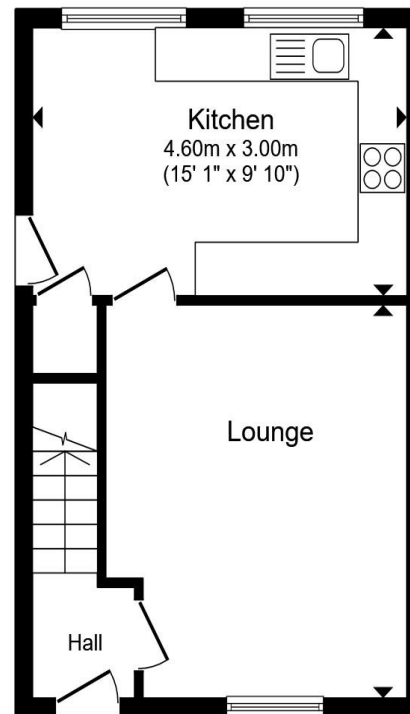

Ground Floor

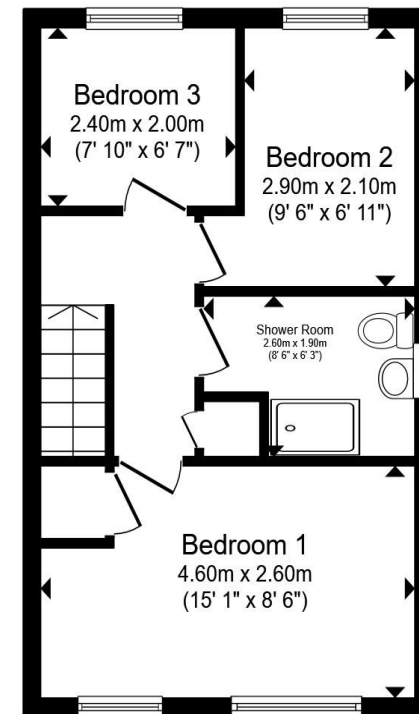

First Floor

Total floor area 69.0 m² (743 sq.ft.) approx

This floor plan is for illustrative purposes only. It is not drawn to scale. Any measurements, floor areas (including any total floor area), openings and orientation are approximate. No details are guaranteed, they cannot be relied upon for any purpose and they do not form part of any agreement. No liability is taken for any error, omission or misstatement. A party must rely upon its own inspection(s). Powered by www.propertybox.io

**manners
& harrison**

view this property online mannersandharrison.co.uk/Property/HAR120265



Property Ref:
HAR120265 - 0006

1. MONEY LAUNDERING REGULATIONS Intending purchasers will be asked to produce identification documentation at a later stage and we would ask for your co-operation in order that there is no delay in agreeing the sale. 2. These particulars do not constitute part or all of an offer or contract. 3. The measurements indicated are supplied for guidance only and as such must be considered incorrect. Potential buyers are advised to recheck measurements before committing to any expense. 4. We have not tested any apparatus, equipment, fixtures or services and it is in the buyers interest to check the working condition of any appliances. 5. Where an EPC, or a Home Report (Scotland only) is held for this property, it is available for inspection at the branch by appointment. If you require a printed version of a Home Report, you will need to pay a reasonable production charge reflecting printing and other costs. 6. We are not able to offer an opinion either written or verbal on the content of these reports and this must be obtained from your legal representative. 7. Whilst we take care in preparing these reports, a buyer should ensure that his/her legal representative confirms as soon as possible all matters relating to title including the extent and boundaries of the property and other important matters before exchange of contracts.

Manners & Harrison is a trading name of Sequence (UK) Limited which is registered in England and Wales under company number 4268443, Registered Office is Cumbria House, 16-20 Hockliffe Street, Leighton Buzzard, Bedfordshire, LU7 1GN. VAT Registration Number is 500 2481 05.

manners & harrison



01429 261351



Hartlepool@mannersandharrison.co.uk



Shrewsbury House 129 York Road,
HARTLEPOOL, Durham, TS26 9DW



mannersandharrison.co.uk