



Leigham Court Road | | London | SW16 2RG

£2,850 Per Month



Leigham Court Road |
 London | SW16 2RG
 £2,850 Per Month

Nestled on the desirable Leigham Court Road in Streatham Hill, this remarkable four-bedroom house presents an excellent opportunity for those seeking a spacious and modern family home. The property boasts a well-thought-out layout, featuring three generous double bedrooms alongside a comfortable single bedroom, making it ideal for families or those needing extra space.

The heart of the home is the bright and airy double reception room, which is enhanced by sliding double-glazed doors that seamlessly connect to a private rear garden. This outdoor space is perfect for both relaxation and entertaining, providing a tranquil retreat from the hustle and bustle of daily life. The contemporary kitchen is fully fitted with essential appliances, ensuring that culinary enthusiasts will feel right at home.

The property is equipped with a modern bathroom that includes a shower over the bath, complemented by a separate WC for added convenience. With double glazing throughout and

- 4 bedrooms
- Separate WC for convenience
- Sliding doors to private garden
- Double glazing throughout
- Sought-after Streatham Hill location
- Modern bathroom with shower
- Bright double reception room
- Contemporary fitted kitchen
- Furnished, available immediately

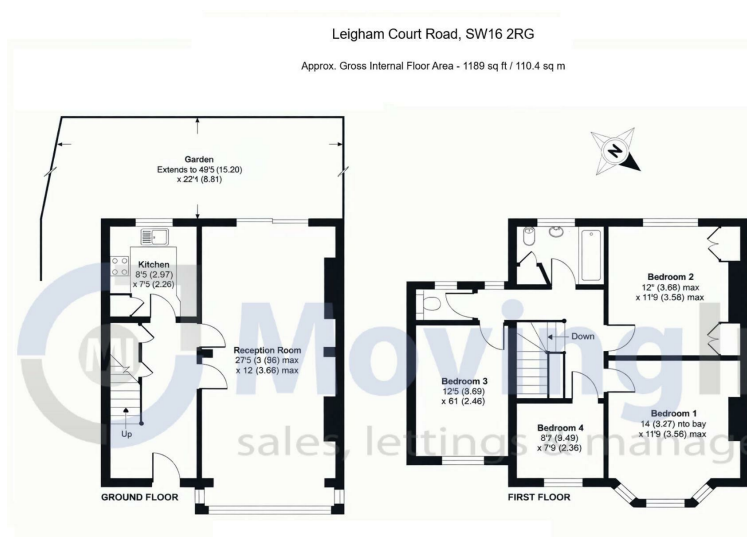

For Illustration Purposes Only - Not To Scale

This floor plan should be used as general outline for guidance only. All measurements are approximate and for illustration purposes only as defined by the RICS Code of Measuring Practice ©2016.

Energy Efficiency Rating		Current	Potential
Very energy efficient - lower running costs			
(92 plus)	A		
(81-91)	B		
(69-80)	C		
(55-68)	D		
(39-54)	E		
(21-38)	F		
(1-20)	G		
Not energy efficient - higher running costs			
England & Wales		EU Directive 2002/91/EC	

Council Tax Band E
 EPC Rating

467 Norwood Road
 West Norwood
 London
 SE27 9DJ
 02087610830
 dean@movinginn.co.uk
 www.movinginn.co.uk