

6 Orme View Drive, Prestatyn, LL19 9PF, Denbighshire

£435,000



A three bedroom detached dormer bungalow situated in Upper Prestatyn which enjoys sea views from the rear elevation. Having a spacious lounge/diner, kitchen, three good size bedrooms and a family bathroom. It stands in attractive gardens with maturing plants and shrubs, off road parking and two Garages. **DIRECTIONS** - From the Prestatyn office proceed up Plas Uchaf Avenue and at the t-junction turn right onto Stoneby Drive and first left onto Orme View Drive and the property will be found on the right hand side by way of a 'For Sale' sign.

Key Features

- OUTSTANDING VIEWS
- SPACIOUS LOUNGE WITH BALCONY
- FITTED KITCHEN
- GARDENS
- FREEHOLD
- THREE GOOD SIZE BEDROOMS
- DINING AREA
- DRIVEWAY
- TWO GARAGES
- COUNCIL TAX - 'F', EPC - 'E'

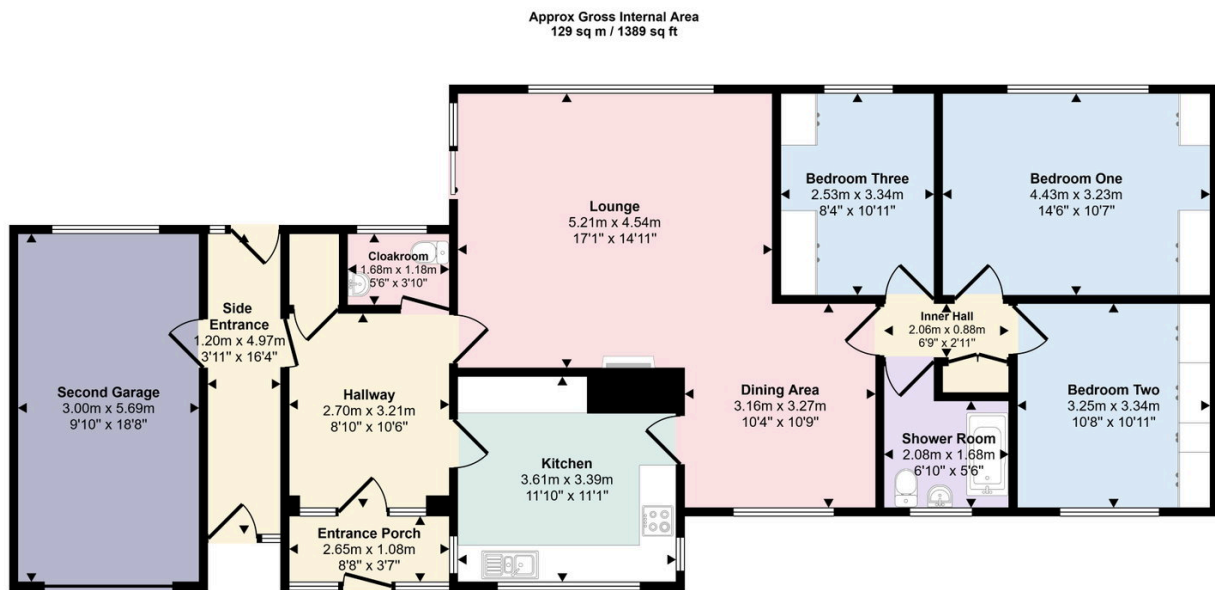

Floorplan

This floorplan is only for illustrative purposes and is not to scale. Measurements of rooms, doors, windows, and any items are approximate and no responsibility is taken for any error, omission or mis-statement. Icons of items such as bathroom suites are representations only and may not look like the real items. Made with Made Snappy 360.