



Weavers, High Street, Long Melford, Sudbury, CO10 9DF

welcome to

Weavers, High Street, Long Melford, Sudbury

This beautiful cottage sits at the top of a private drive just off the historic Long Melford Green. The property is brimming with character features throughout, offering flexible and spacious accommodation, and is further enhanced with off road parking and a private garden.



Living Room

16' x 15' 9" (4.88m x 4.80m)

Glazed entrance door. Windows to front and rear aspects. Two radiators. Large exposed brick inglenook fireplace with oak mantel. Stairs rising to first floor. Exposed timbers. Brick flooring.

Kitchen / Diner

15' 9" x 10' 9" (4.80m x 3.28m)

Windows to front and rear aspects. Fitted kitchen with a range of matching wall and base units over areas of work surface. Sink and drainer unit with mixer tap. Integral oven with hob and hood over. Cupboard housing central heating boiler. Door leading to:-

Home Office / Gf Bedroom

10' 8" x 6' 1" (3.25m x 1.85m)

Double glazed window to side aspect. Radiator. Door leading to:-

Shower Room

Window to side aspect. Suite comprising low level WC, vanity wash hand basin and shower cubicle. Extractor fan, heated towel rail.

Landing

Window to rear aspect. Exposed timbers. Storage areas.

Bedroom One

17' 3" x 9' 8" (5.26m x 2.95m)

Vaulted ceiling. Two windows to front aspect and window to side aspect with field views. Large storage cupboard, Exposed beams and brickwork. Two radiators.

Bedroom Two

10' 9" x 7' 6" (3.28m x 2.29m)

Vaulted ceiling. Windows to rear and side aspects with field views. Exposed timbers. Radiator.

Bathroom

Window to front aspect. Suite comprising low level WC, wash hand basin and bath with mixer tap and shower over. Heated towel rail.

Exterior

The property is approached via a private shingled driveway that provides off road parking. This then opens onto a block paved areas that leads to the main garden with a patio seating area. The remainder is predominantly laid to lawn.

Shed

9' 10" x 4' 6" (3.00m x 1.37m)

Could be adapted to use as a studio/workshop.

Brick Shed

8' 10" x 3' 9" (2.69m x 1.14m)

Agent's Note

As is usual with properties of this type, one neighbour has a right of way across the rear garden.



check out more properties at williamhbrown.co.uk



welcome to

Weavers, High Street, Long Melford, Sudbury

- Grade II listed 16th century cottage
- Beautiful character features
- Highly regarded village location
- Set in a quiet position
- Off road parking

Tenure: Freehold EPC Rating: Exempt
Council Tax Band: D

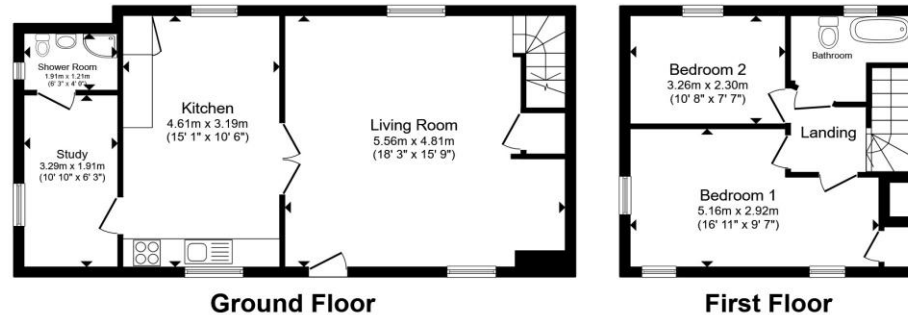

offers in excess of

£400,000

Total floor area 87.7 m² (944 sq.ft.) approx

This floor plan is for illustrative purposes only. It is not drawn to scale. Any measurements, floor areas (including any total floor area), openings and orientation are approximate. No details are guaranteed, they cannot be relied upon for any purpose and they do not form part of any agreement. No liability is taken for any error, omission or misstatement. A party must rely upon its own inspection(s). Powered by www.propertybox.io

william
h brown



check out more properties at williamhbrown.co.uk



Property Ref:
SUD110439 - 0003

1. MONEY LAUNDERING REGULATIONS Intending purchasers will be asked to produce identification documentation at a later stage and we would ask for your co-operation in order that there is no delay in agreeing the sale. 2. These particulars do not constitute part or all of an offer or contract. 3. The measurements indicated are supplied for guidance only and as such must be considered incorrect. Potential buyers are advised to recheck measurements before committing to any expense. 4. We have not tested any apparatus, equipment, fixtures or services and it is in the buyers interest to check the working condition of any appliances. 5. Where an EPC, or a Home Report (Scotland only) is held for this property, it is available for inspection at the branch by appointment. If you require a printed version of a Home Report, you will need to pay a reasonable production charge reflecting printing and other costs. 6. We are not able to offer an opinion either written or verbal on the content of these reports and this must be obtained from your legal representative. 7. Whilst we take care in preparing these reports, a buyer should ensure that his/her legal representative confirms as soon as possible all matters relating to title including the extent and boundaries of the property and other important matters before exchange of contracts.

William H Brown is a trading name of Sequence (UK) Limited which is registered in England and Wales under company number 4268443, Registered Office is Cumbria House, 16-20 Hockliffe Street, Leighton Buzzard, Bedfordshire, LU7 1GN. VAT Registration Number is 500 2481 05.



william h brown



01787 379372



Sudbury@williamhbrown.co.uk



23-24 Market Hill, SUDBURY, Suffolk, CO10 2EN



williamhbrown.co.uk