



## THACKERAY COURT, SW3

£600,000

Fabulous Chelsea Green location

First floor

Lift access and porter

Recently refurbished

Long lease

Bespoke Fitting



# ABOUT THE PROPERTY

A modern apartment located on the first floor of a popular and well-run residential block, benefitting greatly from a lift and porter. The flat has been beautifully decorated and newly refurbished throughout and features approximately 423 sq ft of lateral living space. The flat's living space includes a bright reception room, a separate and fitted kitchen area, and a spacious principal bedroom with en suite bathroom and bespoke fitted wardrobe space.

Thackeray Court is situated just off Kings Road and is within easy access to the wide range of boutique shops, supermarkets, cafes and restaurants of Chelsea Green and Kings Road. St Luke's Gardens is a short walk, as well as both Sloane Square and South Kensington Underground



# STEP INSIDE THACKERAY COURT

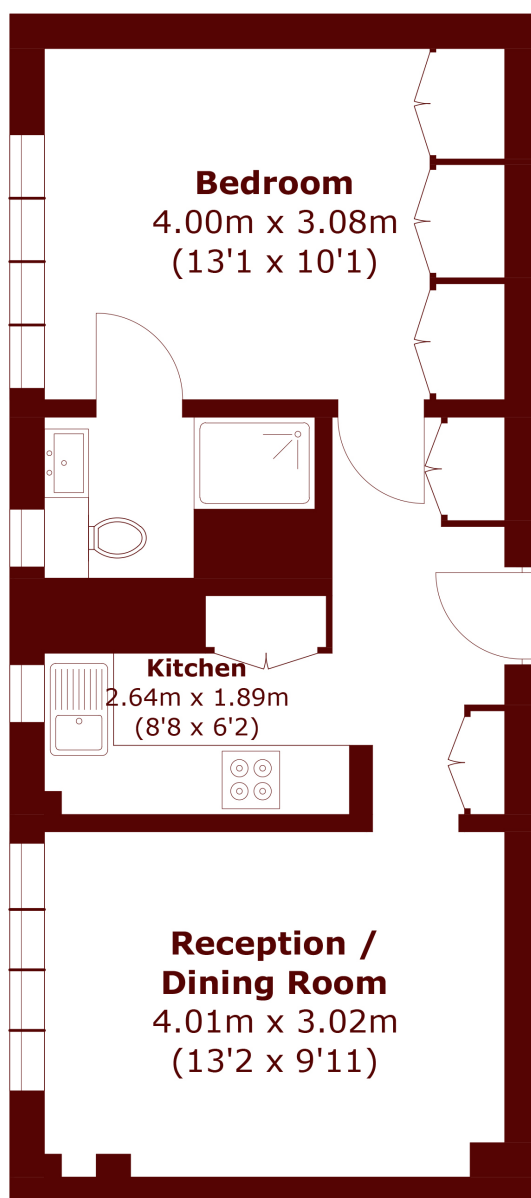

Total area (approx.): 39.3 sq. m (423.0 sq. ft)

Chelsea  
020 7590 0800

Energy Rating: C We aim to make our particulars both accurate and reliable. However, they are not guaranteed; nor do they form part of an offer or contract. If you require clarification on any points then please contact us, especially if you're traveling some distance to view. Please note that appliances and heating systems have not been tested and therefore no warranties can be given as to their good working order

MARSH &  
PARSONS