



223 Addycombe Terrace, Newcastle Upon Tyne, NE6 5TY

Offers Over £195,000

Hive Estates is delighted to present this stunning, fully renovated two-bedroom upper Tyneside flat, perfectly positioned in the highly sought-after area of Heaton. Beautifully blending timeless 1930s character with stylish contemporary finishes, this exceptional home enjoys attractive open views across playing fields while being just a short walk from Heaton's vibrant cafés, independent shops, local amenities and excellent transport links.

The welcoming entrance leads to a beautifully presented bedroom overlooking the playing fields, finished in soft neutral tones with plush beige carpeting to create a calm and relaxing retreat. The master double bedroom features wood-effect flooring, neutral décor and an attractive original picture rail.

At the heart of the home is the elegant dining room, an inviting space perfect for entertaining. Rich green walls complement the striking herringbone flooring, while original period features, exposed timber doors and views across the garden add warmth and character. Flowing effortlessly from the dining room is the beautifully appointed kitchen, complete with classic shaker-style cabinetry, contemporary hardware, marble-effect worktops and a crisp white tiled splashback. A glazed door provides access to the rear porch and the private garden.

The luxurious bathroom has been finished to an exceptional standard, featuring crisp white tiling, patterned floor tiles, a spacious walk-in shower, vanity wash basin, heated towel rail and WC.

Externally, the property benefits from a generous private enclosed rear garden, accessed via steps from the rear porch. Offering a large lawn alongside ample space for outdoor seating and dining, it provides the perfect setting for relaxing or entertaining throughout the warmer months.

Immaculately renovated throughout while retaining its beautiful period charm, this outstanding Tyneside flat offers a rare opportunity to acquire a turnkey home in one of Newcastle's most desirable neighbourhoods. Ideal for first-time buyers, professionals or those looking to enjoy the fantastic lifestyle that Heaton has to offer.

Lounge 14'5" x 11'3" (4.40 x 3.45)

Dining Room 13'1" x 12'1" (4.00 x 3.70)

Kitchen 12'5" x 7'6" (3.80 x 2.30)

Bedroom 1 10'7" x 8'3" (3.25 x 2.52)

Bedroom 2 10'5" x 8'3" (3.20 x 2.52)

Shower Room 5'6" x 5'1" (1.70 x 1.55)

Floor Plan

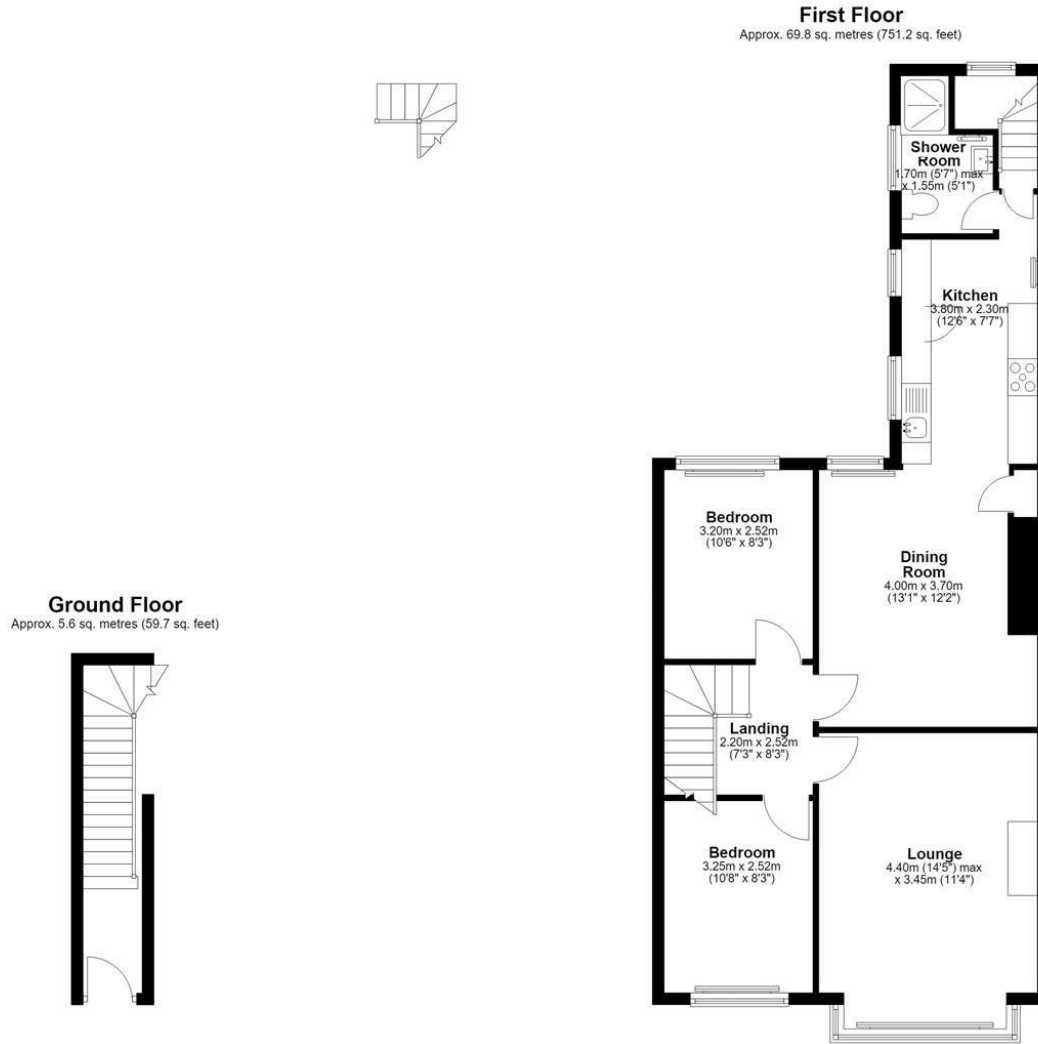

Total area: approx. 75.3 sq. metres (810.9 sq. feet)

Area Map

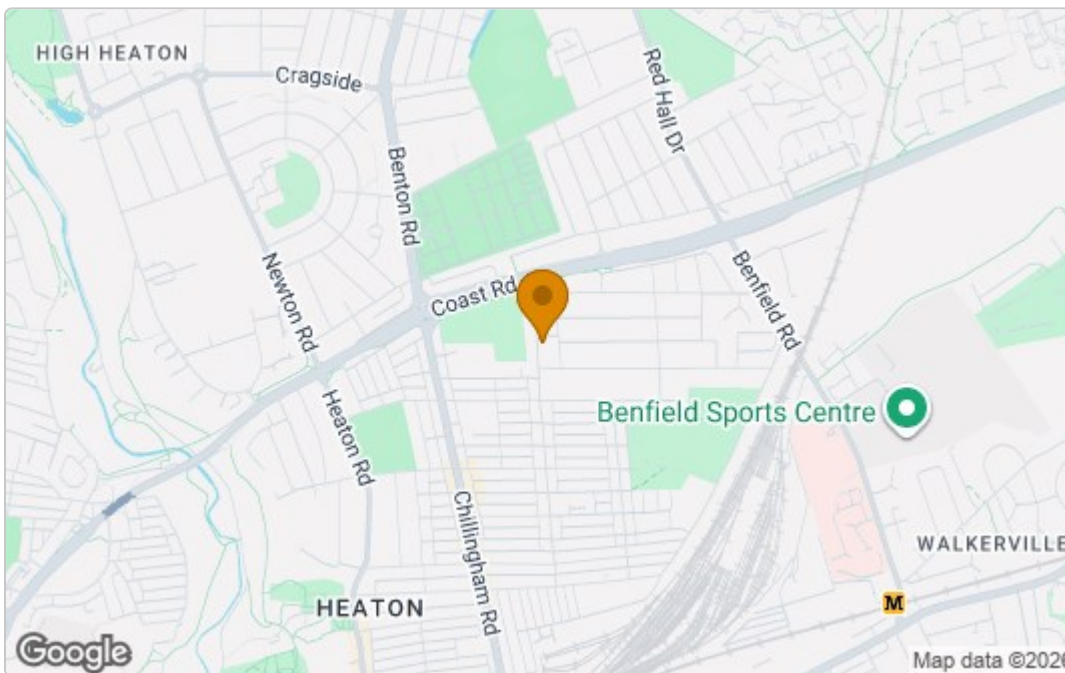

Energy Efficiency Graph

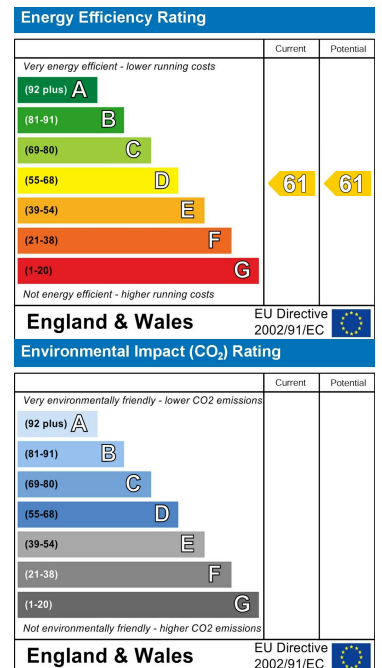

These particulars, whilst believed to be accurate are set out as a general outline only for guidance and do not constitute any part of an offer or contract. Intending purchasers should not rely on them as statements of representation of fact, but must satisfy themselves by inspection or otherwise as to their accuracy. No person in this firm's employment has the authority to make or give any representation or warranty in respect of the property.