



## Annandale

Darlington DL1 3QX

£925 Per Calendar Month





This footer paragraph is an example only and should not be relied upon as complying with current legislation. These particulars, whilst believed to be accurate are set out as a general outline only for guidance and do not constitute any part of an offer or contract. Intending purchasers should not rely on them as statements of representation of fact, but must satisfy themselves by inspection or otherwise as to their accuracy. No person in this firm's employment has the authority to make or give any representation or warranty in respect of the property.

# Annandale

Darlington DL1 3QX



- Two Bedrooms
- Whinfield
- Council Tax Band B

- Semi Detached
- Modern

- Bungalow
- Fully Furnished

A two bedroom semi detached bungalow situated in the Whinfield area of Darlington. The property is positioned in a quiet cul-de-sac and is fully furnished with high end furnishings including sofa, dining table and chairs, king size bed, sofa bed, wardrobe and three flat screen TV's, fridge/freezer, washing machine, dryer, oven and induction hob and integrated dishwasher. The property also benefits from air conditioning. The property is also close to local amenities and the A66. In brief: Entrance Hallway, Kitchen, Lounge/Diner, Two Bedrooms, Bathroom, Conservatory, south facing Rear Garden, and Garden to the front with off street parking. Early viewing is highly recommended.

Council Tax Band B.

## Entrance Hall

## Lounge/Diner

17'5" x 9'8" (5.31 x 2.97)

## Kitchen

7'8" x 7'6" (2.34 x 2.29)

## Inner Hallway

## Bedroom One

10'0" x 9'6" (3.05 x 2.90)

## Bedroom Two

10'0" x 8'5" (3.07 x 2.57)

## Conservatory

9'6" x 8'11" (2.90 x 2.74)

## Bathroom

## Externally

## Council Tax

Band B.

## Holding Deposit

All of our rental properties require a Holding Deposit equivalent to 1 week's rent. The Tenant is entitled for this Holding Deposit to be repaid within 15 calendar days of their application proceeding. However, in most cases we hope to repay this to the Tenant on the day you move in and this will be deducted from your first month's rent. This will need to be agreed with the Tenant during the application process.

You will lose your Holding Deposit if any of the following occurs:

1. You give us false or misleading information. For example, incorrect salary/income details or you fail to tell us about a CCJ.
2. You fail a Right to Rent check and are not eligible to reside in the UK.
3. You withdraw your application.
4. You fail to take steps to enter into the tenancy by

taking an unreasonable amount of time to complete and submit your application form, failing to provide necessary ID and accompanying documents within a reasonable amount of time or being unable to provide a definitive move in date.\*

\*Please be aware that all of the above is also relevant to any guarantor applications that may support your tenancy.

## Deposit (bond)

The deposit (bond) amount is equivalent to 5 weeks' rent.

## Venture Properties

We are Darlington's leading letting agent, letting more properties than any other agent in Darlington, and are proud to be an independent company. What does this mean for tenants? If the property is managed by Venture Properties, you will be assigned your own Property Manager who will look after you during the duration of your tenancy. The staff will be located in our Darlington office and not in a call centre out of town, which you will get with some other agents.

GROUND FLOOR

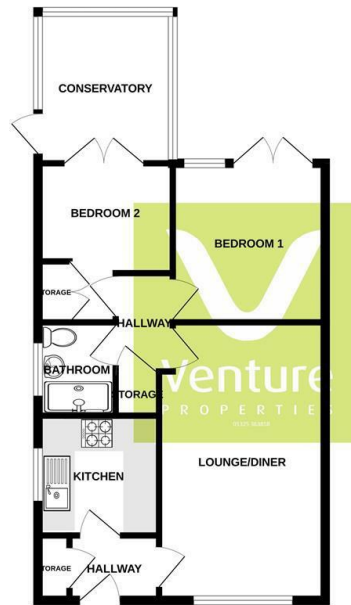

Whilst every attempt has been made to ensure the accuracy of the floorplan contained here, measurements of doors, windows, rooms and any other items are approximate and no responsibility is taken for any error, omission or misstatement. This plan is for illustrative purposes only and should be used as a guide for any prospective purchaser. The architect, planner and applicator shall use no dimensions and no guarantee as to their accuracy or efficiency can be given.  
Made with Merge3D/2D

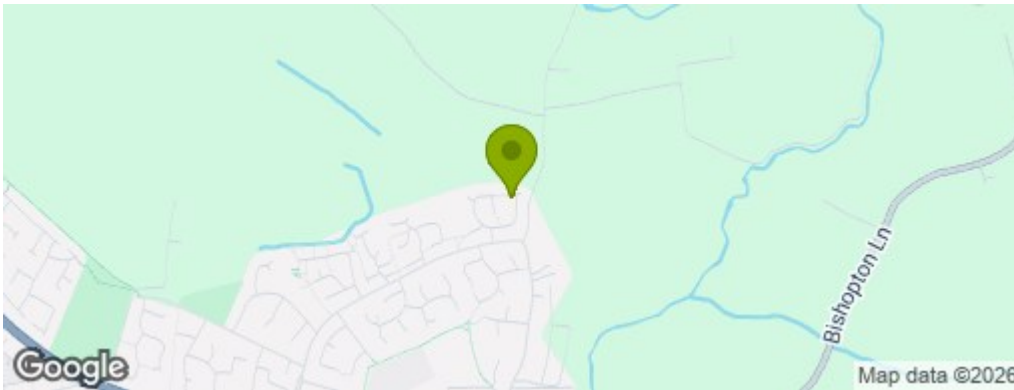

## Property Information

01325 363858

45 Duke Street, Darlington, County Durham, DL3 7SD  
[enquiries@venturepropertiesuk.com](mailto:enquiries@venturepropertiesuk.com)